

FSP coversheets submitted to the Town of Rolesville must include the items shown below, in addition to the necessary items to comply with G.S. 47-30

Vicinity Map North Arrow Bar Scale

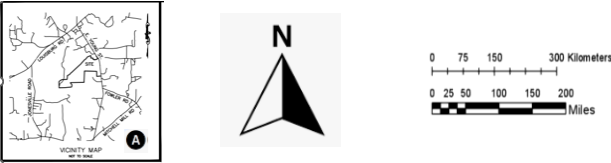

Surveyor Stamp and Seal

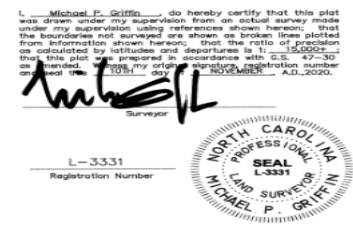

Overall Site Data

| DATA TYPE | NUMBER | UDO/LDO/SUP |
|---|----------|-------------|
| PIN | | |
| DEED BK & PG | | |
| TOTAL ACREAGE | | |
| TOTAL TRACT ACREAGE (INCLUDES R/W DEDICATION AND POSSIBLE OVERLAP AREA) | | |
| ZONING | | |
| TOTAL NUMBER OF SINGLE-FAMILY LOTS | | |
| APPROVED DURING REZONING PROVIDED | | |
| TOTAL NUMBER OF ATTACHED (TOWNHOME) | | |
| APPROVED DURING REZONING PROVIDED | | |
| WATERSHED | | |
| RIVER BASIN | | |
| TOWNSHIP | | |
| RECEIVING WATER | | |
| STREAM INDEX | | |
| CLASSIFICATION | | |
| EXISTING USAGE | | |
| PROPOSED USAGE | | |
| PHASE DENSITY | | |
| MAXIMUM DENSITY (PHASES) | | |
| PROPOSED DENSITY (PHASES) | | |
| SINGLE-FAMILY OR TOWNHOME MINIMUM BUILDING SETBACKS | | |
| FRONT SETBACK | | |
| REAR SETBACK | | |
| CORNER SETBACK | | |
| TOWNHOME MINIMUM BUILDING SEPARATIONS: | | |
| SIDE SEPARATION | | |
| REAR SEPARATION | | |
| PHASE EXISTING IMPERVIOUS | | |
| PHASE PROPOSED IMPERVIOUS | | |
| PHASE MAXIMUM IMPERVIOUS PER LOT | | |
| PHASE TOTAL AREA OF LOTS | | |
| PHASE AVERAGE LOT | | |
| MINIMUM TOWNHOME LOT SIZE | | |
| MAXIMUM BUILDING HEIGHT | | |
| PHASE LIMIT OF DISTURBANCE | | |
| PHASE AREA IN PUBLIC R/W | | |
| PHASE TOTAL R/W LINEAR FEET | | |
| PHASE TOTAL PRIVATE LINEAR FEET | | |
| PARKING COUNT | | |
| REQUIRED | PROVIDED | |

THE REZONING FOR THIS DEVELOPMENT WAS APPROVED ON __/__/__(- - -) AND FALLS UNDER THE _____ UDO/LDO

Project Team

| PROJECT TEAM | |
|----------------|--|
| PROPERTY OWNER | |
| DEVELOPER | |
| ENGINEER | |
| SURVEYOR | |
| BUFFER/WETLAND | |

Landowner(s)

| LANDOWNER(S) | PIN | BM & PG |
|--------------|-----|---------|
| | | |

Adjoining Properties

| ADJOINING PROPERTIES | |
|---|--|
| OWNER NAMES | |
| PROPERTY ADDRESS | |
| LEGAL DESCRIPTION | |
| LOT/BLOCK, SUBDIVISION NAME, BM & PG REFERENCE | |
| ZONING DISTRICT (+planning jurisdiction if not TOR) | |

Property Owner Signature Block

I hereby certify that I am the owner of the property shown and described herein, which is located in the subdivision jurisdiction of the Town of Rolesville and that I hereby adopt this plan of subdivision with my free consent, establish minimum building setback lines, and dedicate all streets, alleys, walks, parks, and other sites and easements to public or private use as noted. Furthermore, I hereby dedicate all sanitary sewer, storm sewer and water lines to the Town of Rolesville.

Owner: Ben C. Lunn
Date: 11-22-21

"North Carolina, Wake County.
I, Michael L. Jones, a Notary Public of the County and State aforesaid, certify that Ben C. Lunn, personally appeared before me this day and acknowledged the execution of the foregoing instrument. Witness my hand and official stamp or seal, this 22 day of November, 2021.

Notary Public
My commission expires 7-20-24 "

MICHAEL L. JONES
Notary Public
Wake County
North Carolina

Town of Rolesville Approval Stamp

CERTIFICATE OF APPROVAL FOR RECORDING

I HEREBY CERTIFY THAT THE SUBDIVISION PLAT SHOWN HEREON HAS BEEN FOUND TO COMPLY WITH THE SUBDIVISION REGULATIONS OF THE TOWN OF ROLESVILLE, NORTH CAROLINA AND THAT THIS PLAT HAS BEEN APPROVED BY THE SUBDIVISION ADMINISTRATOR OF THE TOWN OF ROLESVILLE FOR RECORDING IN THE OFFICE OF THE REGISTER OF DEEDS OF WAKE COUNTY.

SUBDIVISION ADMINISTRATOR, TOWN OF ROLESVILLE

DATE
ROLESVILLE, NORTH CAROLINA

I, _____, REVIEW OFFICER OF THE TOWN OF ROLESVILLE, CERTIFY THAT THE MAP OR PLAT TO WHICH THIS CERTIFICATION IS AFFIXED MEETS ALL STATUTORY REQUIREMENTS FOR RECORDING.

DATE REVIEW OFFICER

Required Approvals

| REQUIRED APPROVALS | |
|--|---------------|
| PERMIT | PERMIT NUMBER |
| TOWN OF ROLESVILLE SPECIAL USE PERMIT | SUP-__-__ |
| TOWN OF ROLESVILLE PRELIMINARY PLAT | PSP-__-__ |
| TOWN OF ROLESVILLE CONSTRUCTION INFRASTRUCTURE DRAWING | CID-__-__ |

FINAL PLAT FSP- __-__

SUBDIVISION

PHASE(s) _____

TOWN OF ROLESVILLE

Hatch Phase(s) being platted



THESE IMPROVEMENTS SHALL BE IN ACCORDANCE WITH THE FOLLOWING DRAWINGS AND THE STANDARD SPECIFICATIONS OF THE CITY OF RALEIGH, WAKE COUNTRY, TOWN OF ROLESVILLE, AND NCDOT.

Lot Width and Setback Table

| MIN. LOT WIDTH | | | |
|----------------|--|--|--|
| FRONT | | | |
| REAR | | | |
| SIDE | | | |
| CORNER | | | |
| MIN. LOT SIZE | | | |

Max Imp. Surf. Approved Per Lot Table

| Lot # | Street # | Street Name | sq. ft |
|-------|----------|-------------|--------|
| Lot # | Street # | Street Name | sq. ft |
| Lot # | Street # | Street Name | sq. ft |

Street Information

| Street Name | Public or Private | Street Width | Street Length in Linear Feet |
|-------------|-------------------|--------------|------------------------------|
| | | | |
| | | | |

Conditions of Approval REZ-__-__

| |
|--|
| |
| |
| |
| |
| |

Revision Date(s) (if applicable)

- V.1 xx-xx-xx
- V.2 xx-xx-xx

ROD Book of Maps and Page Numbers

BM _____ PG _____

| SHEET INDEX | |
|--------------|-------------------------------|
| Sheet Number | Sheet Title |
| G-001 | Cover Sheet |
| G-002 | Conditions of Approval |
| G-003 | Lot Areas And Open Space Plan |
| CV100 | Existing Conditions |
| CX100 | Demolition Plan |
| CS100 | Overall Site Plan |
| CS400 | Site Plan Area A |
| CS401 | Site Plan Area B |
| CS402 | Site Plan Area C |
| CS500 | Site Details |
| CU100 | Utility Plan Overall |
| CU400 | Utility Plan Area A |
| CU401 | Utility Plan Area B |
| CU402 | Utility Plan Area C |
| CE100 | ESC Phase 1 Overall |
| CE400 | ESC Phase 1 Area A |
| CE401 | ESC Phase 1 Area B |
| CE402 | ESC Phase 1 Area C |
| CE110 | ESC Phase 2 Overall |
| CE410 | ESC Phase 2 Area A |
| CE411 | ESC Phase 2 Area B |
| CE412 | ESC Phase 2 Area C |
| CE413 | ESC Phase 2 Offsite Area |
| CG100 | Grading & Drainage Overall |
| CG400 | Grading & Drainage Area A |
| CG401 | Grading & Drainage Area B |
| CG402 | Grading & Drainage Area C |

Civil Survey Company
Engineers • Surveyors • Planners
Phone: _____
NCBELS FIRM

FINAL PLAT SUBDIVISION
PHASE ONE - LOTS 1-34 & 36-41
Wake Forest Township, Rolesville
Wake County, North Carolina

Designed By: N/A
Drawn By: _____
Checked By: _____
Scale: N/A
Date: 11/02/2021
Project Number: _____

SHEET
1 OF 15

*The impervious surface table and street information table may appear on page #2 due to spacing.