

- DEMOLITION NOTES:**
- ALL DEMOLITION DEBRIS IS TO BE REMOVED FROM THE PROJECT SITE AND DISPOSED OF IN ACCORDANCE WITH APPLICABLE COUNTY, STATE, AND FEDERAL REGULATIONS.
  - CONTRACTOR IS RESPONSIBLE FOR LOCATING ALL EXISTING UTILITIES BEFORE ANY WORK IS STARTED. ENGINEER SHALL BE NOTIFIED OF ANY DISCREPANCIES BETWEEN THE FIELD MARKINGS AND SURVEY.
  - NO LAND DISTURBING ACTIVITY PRIOR TO APPROVAL OF EROSION AND SEDIMENT CONTROL PLAN AND THE ISSUANCE OF THE LAND-DISTURBING PERMIT AT THE PRECONSTRUCTION MEETING.
  - CONTRACTOR TO REMOVE ALL TREES WITHIN LIMITS OF DISTURBANCE.

**EXISTING UTILITY NOTE:**

THE LOCATION OF EXISTING UNDERGROUND UTILITIES ARE SHOWN IN AN APPROXIMATE WAY ONLY AND HAVE NOT BEEN INDEPENDENTLY VERIFIED BY THE OWNER OR ITS REPRESENTATIVE. THE CONTRACTOR SHALL DETERMINE THE EXACT LOCATION OF ALL EXISTING UTILITIES BEFORE COMMENCING ANY WORK, AND AGREES TO BE FULLY RESPONSIBLE FOR ANY AND ALL DAMAGES WHICH MIGHT OCCUR DUE TO THE CONTRACTOR'S FAILURE TO EXACTLY LOCATE AND PRESERVE ANY AND ALL UNDERGROUND UTILITIES.

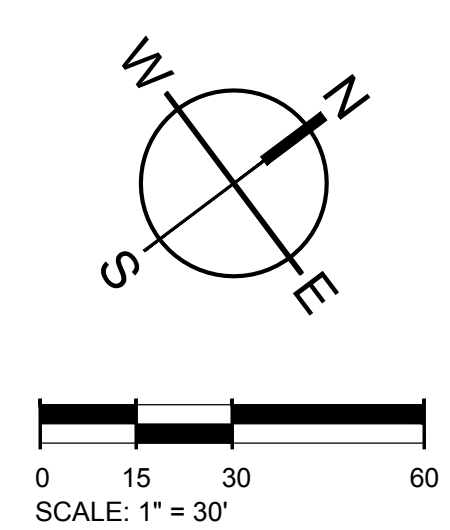

DEMOLITION LEGEND		
DEMO EXISTING GRAVEL		LIMITS OF DISTURBANCE
DEMO EXISTING TREES		EXISTING UTILITY TO REMAIN
SILT FENCE OUTLET		EXISTING CURB TO BE REMOVED



501 WINDY PARK BOULEVARD, SUITE 200 | MOUNT PLEASANT, SC 29546 | JUDSON MILLS BUILDING 6000, 701 EASLEY BROOK RD, SUITE 6000, GREENVILLE, SC 29611 | 230 PETERSON DR., CHARLOTTE, NC 28217 | 713 N. CEDAR STREET | SUMMERVILLE, SC 29586 | 104 N. DANIEL MORGAN AVENUE, SUITE 300 | SPARTANBURG, SC 29301  
 COPYRIGHT © SEAMON WHITESIDE & ASSOCIATES, INC. THIS DRAWING SHALL NOT BE REPRODUCED IN ANY MANNER OR FOR ANY PURPOSE WITHOUT WRITTEN PERMISSION.

Raleigh's access (tractor trailer) to the water tower must be maintained 24 hours per day, 7 days a week, 365 days out of the year while this site is under construction.



**BACKFLOW PREVENTION NOTES**

1. REDUCED PRESSURE PRINCIPLE BACKFLOW PREVENTION ASSEMBLY AS APPROVED BY TOWN OF ROLESVILLE AND INSTALLED BY CONTRACTOR DURING CONSTRUCTION. ASSEMBLY TO BE INSTALLED ABOVE GROUND WITHIN INSULATED ENCLOSURE PER TOWN OF ROLESVILLE REQUIREMENTS. ENCLOSURE TO BE LOCATED OUT OF SETBACK.
2. THERE SHALL BE NO TAPS, PIPING BRANCHES, UNAPPROVED BYPASS PIPING, HYDRANTS, FIRE DEPT. CONNECTION POINTS OR OTHER WATER USING APPURTENANCES CONNECTED TO THE SUPPLY LINE BETWEEN ANY WATER METER AND ITS REQUIRED BACKFLOW PREVENTER.
3. EACH REQUIRED BACKFLOW PREVENTION ASSEMBLY IS REQUIRED TO BE TESTED BY AN APPROVED CERTIFIED TESTER PRIOR TO PLACING THE WATER SYSTEM IN SERVICE AND YEARLY THEREAFTER. SUBMIT PASSING TEST REPORTS TO TOWN OF ROLESVILLE.
4. DUCTILE IRON, COPPER, OR OTHER METALLIC PIPING (NO PVC) IS TO BE USED WITHIN 5 FEET OF ALL BACKFLOW PREVENTION DEVICES.
5. TAMPER SWITCHES SHALL BE INSTALLED ON THE FIRE LINE BACKFLOW PREVENTION. INSTALL 3/4" CONDUIT FROM FIRE LINE BACKFLOW ENCLOSURE/Vault TO BUILDING ALARM SYSTEM INSIDE BUILDING. COORDINATE WITH ELECTRICAL DRAWINGS AND ALARM SYSTEM MANUFACTURER.

**WATER SERVICE NOTES**

1. 2" WATER METER FOR DOMESTIC SERVICE FURNISHED AND INSTALLED BY (CONTRACTOR/UTILITY) IN BELOW GRADE CONCRETE VAULT PREPARED BY CONTRACTOR IN ACCORDANCE WITH UTILITY DEPARTMENT STANDARDS. SEE DETAILS.
2. 3/4" WATER METER FOR IRRIGATION SERVICE FURNISHED AND INSTALLED BY (CONTRACTOR/UTILITY) IN BELOW GRADE CONCRETE VAULT PREPARED BY CONTRACTOR IN ACCORDANCE WITH UTILITY DEPARTMENT STANDARDS. SEE DETAILS.

**STANDARD SEWER PLAN NOTES**

1. FOR PROJECT SURVEY INFORMATION INCLUDING VERTICAL DATUM AND BENCHMARK LOCATIONS, SEE "PROJECT SURVEY INFORMATION AND CONTRACTOR VERIFICATION REQUIREMENTS" ON SHEET C1.0.
2. PRIOR TO STARTING CONSTRUCTION, THE CONTRACTOR IS RESPONSIBLE FOR VERIFYING EXISTING CONDITIONS, INCLUDING BUT NOT LIMITED TO TOPOGRAPHIC, TREE, STORM DRAINAGE FACILITIES, AND ALL UTILITIES. EXISTING UTILITIES SHOWN ARE APPROXIMATE AND HAVE NOT BEEN INDEPENDENTLY VERIFIED BY THE OWNER OR ENGINEER. THEREFORE, THE CONTRACTOR IS RESPONSIBLE FOR VERIFYING THE EXACT VERTICAL AND HORIZONTAL LOCATIONS OF ALL EXISTING UTILITIES. ANY DISCREPANCIES OR CONFLICTS IDENTIFIED DURING VERIFICATION OF EXISTING CONDITIONS AND UTILITIES SHALL BE REPORTED TO THE OWNER AND ENGINEER. ANY COSTS ASSOCIATED WITH CORRECTIVE WORK OR DAMAGES THAT ARE A RESULT OF THE CONTRACTOR NOT VERIFYING EXISTING CONDITIONS AND THE EXACT VERTICAL AND HORIZONTAL LOCATION OF ALL EXISTING UTILITIES WILL BE THE CONTRACTOR'S RESPONSIBILITY.
3. MANHOLE COVERS ARE NOT ALLOWED WITHIN CURB AND GUTTER AND ARE TO BE INSTALLED COMPLETELY WITHIN OR COMPLETELY OUT OF PAVED AREAS (INCLUDING SIDEWALKS).
4. SEWER MANHOLE CONES ADJACENT TO CURB AND/OR SIDEWALK RAMP SHALL BE ROTATED TO LOCATE MANHOLE FRAME AND COVER AWAY FROM THE SIDEWALK RAMP AND CURBS.
5. REFER TO THE SEWER AUTHORITY'S STANDARD NOTES, DETAILS, AND SPECIFICATIONS FOR ADDITIONAL REQUIREMENTS AND PROCEDURES, INCLUDING WATERTIGHT MANHOLE LOCATIONS.
6. REFER TO SEWER DETAIL SHEETS AND SEWER PROFILE SHEETS FOR DETAILS AND ANY ADDITIONAL SEWER SYSTEM INFORMATION.

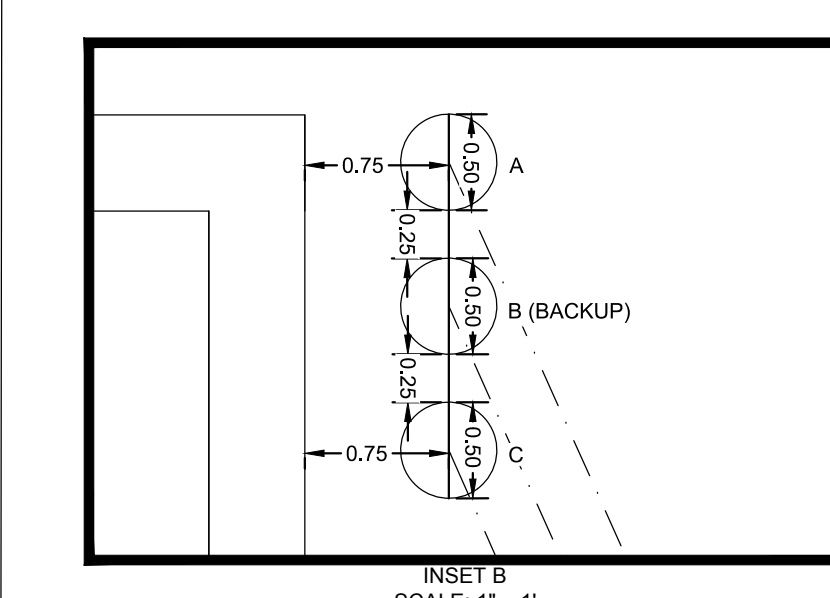
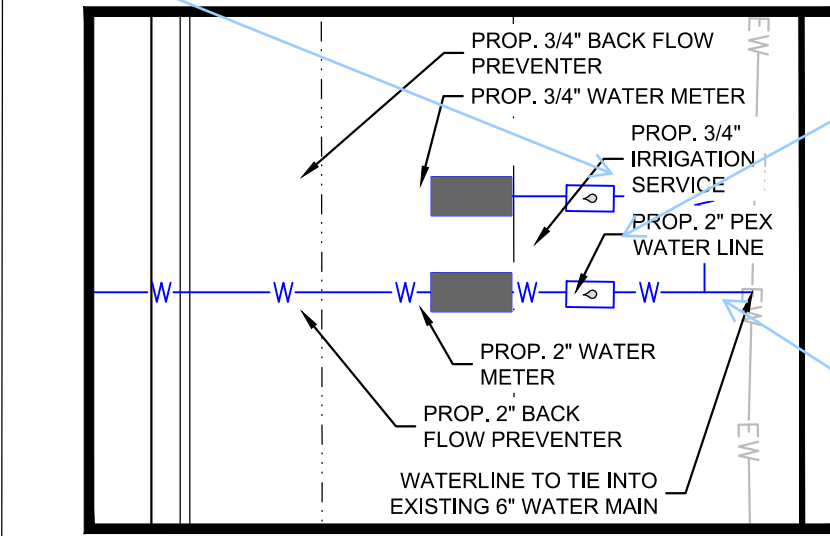

FYI, it's a 3/4" stub but will be a 5/8" water meter. We do not offer a 3/4" water meter.

Also, CORWLE should be shown surrounding the proposed water meters.

The proposed water stubs will need to be copper until it reaches the meter box. Behind the water meter, the material can change.

Since the waterline was installed outside of the R/W, City of Raleigh Water Line Easement must be dedicated from the R/W and 10' from the center of the pipe.

**EXISTING UTILITY NOTE:**  
THE LOCATION OF EXISTING UNDERGROUND UTILITIES ARE SHOWN IN AN APPROXIMATE WAY ONLY AND HAVE NOT BEEN INDEPENDENTLY VERIFIED BY THE OWNER OR ITS REPRESENTATIVE. THE CONTRACTOR SHALL DETERMINE THE EXACT LOCATION OF ALL EXISTING UTILITIES BEFORE COMMENCING ANY WORK, AND AGREES TO BE FULLY RESPONSIBLE FOR ANY AND ALL DAMAGES WHICH MIGHT OCCUR DUE TO THE CONTRACTOR'S FAILURE TO EXACTLY LOCATE AND PRESERVE ANY AND ALL UNDERGROUND UTILITIES.

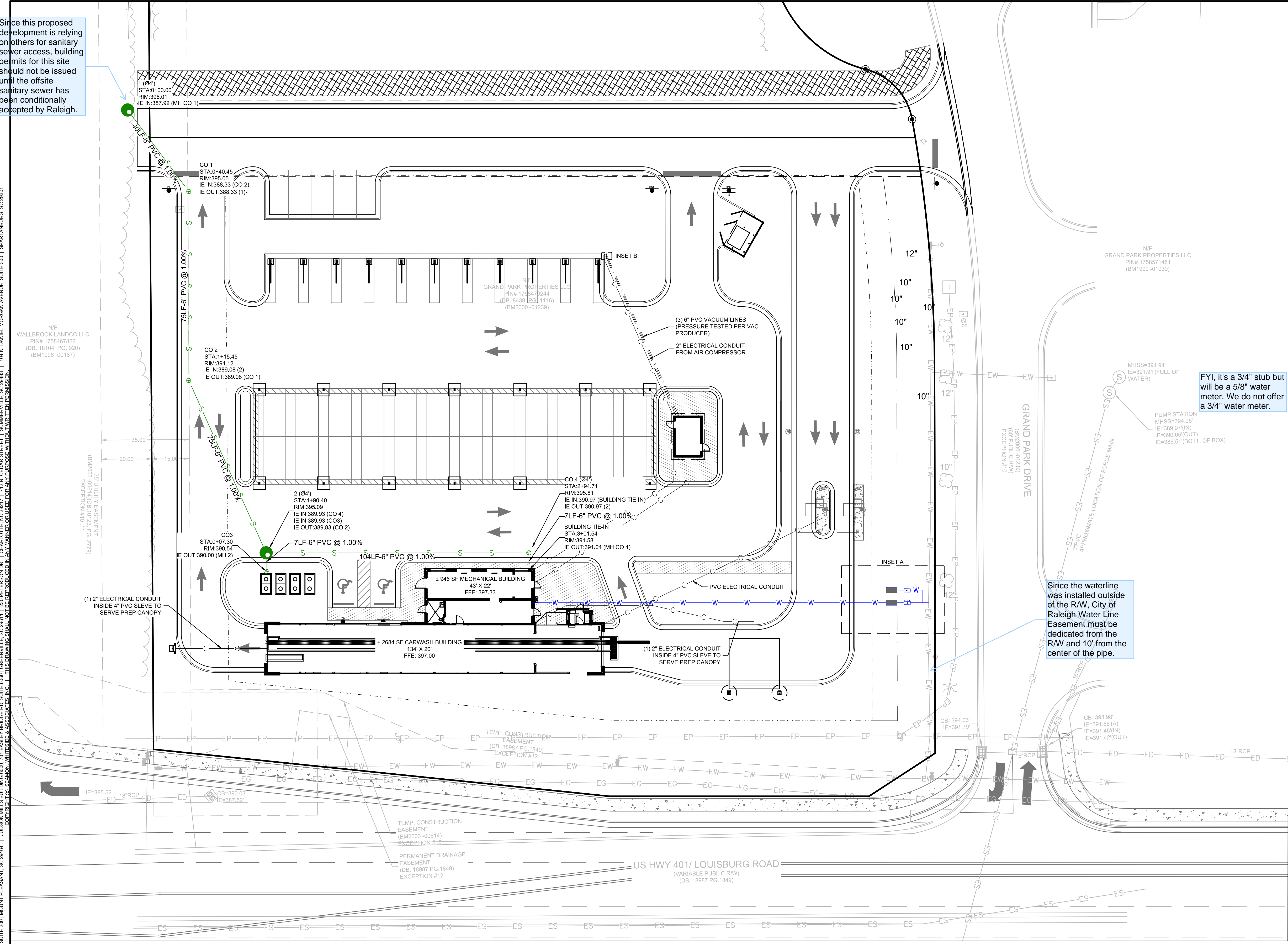
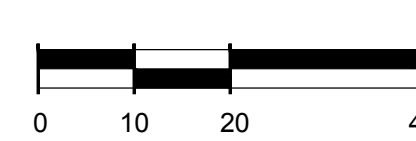
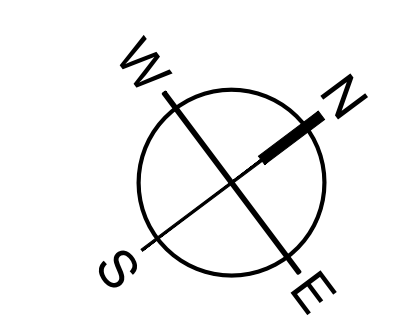

Since this proposed development is relying on others for sanitary sewer access, building permits for this site should not be issued until the offsite sanitary sewer has been conditionally accepted by Raleigh.

501 WANDO PARK BOULEVARD, SUITE 200 | MOUNT PLEASANT, SC 29546 | JUDSON MILLS BUILDING 6000, 701 EASLEY BROOK RD, SUITE 600 | GREENVILLE, SC 29611 | 230 PETERSON DR., SUITE 200 | CHARLOTTE, NC 28217 | 710 N. CECIL STREET | SUMMERVILLE, SC 29586 | 104 N. DANIEL MORGAN AVENUE, SUITE 300 | SPARTANBURG, SC 29301