

There are two trees shown within this buffer that on PR21-04 REV that are not shown or protected here.

Label the location of existing vegetation and the critical root zones.

- ### Demolition Notes:
- CONTRACTOR SHALL CONTACT NORTH CAROLINA ONE-CALL CENTER (NC 811) BY DIALING 811 OR 1-800-632-4949 AT LEAST 72 HOURS IN ADVANCE OF ANY LAND DISTURBING ACTIVITY OR DIGGING AND HAVE ALL UNDERGROUND UTILITIES LOCATED PRIOR TO EXCAVATING OR TRENCHING.
  - THE CONTRACTOR IS RESPONSIBLE FOR OBTAINING ALL LOCAL AND STATE PERMITS REQUIRED FOR DEMOLITION WORK.
  - THE CONTRACTOR SHALL INDEMNIFY AND HOLD HARMLESS THE OWNER AND/OR ENGINEER FOR ANY AND ALL INJURIES AND/OR DAMAGES TO PERSONNEL, EQUIPMENT AND/OR EXISTING FACILITIES IN THE DEMOLITION AND CONSTRUCTION DESCRIBED IN THE PLANS AND SPECIFICATIONS.
  - EXISTING CONDITIONS AS DEPICTED ON THESE PLANS ARE GENERAL AND ILLUSTRATIVE IN NATURE AND DO NOT INCLUDE MECHANICAL, ELECTRICAL AND MISCELLANEOUS STRUCTURES. IT IS THE RESPONSIBILITY OF THE CONTRACTOR TO EXAMINE THE SITE AND BE FAMILIAR WITH EXISTING CONDITIONS PRIOR TO BIDDING ON THE DEMOLITION WORK FOR THIS PROJECT. IF CONDITIONS ENCOUNTERED DURING EXAMINATION ARE SIGNIFICANTLY DIFFERENT THAN THOSE SHOWN, THE CONTRACTOR SHALL NOTIFY THE ENGINEER IMMEDIATELY.
  - ALL DEMOLITION WASTE AND DEBRIS SHALL BE REMOVED BY THE CONTRACTOR AND DISPOSED OF IN A STATE APPROVED WASTE SITE AND IN ACCORDANCE WITH ALL LOCAL AND STATE CODES AND PERMIT REQUIREMENTS.
  - THE BURNING OF CLEARED MATERIAL AND DEBRIS SHALL NOT BE ALLOWED UNLESS CONTRACTOR GETS WRITTEN AUTHORIZATION FROM THE LOCAL AUTHORITIES.
  - ASBESTOS OR HAZARDOUS MATERIALS, IF FOUND ON SITE, SHALL BE REMOVED BY A LICENSED HAZARDOUS MATERIALS CONTRACTOR. CONTRACTOR SHALL NOTIFY OWNER IMMEDIATELY IF HAZARDOUS MATERIALS ARE ENCOUNTERED.
  - CONTRACTOR SHALL PROTECT ALL CORNER PINS, MONUMENTS, PROPERTY CORNERS, AND BENCHMARKS DURING DEMOLITION ACTIVITIES. IF DISTURBED, CONTRACTOR SHALL HAVE DISTURBED ITEMS RESET BY A LICENSED SURVEYOR AT NO ADDITIONAL COST TO THE OWNER.
  - CONTRACTOR SHALL ADHERE TO ALL LOCAL, STATE, FEDERAL, AND OSHA REGULATIONS WHEN OPERATING DEMOLITION EQUIPMENT AROUND UTILITIES.
  - CONTRACTOR SHALL PROVIDE AND MAINTAIN TRAFFIC CONTROL MEASURES IN ACCORDANCE WITH THE NCDOT STANDARDS, AND AS REQUIRED BY LOCAL AGENCIES WHEN WORKING IN AND/OR ALONG STREETS, ROADS, HIGHWAYS, ETC. IT SHALL BE THE CONTRACTOR'S RESPONSIBILITY TO OBTAIN APPROVAL AND COORDINATE WITH THE LOCAL AND/OR STATE AGENCIES REGARDING THE NEED, EXTENT, AND LIMITATIONS ASSOCIATED WITH INSTALLING AND MAINTAINING TRAFFIC CONTROL MEASURES.
  - CONTRACTOR SHALL PROTECT AT ALL TIMES ADJACENT STRUCTURES AND ITEMS FROM DAMAGE DUE TO DEMOLITION OR CONSTRUCTION ACTIVITIES.
  - CONTRACTOR SHALL REMOVE EXISTING VEGETATION AND IMPROVEMENTS WITHIN LIMITS OF DISTURBANCE UNLESS NOTED OTHERWISE.
  - TREES OUTSIDE OF CONSTRUCTION LIMITS OR TREES NOT INDICATED TO BE REMOVED SHALL BE PROTECTED.

- ### Erosion Control Provisions:
- NO PERSON MAY INITIATE A LAND DISTURBING ACTIVITY BEFORE NOTIFYING WAKE COUNTY WATERSHED MANAGEMENT OF THE DATE THAT THE LAND DISTURBING ACTIVITY WILL BEGIN.
  - LAND DISTURBING ACTIVITY BEYOND THAT REQUIRED TO INSTALL APPROPRIATE EROSION CONTROL MAY NOT PROCEED UNTIL EROSION CONTROL MEASURES ARE INSPECTED AND APPROVED BY THE ENGINEER.
  - SCHEDULING OF A PRE-CONSTRUCTION CONFERENCE WITH THE WAKE COUNTY WATERSHED MANAGER, JEEVAN NEUPANE, PE (919-819-8907) PRIOR TO INITIATING LAND DISTURBING ACTIVITIES IS REQUIRED. FOR INSPECTION CALL 919-819-8907. 48 HOUR NOTICE IS REQUIRED.
  - INSTALL TREE PROTECTION FENCING AROUND ALL AREAS OUTSIDE OF THE LIMITS OF DISTURBANCE AS SHOWN ON PLANS.
  - PROVIDE 20' X 50' X 6" STONE CONSTRUCTION ENTRANCES AS SHOWN ON PLAN.
  - SEED OR OTHERWISE PROVIDE GROUND COVER DEVICES OR STRUCTURES SUFFICIENT TO RESTRAIN EROSION FOR ALL EXPOSED SLOPES WITHIN 7 DAYS OF COMPLETION OF ANY PHASE OF GRADING ON PERIMETER AREAS AND SLOPES STEEPER THAN 3:1. ALL OTHER AREAS SHALL BE STABILIZED WITHIN 14 DAYS.
  - CONTRACTOR SHALL INSPECT AND MAINTAIN AS NEEDED ALL EROSION CONTROL DEVICES ON A WEEKLY BASIS AND AFTER EACH MAJOR STORM EVENT. FAILURE TO KEEP ALL EROSION CONTROL DEVICES IN PROPER WORKING ORDER MAY RESULT IN A STOP WORK ORDER OR CIVIL PENALTIES UP TO \$5000.00 PER DAY OF VIOLATION.
  - THE ENGINEER RESERVES THE RIGHT TO REQUIRE ADDITIONAL EROSION CONTROL MEASURES SHOULD THE PLAN OR ITS IMPLEMENTATION PROVE TO BE INADEQUATE.
  - ACCEPTANCE AND APPROVAL OF THIS PLAN IS CONDITIONED UPON YOUR COMPLIANCE WITH FEDERAL AND STATE WATER QUALITY LAWS, REGULATION AND RULES. IN ADDITION LOCAL CITY AND COUNTY ORDINANCES OR RULES MAY ALSO APPLY TO THIS LAND DISTURBING ACTIVITY. APPROVAL BY THE COUNTY DOES NOT SUPERSEDE ANY OTHER PERMIT OR APPROVAL.
  - PLEASE BE ADVISED OF THE RULES TO PROTECT AND MAINTAIN EXISTING BUFFERS ALONG WATERCOURSES IN THE NEUSE AND TAR RIVER BASINS. THESE RULES ARE ENFORCED BY THE DIVISION OF WATER RESOURCES (DWR). DIRECT ANY QUESTIONS ABOUT THE APPLICABILITY OF THESE RULES TO YOUR PROJECT TO THE REGIONAL WATER QUALITY SUPERVISOR, RALEIGH REGIONAL OFFICE AT (919) 791-4200.

- ### Construction Sequence:
- EROSION AND SEDIMENT CONTROL (E&S) PERMIT AND A CERTIFICATE OF COVERAGE (COC) MUST BE OBTAINED BEFORE ANY LAND DISTURBING ACTIVITIES OCCUR.
  - CALL WAKE COUNTY WATERSHED MANAGER JEEVAN NEUPANE AT (919) 819-8907 A MINIMUM OF 48 HOURS IN ADVANCE TO SCHEDULE A PRE-CONSTRUCTION MEETING AND FOR NOTIFICATION OF PROJECT START UP.
  - ANY DEWATERING ON THE SITE SHALL BE DONE THROUGH A SILT BAG THAT IS CONSTANTLY MONITORED.
  - INSTALL GRAVEL CONSTRUCTION PAD, TEMPORARY DIVERSIONS, SILT FENCE, SEDIMENT BASIN OR OTHER MEASURES AS SHOWN ON THE APPROVED PLAN. CLEAR ONLY AS NECESSARY TO INSTALL THESE DEVICES. SEED TEMPORARY DIVERSIONS, BERMS AND BASINS IMMEDIATELY AFTER CONSTRUCTION.
  - CALL WATERSHED MANAGER, JEEVAN NEUPANE FOR AN ON-SITE INSPECTION TO OBTAIN A CERTIFICATE OF COMPLIANCE.
  - BEGIN CLEARING AND GRUBBING. MAINTAIN DEVICES AS NEEDED. ROUGH GRADE SITE. INSTALL TEMPORARY SKIMMER SEDIMENT BASINS, ALONG WITH TEMPORARY DIVERSION DITCHES THAT SHALL BE INSTALLED TO ENSURE AS MUCH FLOW AS POSSIBLE IS DIRECTED TO THE BASINS.
  - AS ROUGH GRADING CONTINUES, DEVICES SHALL BE MAINTAINED AND CLEANED OF SEDIMENT. SKIMMER SEDIMENT BASINS TO BE ABANDONED SHALL BE REMOVED AS FOLLOWS: DEWATER THROUGH SILT BAG, CLEAN SEDIMENT, REMOVE BAFFLES, BACKFILL BASIN AND STABILIZE IMMEDIATELY. DEWATERING OPERATIONS THROUGH SILT BAGS SHALL BE MONITORED CONTINUOUSLY.
  - STABILIZE SITE AS AREAS ARE BROUGHT UP TO FINISH GRADE WITH VEGETATION, DITCH LININGS, ETC. SEED AND MULCH DENUDATED AREAS PER GROUND STABILIZATION TIME FRAME.
  - WHEN ROUGH GRADING IS COMPLETE AND ALL AREAS ARE STABILIZED COMPLETELY, CALL WATERSHED MANAGER JEEVAN NEUPANE FOR INSPECTION.
  - IF SITE IS APPROVED, MAINTAIN TEMPORARY DIVERSIONS, SILT FENCE, SEDIMENT BASINS, ETC., AND SEED OR STABILIZED ANY RESULTING BARE AREAS. ALL REMAINING PERMANENT EROSION CONTROL DEVICES, SUCH AS VELOCITY DISSIPATORS, SHOULD NOW BE INSTALLED.
  - WHEN VEGETATION HAS BECOME ESTABLISHED, CALL FOR FINAL SITE INSPECTION BY THE WATERSHED MANAGER, JEEVAN NEUPANE. OBTAIN CERTIFICATE OF COMPLETION.

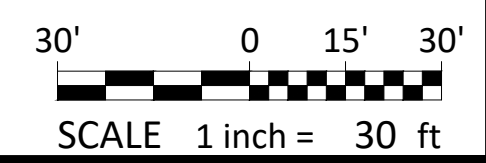
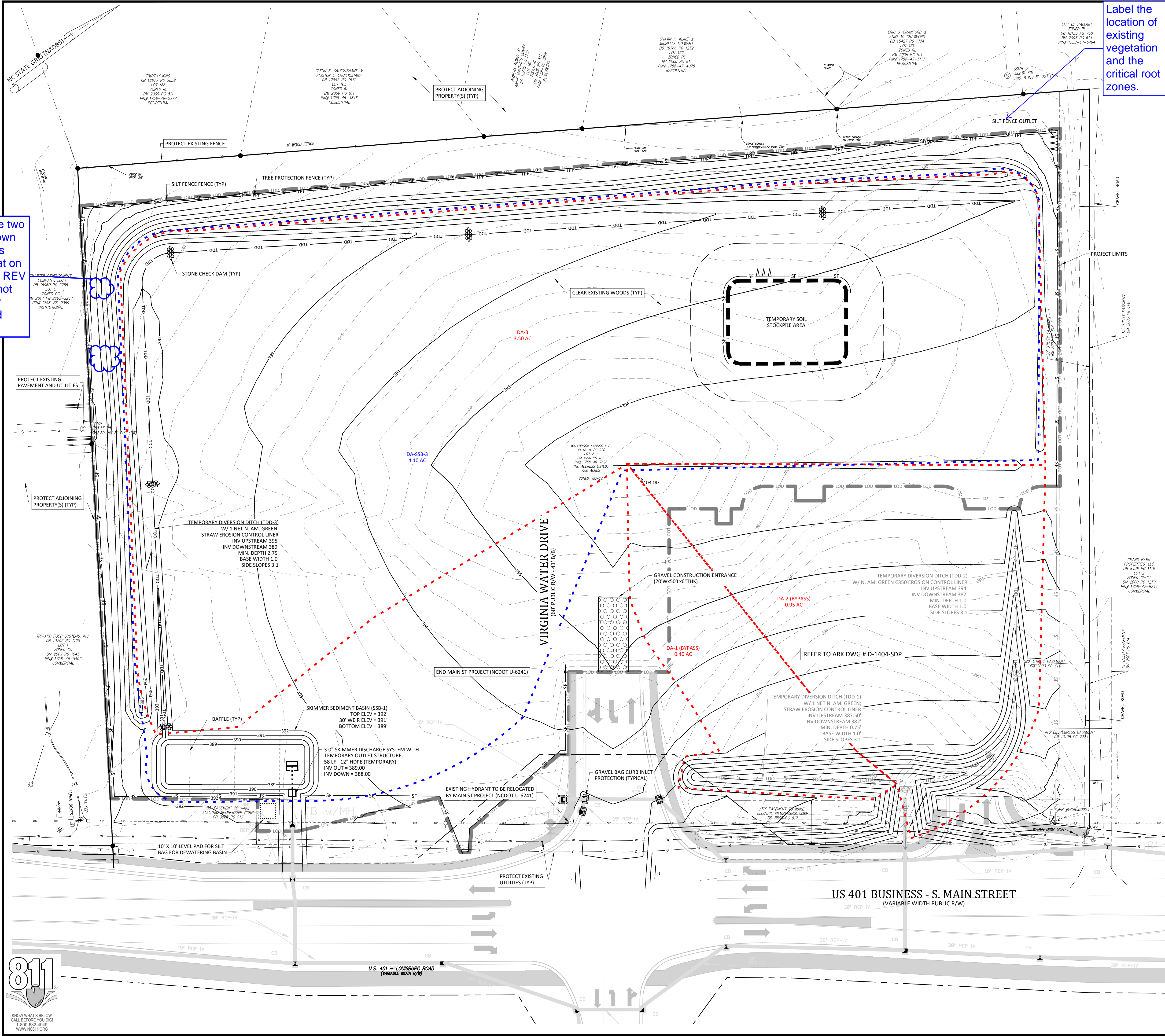

**- Final Drawing -**  
Issued for Permit  
Review Purposes Only

---

REVISIONS:

#	DATE	DESCRIPTION
1	11-MAY-23	ISSUED FOR PERMIT REVIEW

---

**EROSION CONTROL PLAN - PH. 1**  
**WALLBROOK ROADWAY IMPROVEMENTS**  
**VIRGINIA WATER DRIVE EXTENSION (SERVING LOTS 9-11)**  
Town of Roanoke Project No. CID 23-  
US 401 Business / S. Main Street & Virginia Water Drive  
Wake Forest Township, Town of Roanoke, Wake County, North Carolina

---

ARK CONSULTING  
ENGINEERS & PLANNERS  
2755-B Charles Blvd  
Raleigh, NC 27608  
(757) 558-0888  
www.arkconsultinggroup.com

---

Project Manager: BCF  
Drawn By: DLT/TN  
Checked By: TN  
Project Number: 22049  
Drawing Number: D-1404-CID

**C1.0**  
Date: May 2023