

THE POINT GENOVESA DRIVE SIDEWALK EXTENSION

ROLESVILLE, NORTH CAROLINA
CONSTRUCTION DRAWINGS
PROJECT NUMBER: AWH-20000
DATE: APRIL 12, 2023

SHEET INDEX

CO.00	PROJECT NOTES
C1.01	EXISTING CONDITIONS
C2.01	SITE, UTILITY, GRADING AND EROSION CONTROL PLAN
C8.00	SITE AND EROSION CONTROL DETAILS

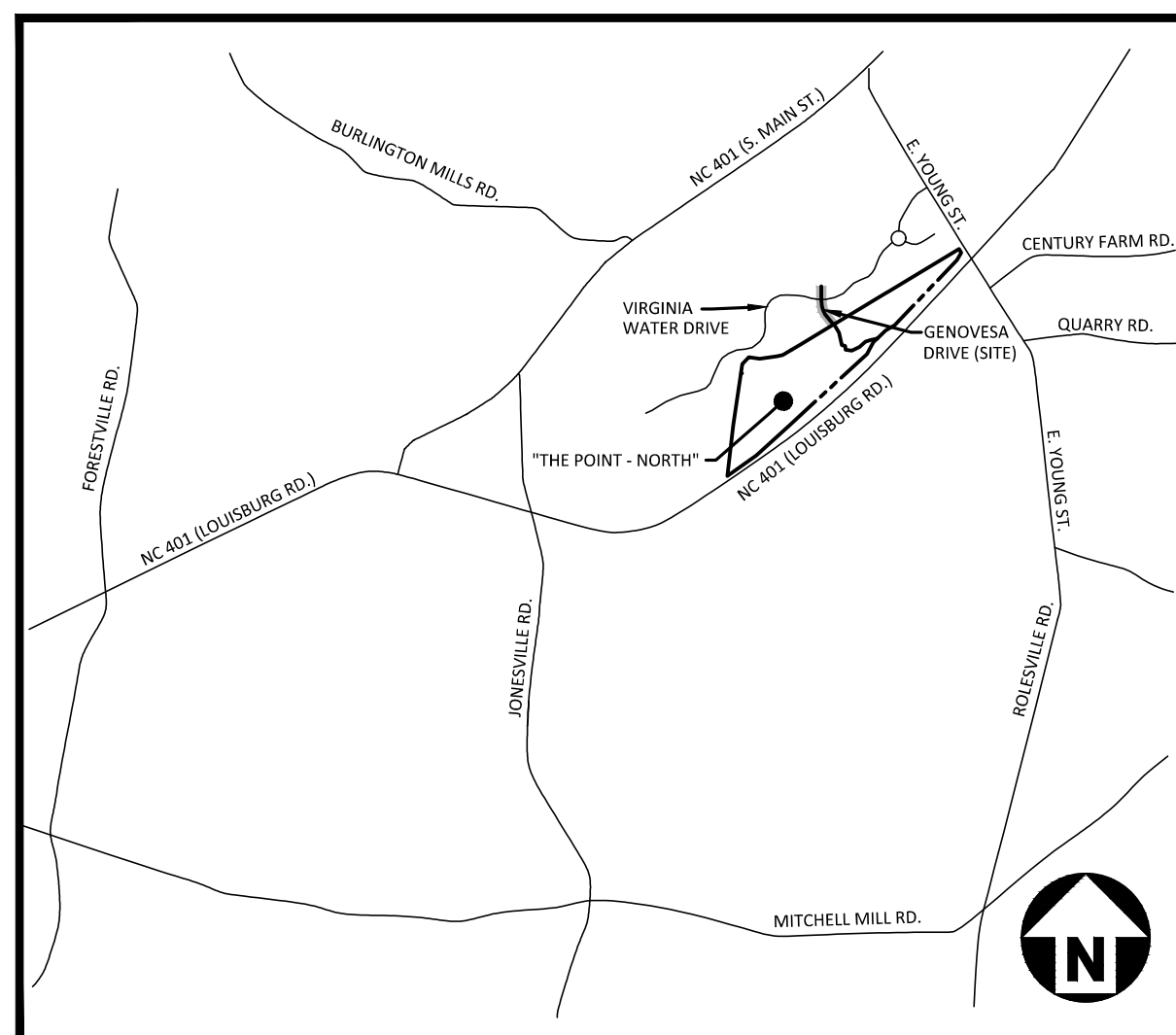

VICINITY MAP
N.T.S.



CID-23-03 / Construction Infrastructure
Drawings / Genovesa Drive Sidewalk

APPROVED

Date: September 20, 2023

Meredith Gruber

Town of Rolesville Planning Department



McADAMS
The John R. McAdams Company, Inc.
2905 Meridian Parkway
Durham, NC 27713
phone 919. 361. 5000
fax 919. 361. 2269
license number: C-0293, C-187
www.mcadamsco.com

CONTACT

MIKE SANCHEZ
sanchez@mcadamsco.com
PHONE: 919. 361. 5000

CLIENT

ASHTON RALEIGH RESIDENTIAL, LLC.
900 RIDGEFIELD DRIVE, SUITE 335
RALEIGH, NORTH CAROLINA 27609
PHONE: 919. 422. 7663
CONTACT: BOB MISHLER



PROJECT DIRECTORY

CID-23-03



W.T. O'Daniel
William T. O'Daniel
c/o=William T. O'Daniel, c=US,
e=North Carolina,
email=odaniel@mcadamsco.com
2023.08.30 15:06:22 -04'00'

REVISIONS

NO.	DATE	REV PER TOWN COMMENTS
1	08.30.2023	REV PER TOWN COMMENTS

CONSTRUCTION DRAWINGS FOR:

THE POINT
GENOVESA DRIVE
SIDEWALK EXTENSION
ROLESVILLE, NORTH CAROLINA
PROJECT NUMBER: AWH-20000

I:\Projects\AWH\AWH-20000\04-Production\Engineering\The Point North\Current Drawings\AWH20000-Sidewalk-N1.dwg, 8/30/2023 10:51:41 AM, Sherril Williams

SITE PLAN NOTES

1. ALL CONSTRUCTION SHALL CONFORM TO THE LATEST TOWN OF ROLESVILLE AND/OR NCDOT STANDARDS AND SPECIFICATIONS AS APPLICABLE.
2. ALL DIMENSIONS SHOWN ON SITE PLAN ARE MEASURED TO BACK OF CURB UNLESS OTHERWISE NOTED.
3. EXISTING IMPROVEMENTS DAMAGED DURING CONSTRUCTION SHALL BE REPLACED/RESTORED TO THEIR ORIGINAL CONDITION AND TO THE SATISFACTION OF THE OWNER, BY THE CONTRACTOR RESPONSIBLE FOR THE DAMAGE.
4. THE CONTRACTOR SHALL NOTE THAT THE DRAWINGS MAY NOT SHOW EVERY OFFSET, TRANSITION, FITTING, ETC. THAT MAY BE REQUIRED. THE CONTRACTOR SHALL INSTALL SUCH STANDARD APPURTENANCES AS REQUIRED TO CLOSELY FOLLOW THE GRADES AND ALIGNMENTS DEPICTED ON THE PLANS.
5. CONTRACTOR SHALL NOTIFY "NC811" (811) OR (1-800-632-4949) AT LEAST 3 FULL BUSINESS DAYS PRIOR TO BEGINNING CONSTRUCTION OR EXCAVATION TO HAVE EXISTING UTILITIES LOCATED. CONTRACTOR SHALL CONTACT ANY LOCAL UTILITIES THAT PROVIDE THEIR OWN LOCATOR SERVICES INDEPENDENT OF "NC811". REPORT ANY DISCREPANCIES TO THE ENGINEER IMMEDIATELY.
6. CONTRACTOR IS RESPONSIBLE FOR COORDINATING CONSTRUCTION ACTIVITIES WITH THE APPROPRIATE UTILITY COMPANIES FOR ANY REQUIRED RELOCATIONS (I.E. POWER POLES, TELEPHONE PEDESTALS, WATER METERS, ETC.).
7. ALL DIMENSIONS AND GRADES SHOWN ON THE PLANS SHALL BE FIELD VERIFIED BY THE CONTRACTOR PRIOR TO CONSTRUCTION. CONTRACTOR SHALL NOTIFY THE ENGINEER IF ANY DISCREPANCIES EXIST PRIOR TO PROCEEDING WITH CONSTRUCTION, FOR NECESSARY PLAN OR GRADE CHANGES. NO EXTRA COMPENSATION SHALL BE PAID TO CONTRACTOR FOR ANY WORK DONE DUE TO DIMENSIONS OR GRADES SHOWN INCORRECTLY ON THESE PLANS IF SUCH NOTIFICATION HAS NOT BEEN GIVEN.
8. ALL SIDEWALKS THAT CONNECT TO THE PUBLIC RIGHT-OF-WAY MUST BE ACCESSIBLE TO PERSONS WHO ARE BLIND, HAVE LOW VISION AND PEOPLE WITH MOBILITY DISABILITIES. PEDESTRIAN EXISTING ROUTES AND ALTERNATE PEDESTRIAN ROUTES DURING CONSTRUCTION WILL BE REQUIRED TO BE COMPLIANT WITH THE PUBLIC RIGHTS OF WAY ACCESSIBILITY GUIDELINES (PROWAG), 2010 ADA STANDARDS FOR ACCESSIBLE DESIGN AND THE MANUAL ON UNIFORM TRAFFIC CONTROL DEVICES (MUTCD).
9. EQUIPMENT AND PRODUCTS OTHER THAN THOSE SPECIFIED MAY BE USED PROVIDED APPROVAL HAS BEEN OBTAINED FROM THE OWNER IN WRITING PRIOR TO ORDERING OR INSTALLATION. THE CONTRACTOR SHALL WAIVE ANY CLAIM FOR ADDITIONAL COST RELATED TO SUBSTITUTION OF ALTERNATE EQUIPMENT.
10. ALL SIGNAGE ASSOCIATED WITH THE PUBLIC STREET SYSTEM SHALL ADHERE TO MUTCD STANDARDS AND SPECIFICATIONS.

GRADING NOTES

1. ALL DIMENSIONS AND GRADES SHOWN ON THE PLANS SHALL BE FIELD VERIFIED BY THE CONTRACTOR PRIOR TO CONSTRUCTION. CONTRACTOR SHALL NOTIFY THE ENGINEER IF ANY DISCREPANCIES EXIST PRIOR TO PROCEEDING WITH CONSTRUCTION, FOR NECESSARY PLAN OR GRADE CHANGES. NO EXTRA COMPENSATION SHALL BE PAID TO THE CONTRACTOR FOR ANY WORK DONE DUE TO DIMENSIONS OR GRADES SHOWN INCORRECTLY ON THESE PLANS IF SUCH NOTIFICATION HAS NOT BEEN GIVEN.
2. OCCUPATIONAL SAFETY AND HEALTH ADMINISTRATION (OSHA) STANDARDS FOR EXCAVATIONS; FINAL RULE 29CFR PART 1926, SUBPART "P" APPLIES TO ALL EXCAVATIONS EXCEEDING FIVE (5) FEET IN DEPTH. EXCAVATION EXCEEDING TWENTY (20) FEET IN DEPTH REQUIRES THE DESIGN OF A TRENCH SAFETY SYSTEM BY A REGISTERED PROFESSIONAL ENGINEER, PROVIDED BY CONTRACTOR RESPONSIBLE FOR EXCAVATION.
3. ALL CONSTRUCTION SHALL BE IN ACCORDANCE WITH THE TOWN OF ROLESVILLE AND/OR NCDOT STANDARDS AND SPECIFICATIONS AS APPLICABLE.
4. CONTRACTOR SHALL NOTIFY "NC811" (811) OR (1-800-632-4949) AT LEAST 3 FULL BUSINESS DAYS PRIOR TO BEGINNING CONSTRUCTION OR EXCAVATION TO HAVE EXISTING UTILITIES LOCATED. CONTRACTOR SHALL CONTACT ANY LOCAL UTILITIES THAT PROVIDE THEIR OWN LOCATOR SERVICES INDEPENDENT OF "NC811". REPORT ANY DISCREPANCIES TO THE ENGINEER IMMEDIATELY.
5. CONSTRUCTION, MAINTENANCE AND REMOVAL OF ALL EROSION CONTROL DEVICES ARE THE RESPONSIBILITY OF THE GENERAL CONTRACTOR. TIMING OF REMOVAL SHALL BE COORDINATED WITH THE EROSION CONTROL INSPECTOR.
6. EXISTING UTILITIES AND STRUCTURES SHOWN, BOTH UNDERGROUND AND ABOVE GROUND, ARE BASED ON A FIELD SURVEY AND THE BEST AVAILABLE RECORD DRAWINGS. THE CONTRACTOR SHALL VERIFY FIELD CONDITIONS PRIOR TO BEGINNING RELATED CONSTRUCTION. ANY DISCREPANCIES SHALL BE REPORTED TO THE ENGINEER IMMEDIATELY.
7. SOIL UNDER BUILDINGS, PAVED AREAS AND WITHIN SLOPES GREATER THAN 3:1 (H:V) SHALL BE APPROVED, PLACED AND COMPACTED AS RECOMMENDED BY THE GEOTECHNICAL ENGINEER.



**Know what's below.
Call before you dig.**

CONTRACTOR SHALL NOTIFY "NC811" (811) OR (1-800-632-4949) AT LEAST 3 FULL BUSINESS DAYS PRIOR TO BEGINNING CONSTRUCTION OR EXCAVATION TO HAVE EXISTING UTILITIES LOCATED. CONTRACTOR SHALL CONTACT ANY LOCAL UTILITIES THAT PROVIDE THEIR OWN LOCATOR SERVICES INDEPENDENT OF "NC811". REPORT ANY DISCREPANCIES TO THE ENGINEER IMMEDIATELY.

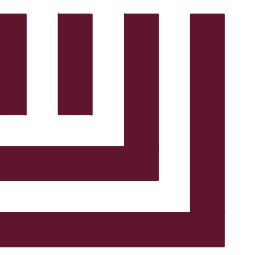

McADAMS

The John R. McAdams Company, Inc.
2905 Meridian Parkway
Durham, NC 27713

phone 919. 361. 5000
fax 919. 361. 2269
license number: C-0293, C-187

www.mcadamsco.com

CLIENT

ASHTON RALEIGH RESIDENTIAL, LLC.
900 RIDGEFIELD DRIVE, SUITE 335
RALEIGH, NORTH CAROLINA 27609
PHONE: 919. 422. 7663
CONTACT: BOB MISHLER



ASHTON WOODS.

**THE POINT
GENOVESA DRIVE
SIDEWALK EXTENSION
CONSTRUCTION DRAWINGS**
TOWN OF ROLESVILLE, WAKE FOREST TOWNSHIP,
WAKE COUNTY, NORTH CAROLINA

CID-23-03



W.T. O'Daniel
William T. O'Daniel
c=William T. O'Daniel, c=US,
o=North Carolina,
email=odaniel@mcadamsco.com
2023.08.30 15:07:38 -04'00'

REVISIONS

NO.	DATE	REV PER TOWN COMMENTS
1	08.30.2023	REV PER TOWN COMMENTS

PLAN INFORMATION

PROJECT NO.	AWH-20000
FILENAME	AWH20000-SIDEWALK-N1
CHECKED BY	.
DRAWN BY	.
SCALE	N.T.S.
DATE	04.12.2023

SHEET

PROJECT NOTES

C0.00

GENERAL NOTES

1. THIS IS A SURVEY OF AN EXISTING PARCEL OF LAND. THIS IS A TOPOGRAPHIC SURVEY.
2. BEARINGS FOR THIS SURVEY ARE BASED ON NC GRID NAD 83(2011) COORDINATES.
3. ALL DISTANCES ARE HORIZONTAL GROUND DISTANCES.
4. ZONING: RM-CZ PER WAKE COUNTY GIS.
5. AREA BY COORDINATE GEOMETRY.
6. FLOOD NOTE: THIS PROPERTY IS NOT LOCATED IN A SPECIAL FLOOD HAZARD ZONE. IT IS LOCATED IN ZONE "X" AS DEFINED BY F.E.M.A. F.I.R.M COMMUNITY PANEL #3720176800K DATED 07/19/2022.
7. REFERENCES: AS SHOWN
8. UTILITY STATEMENT
THE UNDERGROUND UTILITIES SHOWN HAVE BEEN LOCATED FROM FIELD SURVEY INFORMATION AND EXISTING DRAWINGS. THE SURVEYOR MAKES NO GUARANTEE THAT THE UNDERGROUND UTILITIES SHOWN COMPRISE ALL SUCH UTILITIES IN THE AREA, EITHER IN SERVICE OR ABANDONED. THE SURVEYOR FURTHER DOES NOT WARRANT THAT THE UNDERGROUND UTILITIES SHOWN ARE IN THE EXACT LOCATION INDICATED ALTHOUGH HE DOES CERTIFY THAT THEY ARE LOCATED AS ACCURATELY AS POSSIBLE FROM INFORMATION AVAILABLE. THE SURVEYOR HAS NOT PHYSICALLY LOCATED THE UNDERGROUND UTILITIES.
9. THIS SURVEY PERFORMED AND MAP PREPARED WITHOUT BENEFIT OF A TITLE REPORT. THIS SURVEY SUBJECT TO ANY FACTS AND EASEMENTS WHICH MAY BE DISCLOSED BY A FULL AND ACCURATE TITLE SEARCH.
10. ELEVATIONS FOR THIS SURVEY ARE BASED ON NAVD88

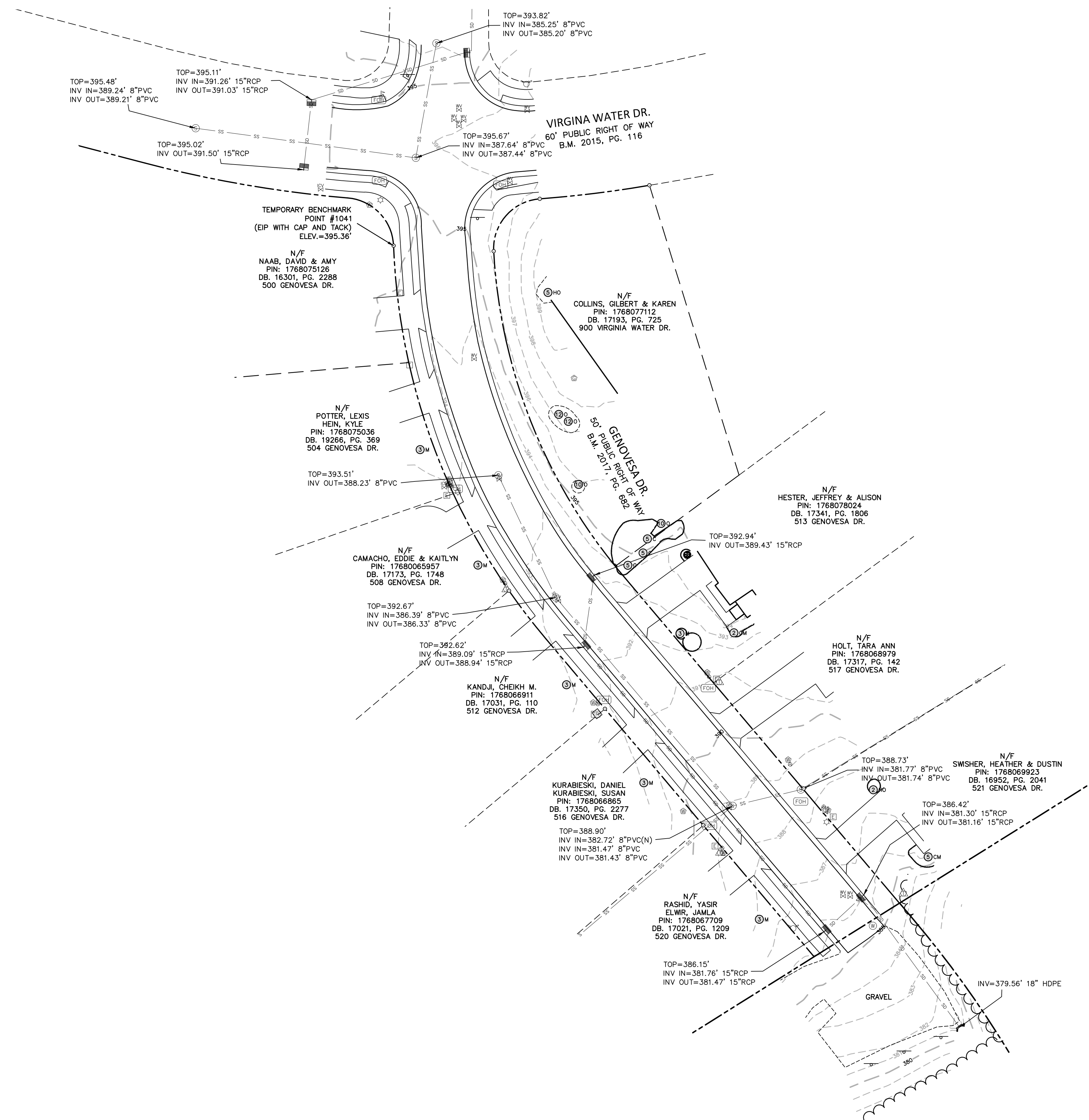

LEGEND

○	EXISTING IRON PIPE
⊕	FIRE HYDRANT
⊙	WATER METER
⊗	WATER MANHOLE
⊘	WATER VALVE
⊚	CL CATCH BASIN AT BC
⊛	ELECTRIC TRANSFORMER
⊜	ELECTRIC BOX
⊝	LIGHT POLE
⊞	CLEAN OUT
⊠	SEWER MANHOLE
⊡	IRRIGATION CONTROL VALVE
⊣	GAS SERVICE METER
⊥	GAS TEST STATION
⊦	TELEPHONE BOX
⊧	TELEPHONE PEDESTAL
⊩	FIBER OPTIC MARKER
⊫	FIBER OPTIC HANDHOLE
⊭	SIGN
⊮	CEDAR
⊯	CRAPE MYRTLE
⊰	HOLLY
⊱	MAPLE
⊲	OAK
---	BOUNDARY LINE BY OTHERS
- - -	ADJOINER LINE
- · - · -	ADJOINER GIS LINE BY OTHERS
---	RIGHT OF WAY LINE
SS	SEWER LINE
SO	STORM LINE

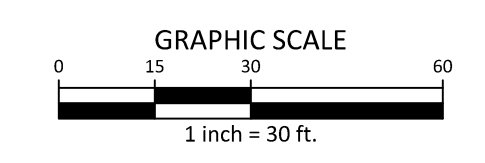

I:\Projects\AWH\AWH-20000\02_Geomatics\Survey\Topographic\AWH20000-CL.dwg, 8/30/2023, 1:05:32 PM, Sherill Williams

McADAMS
The John R. McAdams Company, Inc.
2905 Meridian Parkway
Durham, NC 27713
phone 919. 361. 5000
fax 919. 361. 2269
license number: C-0293, C-187
www.mcadamsco.com

CLIENT
ASHTON RALEIGH RESIDENTIAL, LLC.
900 RIDGEFIELD DRIVE, SUITE 335
RALEIGH, NORTH CAROLINA 27609
PHONE: 919. 422. 7663
CONTACT: BOB MISHLER



**THE POINT
GENOVESA DRIVE
SIDEWALK EXTENSION
CONSTRUCTION DRAWINGS**
TOWN OF ROLESVILLE, WAKE FOREST TOWNSHIP,
WAKE COUNTY, NORTH CAROLINA

CID-23-03

8/30/2023

REVISIONS

NO.	DATE	REV PER TOWN COMMENTS
1	08.30.2023	REV PER TOWN COMMENTS

PLAN INFORMATION

PROJECT NO.	AWH-20000
FILENAME	AWH20000-C1
CHECKED BY	JBT
DRAWN BY	JBT
SCALE	1"=30'
DATE	04.12.2023

**EXISTING
CONDITIONS
C1.01**

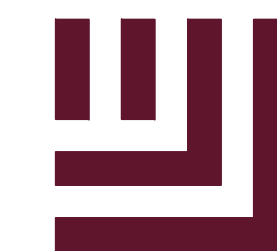

McADAMS

The John R. McAdams Company, Inc.
2905 Meridian Parkway
Durham, NC 27713

phone 919. 361. 5000
fax 919. 361. 2269
license number: C-0293, C-187

www.mcadamsco.com

CLIENT
ASHTON RALEIGH RESIDENTIAL, LLC.
900 RIDGEFIELD DRIVE, SUITE 335
RALEIGH, NORTH CAROLINA 27609
PHONE: 919. 422. 7663
CONTACT: BOB MISHLER

ASHTON WOODS

THE POINT
GENOVESA DRIVE
SIDEWALK EXTENSION
CONSTRUCTION DRAWINGS
TOWN OF ROLESVILLE, WAKE FOREST TOWNSHIP,
WAKE COUNTY, NORTH CAROLINA

CID-23-03



William T. O'Daniel
Professional Engineer
No. 22630
c/o William T. O'Daniel, c/o US,
Wake County, NC
email=odaniel@mcadamsco.com
2023.08.30 15:07:57 -0400

REVISIONS

NO.	DATE	REV PER TOWN COMMENTS
1	08.30.2023	REV PER TOWN COMMENTS

PLAN INFORMATION

PROJECT NO. AWH-20000
FILENAME AWH20000-SIDEWALK-G1
CHECKED BY .
DRAWN BY .
SCALE 1"=20'
DATE 04.12.2023

SHEET
SITE, UTILITY, GRADING, AND EROSION CONTROL PLAN
C2.01

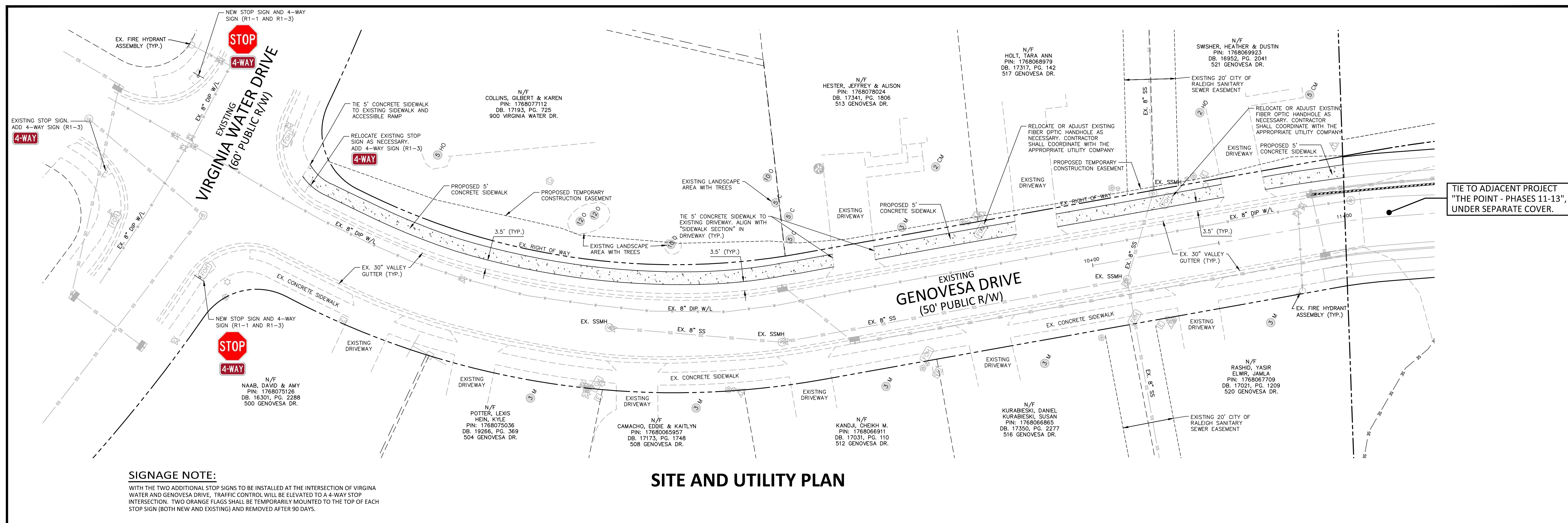

SIGNAGE NOTE:
WITH THE TWO ADDITIONAL STOP SIGNS TO BE INSTALLED AT THE INTERSECTION OF VIRGINIA WATER AND GENOVESA DRIVE, TRAFFIC CONTROL WILL BE ELEVATED TO A 4-WAY STOP INTERSECTION. TWO ORANGE FLAGS SHALL BE TEMPORARILY MOUNTED TO THE TOP OF EACH STOP SIGN (BOTH NEW AND EXISTING) AND REMOVED AFTER 90 DAYS.

SITE AND UTILITY PLAN

TIE TO ADJACENT PROJECT "THE POINT - PHASES 11-13", UNDER SEPARATE COVER.

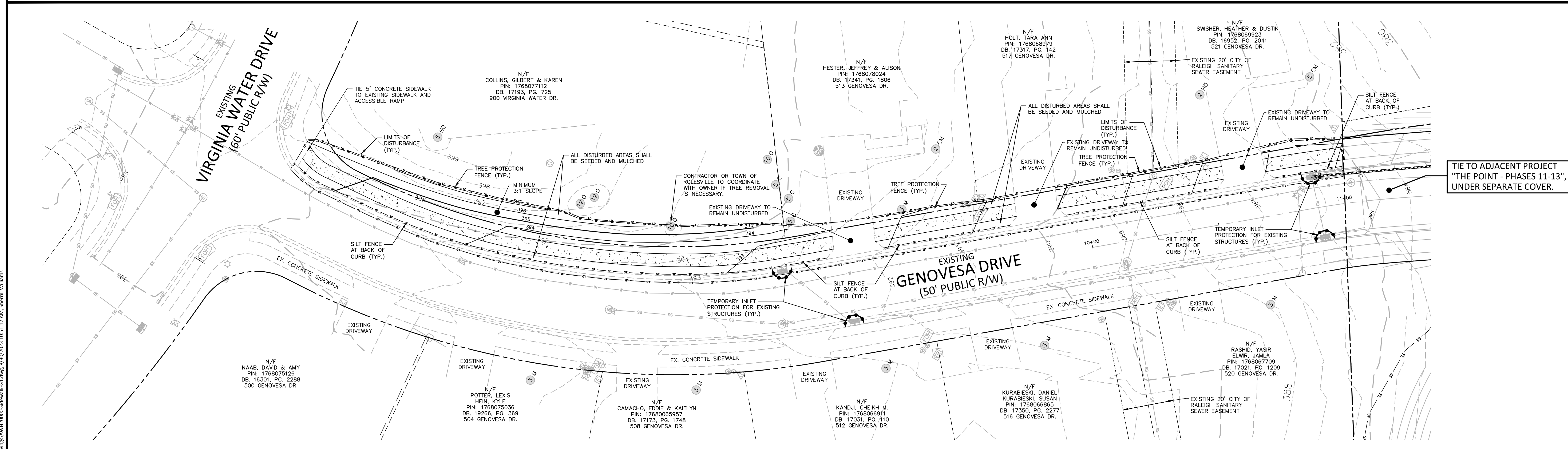

GRADING AND EROSION CONTROL PLAN

TIE TO ADJACENT PROJECT "THE POINT - PHASES 11-13", UNDER SEPARATE COVER.

GRADING LEGEND

	DRAINAGE FLOW ARROW
	TOP & BOTTOM CURB ELEVATIONS
	BOTTOM OF WALL ELEVATION (NOTE: BOTTOM OF WALL IS GROUND ELEVATION NOT WALL FOUNDATION)
	SPOT ELEVATION
	LIMITS OF DISTURBANCE
	MAJOR CONTOUR
	MINOR CONTOUR
	EXISTING MAJOR CONTOUR
	EXISTING MINOR CONTOUR
	EASEMENT LINE

EROSION CONTROL LEGEND

	SILT FENCE OUTLET
	INLET PROTECTION FOR EXISTING STRUCTURES
	CHECK DAM
	SILT FENCE
	TREE PROTECTION FENCE
	LIMITS OF DISTURBANCE

TREE LEGEND

	CEDAR
	CRAPE MYRTLE
	MAPLE
	HOLLY
	OAK

DISTURBED AREA = 0.18 AC.

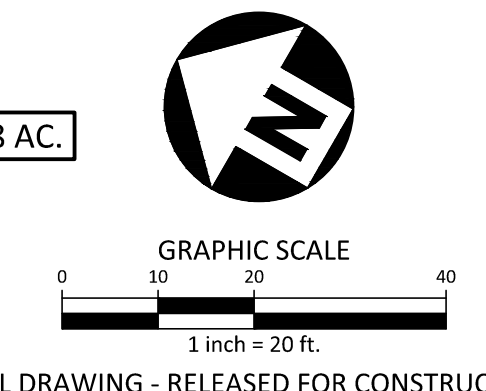

FINAL DRAWING - RELEASED FOR CONSTRUCTION

M:\Projects\AWH\AWH-20000\04 Production\Drawings\The Point North\Current Drawings\Engineering\The Point North\AWH20000-SideWalk-G1.dwg, 8/30/2023 10:51:17 AM, Sherill Williams

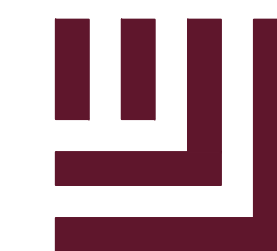

McADAMS

The John R. McAdams Company, Inc.
2905 Meridian Parkway
Durham, NC 27713

phone 919. 361. 5000
fax 919. 361. 2269
license number: C-0293, C-187

www.mcadamsco.com

CLIENT

ASHTON RALEIGH RESIDENTIAL, LLC.
900 RIDGEFIELD DRIVE, SUITE 335
RALEIGH, NORTH CAROLINA 27609
PHONE: 919. 422. 7663
CONTACT: BOB MISHLER



ASHTON WOODS

THE POINT
GENOVESA DRIVE
SIDEWALK EXTENSION
CONSTRUCTION DRAWINGS
TOWN OF ROLESVILLE, WAKE FOREST TOWNSHIP,
WAKE COUNTY, NORTH CAROLINA

CID-23-03



William T. O'Daniel
c/o William T. O'Daniel, c/o US,
c/o North Carolina
email=odaniel@mcadamsco.com
2023.08.30 15:08:16 -04'00'

REVISIONS

NO.	DATE	REV PER TOWN COMMENTS
1	08.30.2023	REV PER TOWN COMMENTS

PLAN INFORMATION

PROJECT NO. AWH-20000
FILENAME AWH20000-SIDEWALK-D1
CHECKED BY .
DRAWN BY .
SCALE N.T.S.
DATE 04.12.2023

SHEET

SITE AND EROSION
CONTROL DETAILS

C8.00

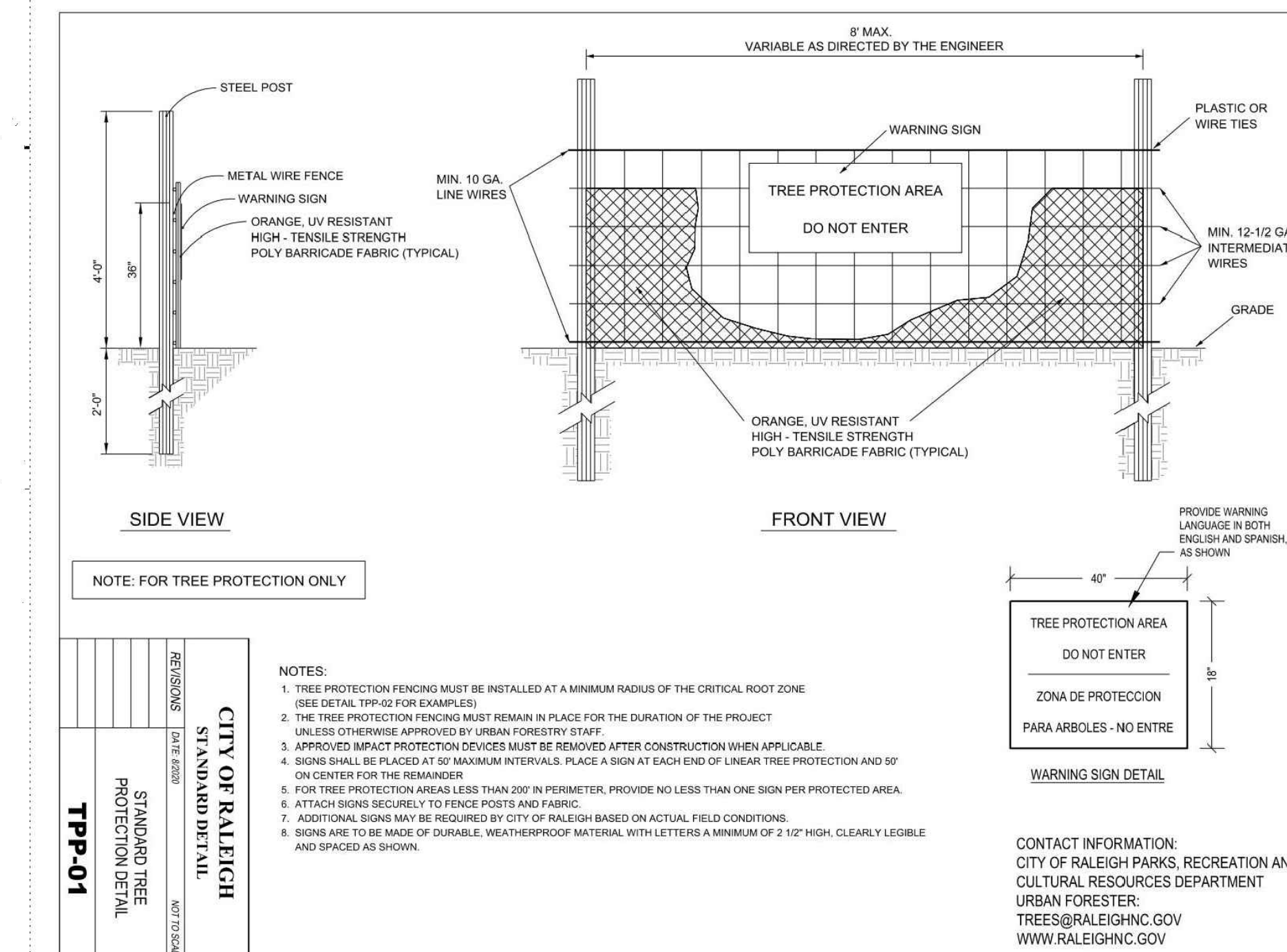
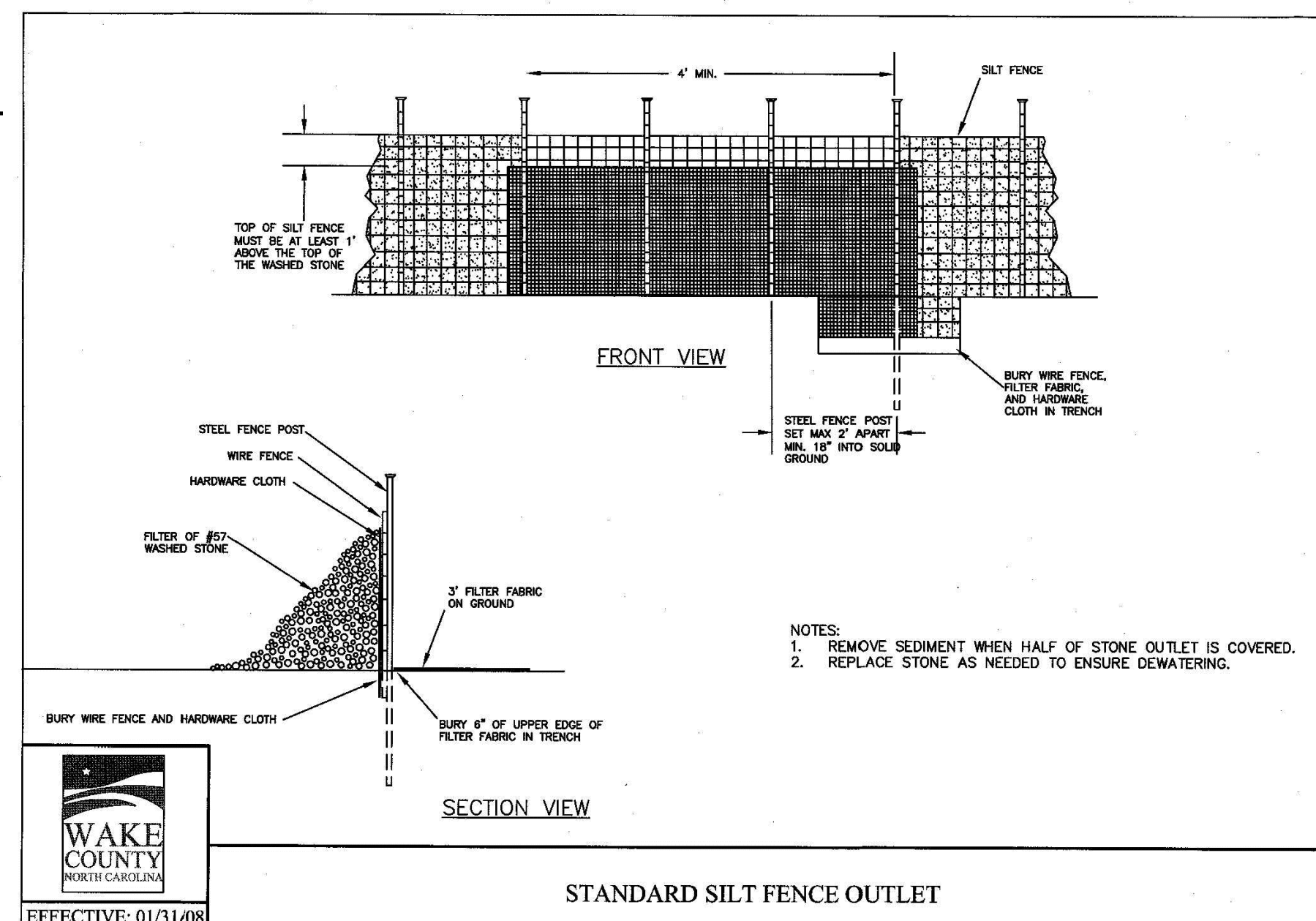
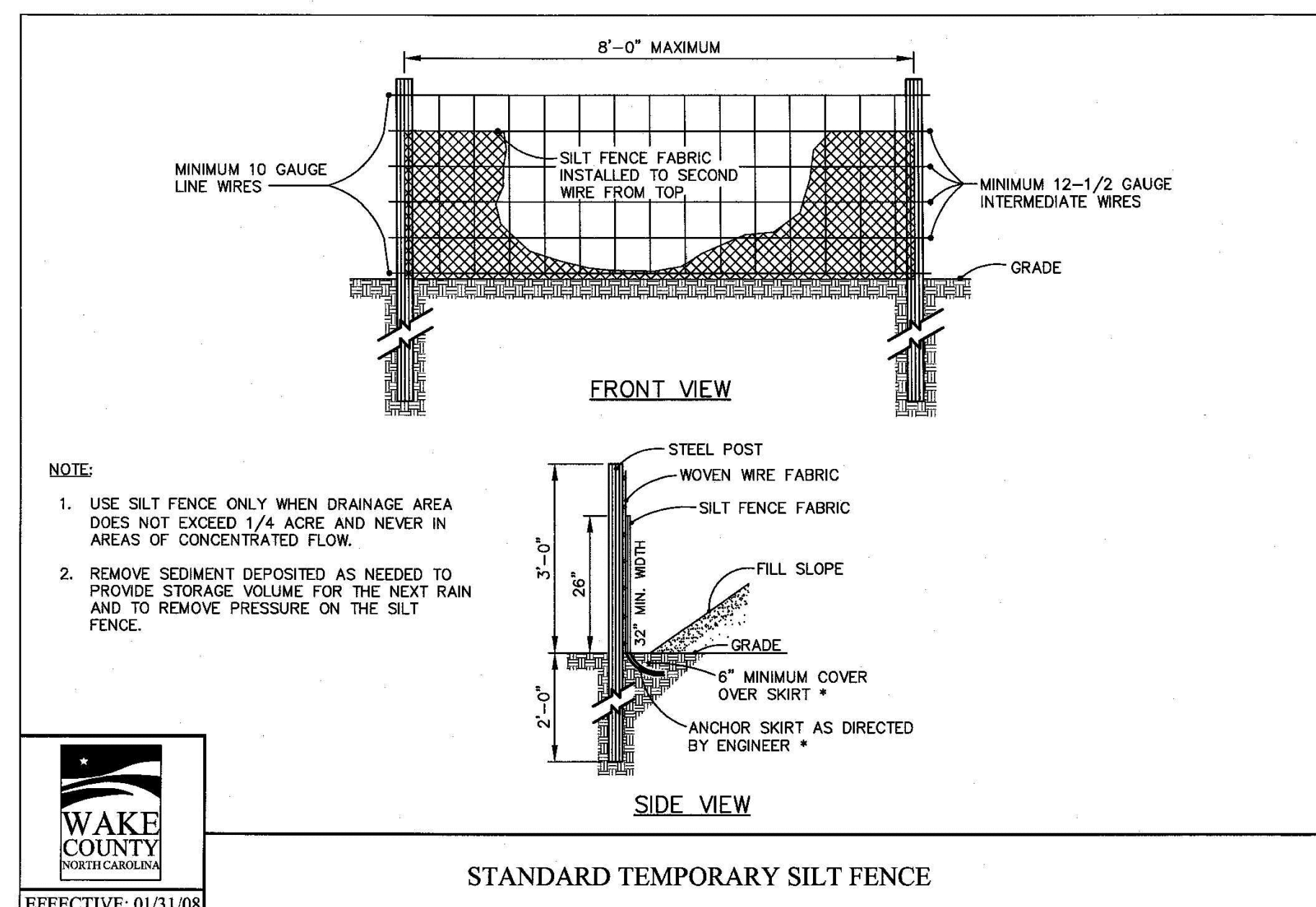

SEEDING AND MULCHING

SEEDING AND MULCHING SHALL BE CARRIED OUT IMMEDIATELY BEHIND CONSTRUCTION IN ACCORDANCE WITH FOLLOWING SPECIFICATIONS:

SEEDING SPECIFICATIONS			
SHOULDER, SIDE DITCHES, SLOPES (MAX 3:1)			
SEEDING PERIOD	TYPE	APPLICATION RATE	
		PER ACRE	PER 1000 SF
AUGUST 15 - NOVEMBER 1	TALL FESCUE	300#	7#
	TALL FESCUE AND ABRUZZI RYE	25#	0.6#
NOVEMBER 1 - MARCH 1	TALL FESCUE	300#	7#
MARCH 1 - APRIL 15	TALL FESCUE	300#	7#
APRIL 15 - JUNE 30	HULLED COMMON BERMUDAGRASS	25#	0.6#
JULY 1 - AUGUST 15	TALL FESCUE AND *BROWNTOP MILLET	120#	2.8#
	*BROWNTOP MILLET	35#	0.8#
	*OR SORGHUM-SUDAN HYBRIDS	30#	0.7#

SEEDING SPECIFICATIONS			
SLOPES (3:1 TO 2:1)			
SEEDING PERIOD	TYPE	APPLICATION RATE	
		PER ACRE	PER 1000 SF
MARCH 1 - JUNE 1	SERICEA LESPEDEZA (SCARIFIED) AND	50#	1.2#
MARCH 1 - APRIL 15	ADD TALL FESCUE	120#	2.8#
MARCH 1 - JUNE 30	OR ADD WEEPING LOVE GRASS	10#	0.2#
MARCH 1 - JUNE 30	OR ADD HULLED COMMON BERMUDAGRASS	25#	0.6#
JUNE 1 - SEPTEMBER 1	*TALL FESCUE AND *OR BROWNTOP MILLET	120#	2.8#
	*OR BROWNTOP MILLET	35#	0.8#
	*OR SORGHUM-SUDAN HYBRIDS	30#	0.7#
SEPTEMBER 1 - MARCH 1	SERICEA LESPEDEZA (UNHULLED, UNSCARIFIED) AND TALL FESCUE	70#	1.6#
	AND TALL FESCUE	120#	2.8#
NOVEMBER 1 - MARCH 1	ADD ABRUZZI RYE	25#	0.6#

*TEMPORARY - RESEED ACCORDING TO OPTIMUM SEASON FOR DESIRED PERMANENT VEGETATION. DO NOT ALLOW TEMPORARY COVER TO GROW TO MORE THAN 12 INCHES HEIGHT BEFORE MOWING, OTHERWISE FESCUE MAY BE SHADED OUT.

CONSULT WAKE SOIL AND WATER CONSERVATION DISTRICT OR NORTH CAROLINA DIVISION OF SOIL AND WATER CONSERVATION FOR ADDITIONAL INFORMATION CONCERNING OTHER ALTERNATIVES FOR VEGETATION OF DENUDEED AREAS. THE ABOVE VEGETATION RATES ARE THOSE THAT DO WELL UNDER LOCAL CONDITIONS; OTHER SEEDING RATE COMBINATIONS ARE POSSIBLE.

SEEDBED PREPARATION

- CHISEL COMPACTED AREAS AND SPREAD TOPSOIL 3 INCHES DEEP OVER ADVERSE SOIL CONDITIONS, IF AVAILABLE.
 - RIP THE ENTIRE AREA TO 6-INCH DEPTH.
 - REMOVE ALL LOOSE ROCK, ROOTS AND OTHER OBSTRUCTIONS LEAVING SURFACE REASONABLE SMOOTH AND UNIFORM.
 - APPLY AGRICULTURAL LIME, FERTILIZER AND SUPERPHOSPHATE UNIFORMLY AND MIX WITH SOIL (SEE BELOW).
 - CONTINUE TILLAGE UNTIL A WELL-PULVERIZED, FIRM, REASONABLE UNIFORM SEEDBED IS PREPARED 4 TO 6 INCHES DEEP.
 - SEED ON A FRESHLY PREPARED SEEDBED AND COVER SEED LIGHTLY WITH SEEDING EQUIPMENT OR CULTIPACK AFTER SEEDING.
 - MULCH IMMEDIATELY AFTER SEEDING AND ANCHOR MULCH.
 - INSPECT ALL SEEDED AREAS AND MAKE NECESSARY REPAIRS OR RESEEDINGS WITHIN THE PLANTING SEASON, IF POSSIBLE. IF STAND SHOULD BE OVER 60 PERCENT DAMAGED, RE-ESTABLISH FOLLOWING ORIGINAL LIME, FERTILIZER AND SEEDING RATES.
 - CONSULT WAKE SOIL AND WATER CONSERVATION DISTRICT ON MAINTENANCE TREATMENT AND FERTILIZATION AFTER PERMANENT COVER IS ESTABLISHED.
- * APPLY:
- | | |
|------------------------|--|
| AGRICULTURAL LIMESTONE | - 2 TONS/ACRE (3/TONS/ACRES IN CLAY SOILS) |
| FERTILIZER | - 1000 LB/ACRE - 10-10-10 |
| SUPERPHOSPHATE | - 500 LB/ACRE - 20 PERCENT ANALYSIS |
| MULCH | - 2 TONS/ACRE - SMALL GRAIN STRAW |
| ANCHOR | - ASPHALT EMULSION @ 300 GALS/ACRE |

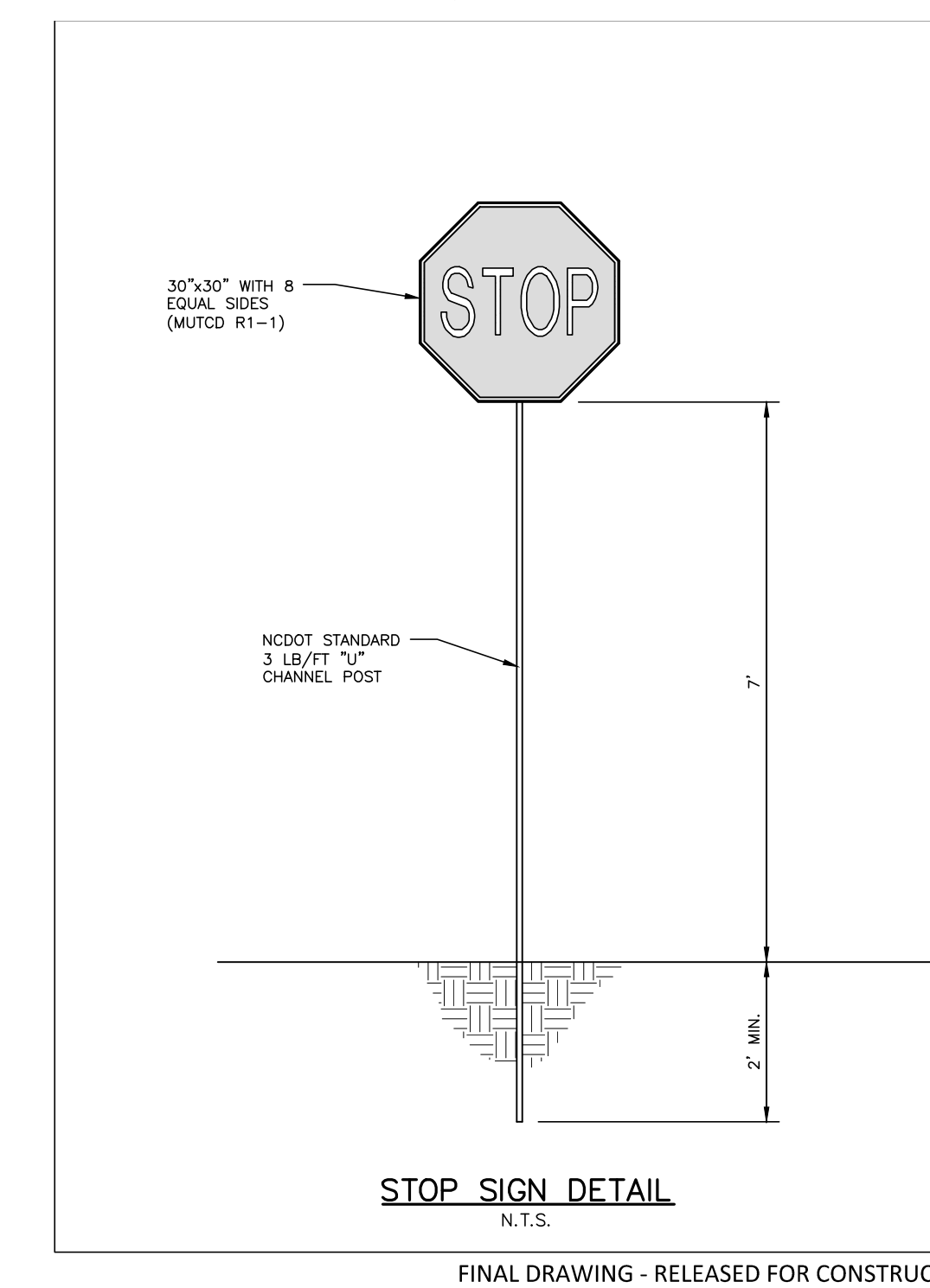
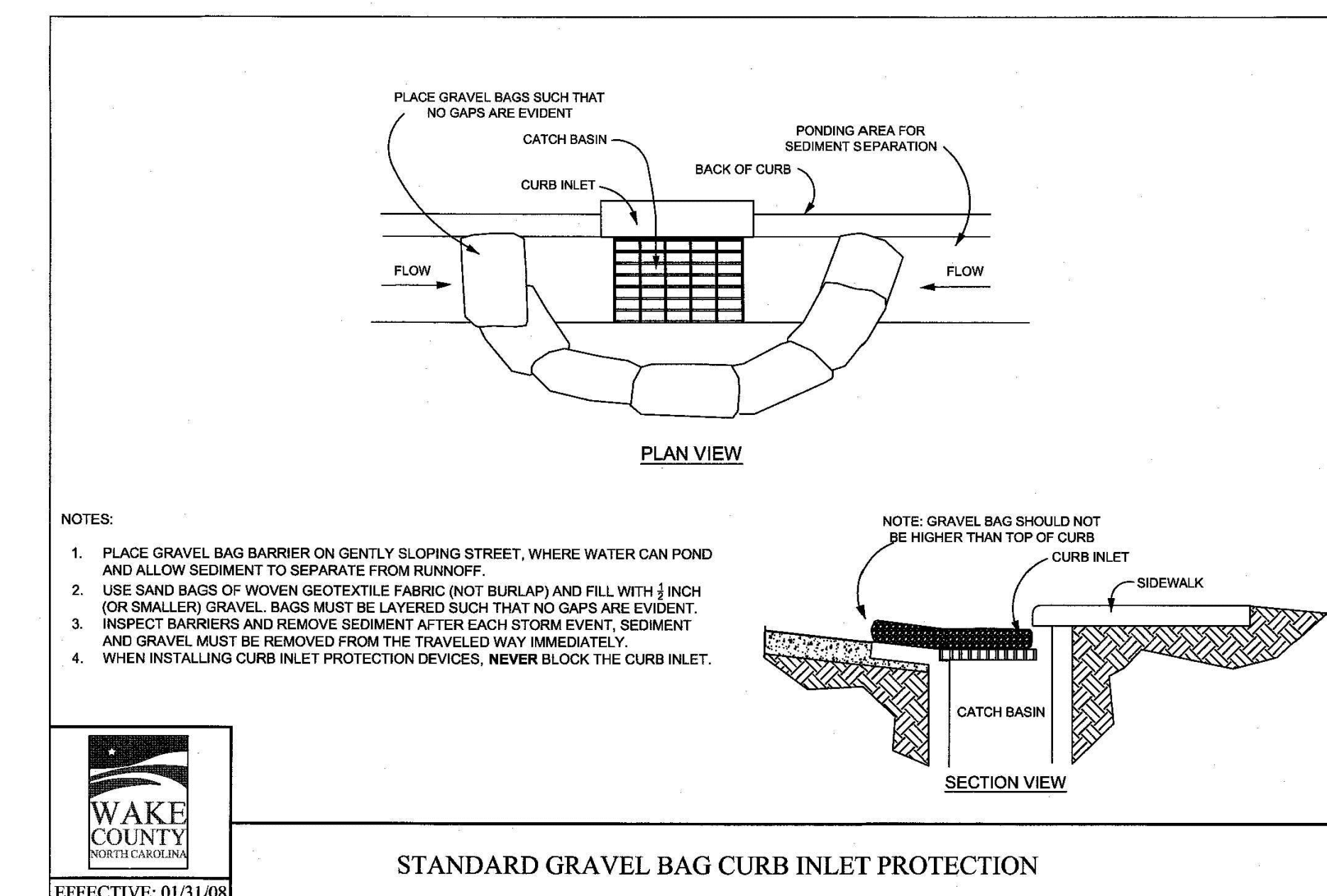
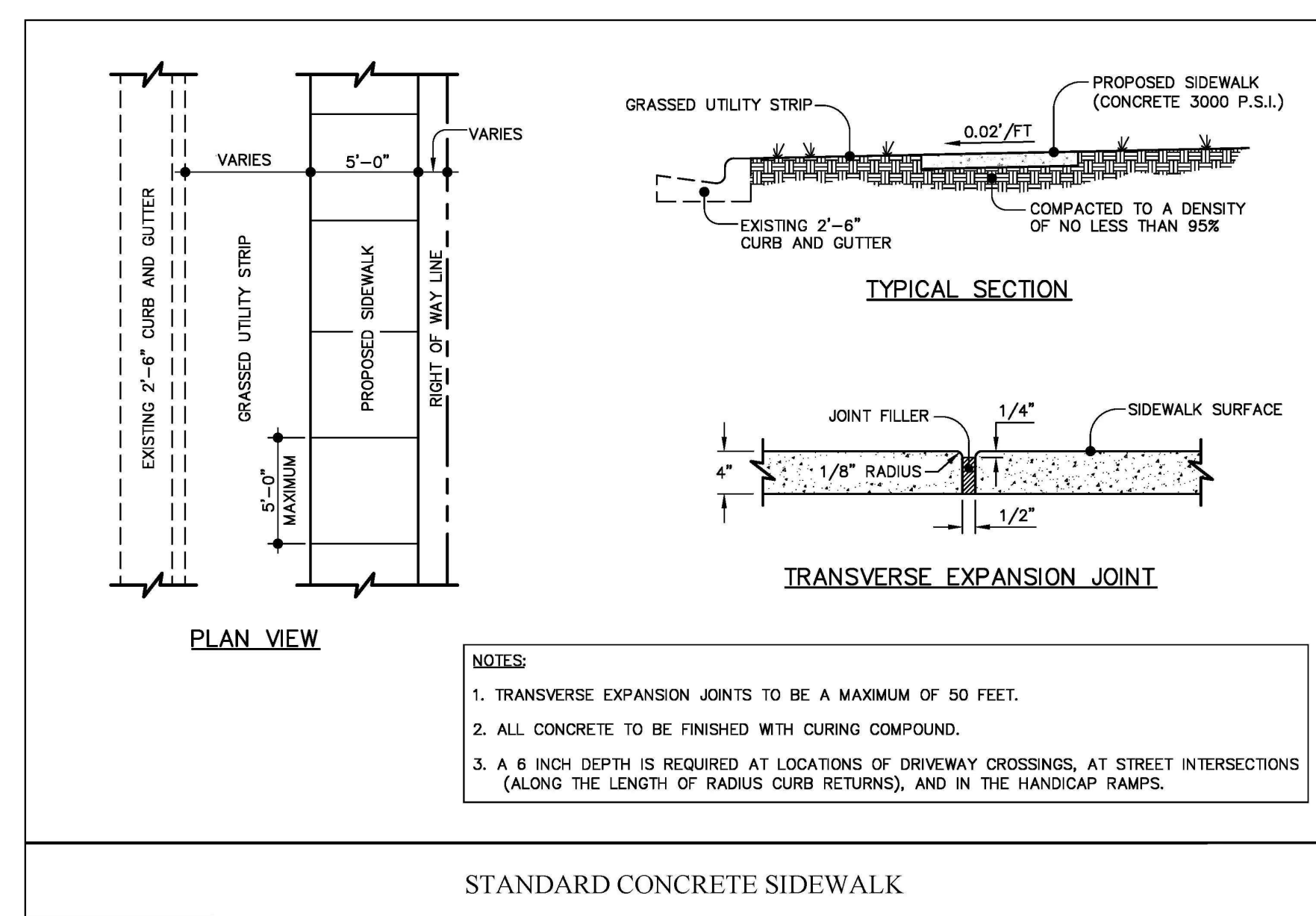

N:\Projects\AWH\AWH-20000\04 Production\Engineering\The Point North\Current Drawings\SideWalk-D1.dwg, 8/30/2023 10:50:40 AM, Sherill Williams