

CHIPOTLE AT WALLBROOK

SITE DEVELOPMENT PLAN - SDP 25-03

US-401 BUS / S. Main Street ~ Wake Forest Township ~ Town of Rolesville ~ Wake County ~ North Carolina

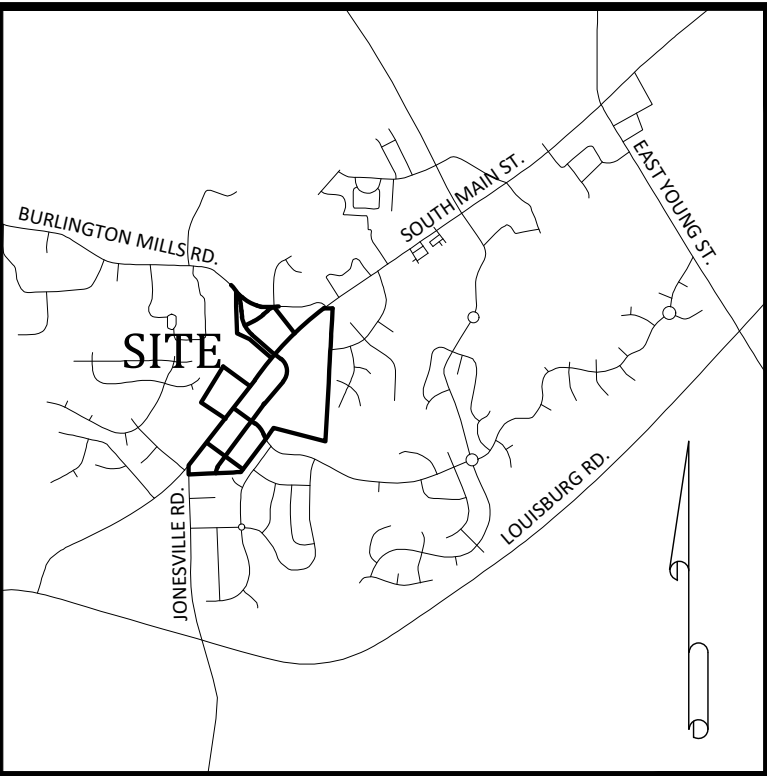

Vicinity Map

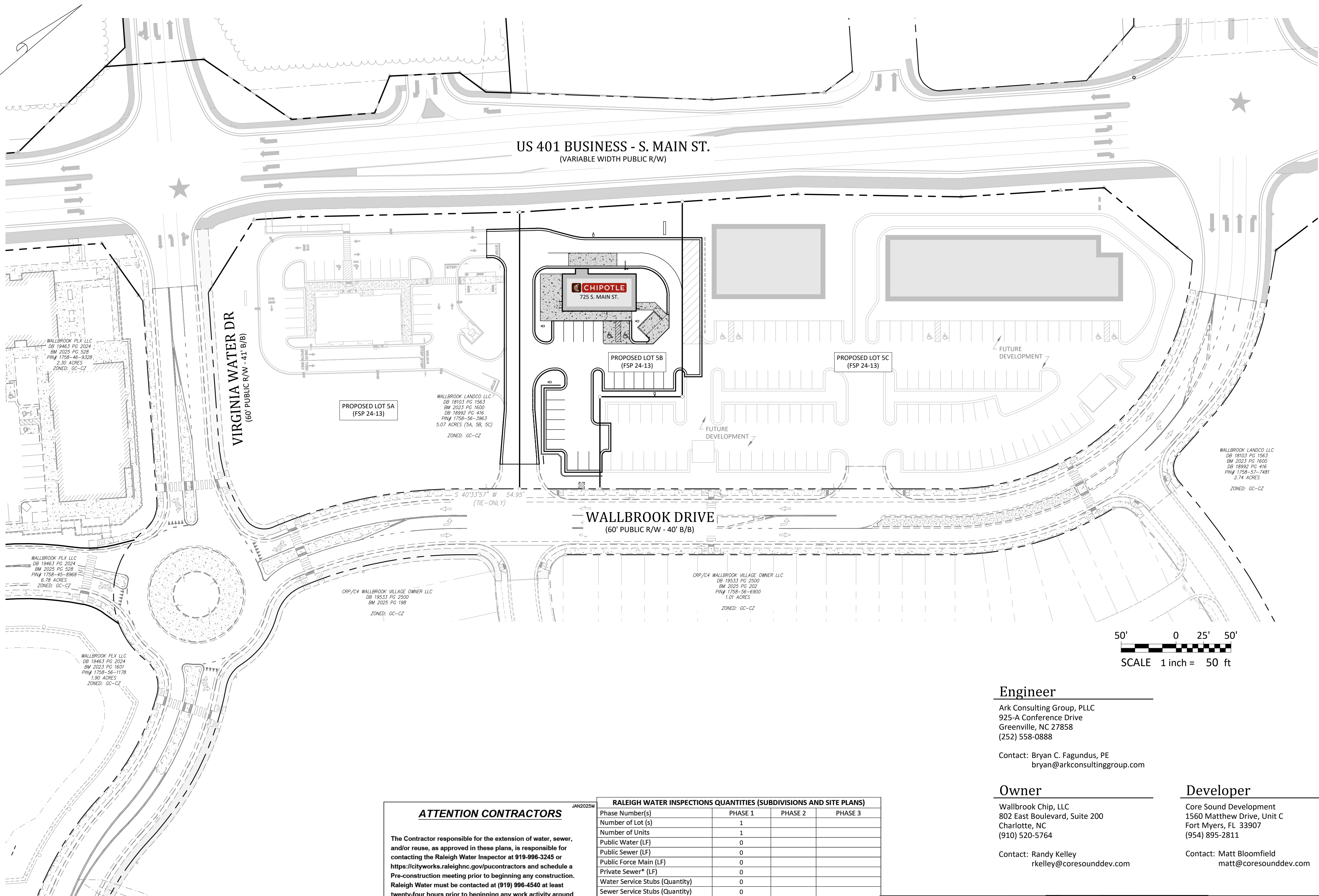

Site Data

| | |
|---|---|
| WAKE COUNTY PIN: | 1758-56-3963 |
| REAL ESTATE ID: | 509435 |
| CURRENT ZONING: | GC-CZ |
| TOTAL ACREAGE IN SITE: | 0.73 AC (LOT 5B) |
| TOTAL ACREAGE IN PROJECT LIMITS: | 0.95 AC |
| DISTURBED ACREAGE: | 0.95 AC |
| WATERSHED: | Lower Neuse |
| RIVER BASIN: | Neuse |
| CURRENT USE: | VACANT / WOODED |
| PROPOSED USE: | NON-RESIDENTIAL / RESTAURANT |
| REQUIRED BUILDING SETBACKS: | 35' (REAR), 25' (CORNER), 20' (FRONT), 15' (SIDE) |
| BUILDING FLOOR AREA: | 2,333 SF |
| BUILDING LOT COVERAGE: | 0% EXIST., 7.35% PROPOSED |
| BUILDING HEIGHT: | 20'-8" (1 STORY) |
| TOTAL NUMBER OF PARKING SPACES REQUIRED: | 8 SPACES (INCL. 1 H/C) |
| TOTAL NUMBER OF PROPOSED PARKING SPACES: | 23 SPACES (INCL. 2 H/C) |
| TOTAL SQ. FEET OF EXIST. IMPERVIOUS AREA: | 0 SF |
| TOTAL SQ. FEET OF PROP. IMPERVIOUS AREA: | 23,024 SF (72.53% - LOT 5B) |
| DEVELOPMENT STANDARDS: | LDO |
| REFERENCES: | DB 18103, PG 1563 BM 2023, PG 1602 |
| ADDRESS: | 725 S. MAIN STREET |

Parking Requirements:

| | |
|----------------------------|---|
| PARKING REQUIRED: | EATING ESTABLISHMENT (OUTDOOR SEATING SHALL BE INCLUDED IN SQUARE FOOTAGE) |
| MINIMUM: | 2.5 / 1000 SF = 3010 / 1000 * 2.5 |
| MAXIMUM: | 10 / 1000 SF = 3010 / 1000 * 7.5 |
| TOTAL REQUIRED PARKING: | 8 SPACES |
| REQUIRED HANDICAP PARKING: | 1 SPACE |
| PARKING PROVIDED: | 23 SPACES (INCL. 2 H/C) |

Sheet Index

| # | Title |
|------|---------------------------------------|
| C0.1 | Cover |
| C0.2 | Existing Conditions & Demolition Plan |
| C1.0 | Erosion Control - Notes |
| C1.1 | Erosion Control - Ph. 1 |
| C1.2 | Erosion Control - Ph. 2 |
| C1.3 | Erosion Control - Details |
| C2.0 | Site Plan |
| C3.0 | Utility Plan |
| C4.0 | Grading & Drainage Plan |
| C5.0 | Required Vegetation Plan |
| C6.1 | Misc. Details |
| C6.2 | Misc. Details |
| C6.3 | Misc. Details |



ATTENTION CONTRACTORS

The Contractor responsible for the extension of water, sewer, and/or reuse, as approved in these plans, is responsible for contacting the Raleigh Water Inspector at 919-998-3245 or <https://cityworks.raleighnc.gov/pucontractors> and schedule a Pre-construction meeting prior to beginning any construction. Raleigh Water must be contacted at (919) 998-4540 at least twenty-four hours prior to beginning any work activity around critical water and sewer infrastructure.

Failure to notify City Departments in advance of beginning construction, will result in the issuance of monetary fines, and require re-installation of any water or sewer facilities not inspected as a result of this notification failure.

Failure to call for inspection, install a downstream plug, have permitted plans on the jobsite, or any other violation of Raleigh Water Standards will result in a fine and possible exclusion from future work in the City of Raleigh.

| RALEIGH WATER INSPECTIONS QUANTITIES (SUBDIVISIONS AND SITE PLANS) | | | | |
|---|---------|---------|---------|--|
| Phase Number(s) | PHASE 1 | PHASE 2 | PHASE 3 | |
| Number of Lot (s) | 1 | | | |
| Number of Units | 1 | | | |
| Public Water (LF) | 0 | | | |
| Public Sewer (LF) | 0 | | | |
| Public Force Main (LF) | 0 | | | |
| Private Sewer* (LF) | 0 | | | |
| Water Service Stubs (Quantity) | 0 | | | |
| Sewer Service Stubs (Quantity) | 0 | | | |
| Average Daily Flow per phase** | --- | | | |
| COMMERCIAL PROJECTS WITH SINGLE WATER AND SEWER SERVICE | | | | |
| Domestic Meter Size | 1 1/2" | | | |
| Irrigation Meter Size | 3/4" | | | |
| Average Daily Flow per phase** | GPD | | | |
| *Sewer mains and manholes as part of a collection system | | | | |
| **Entire Project Flow. Based on 75gpd per bedroom for residential (Apartments, single Family dwelling, townhouse, condos), or based on 15A NCAC 02T .0114 Wastewater Design Flow Rates for Commercial and Industrial. | | | | |
| The meter size must match domestic service size (Exemption - 3/4" service tap with 5/8" meter) | | | | |

RALEIGH WATER

EROSION CONTROL, STORMWATER AND FLOODPLAIN MANAGEMENT
APPROVED
EROSION CONTROL ☐ S-
STORMWATER MGMT. ☐ S-
FLOOD STUDY ☐ S-
DATE _____
ENVIRONMENTAL CONSULTANT SIGNATURE _____

Town of Rolesville Development Applications

| | |
|--------------|--|
| SUP 20-02 | SPECIAL USE PERMIT |
| ANX 21-06 | ANNEXATION |
| PR 21-04 REV | PRELIMINARY SUBDIVISION PLAT (REVISED) |
| FSP 23-09 | INTERMEDIATE SUBDIVISION PLAT |
| PSP 24-01 | LOT 5 PRELIMINARY SUBDIVISION PLAT |
| FSP 24-13 | LOT 5 FINAL SUBDIVISION PLAT |
| SDP 25-03 | LOT 5B SITE DEVELOPMENT PLAN (CURRENT APPLICATION) |



| | |
|------------------|--------|
| Project Manager: | BCF |
| Drawn By: | DLG |
| Checked By: | BCF |
| Project Number: | 24138 |
| Drawing Number: | D-1592 |

C0.1

Date: July 1, 2025

CHIPOTLE AT WALLBROOK (LOT 5B)

Town of Rolesville Project No. SDP 25-03

Wake Forest Township, Town of Rolesville, Wake County, North Carolina

COVER



PRELIMINARY
Do Not Use
for Construction
7/1/2025



REVISIONS:

| # | DATE | DESCRIPTION |
|---|----------|--------------------------|
| 1 | 1-JUL-25 | SUBMIT FOR PERMIT REVIEW |

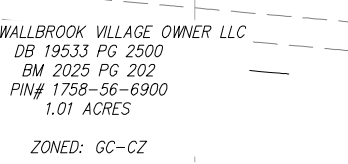

- Date: July 1, 2025

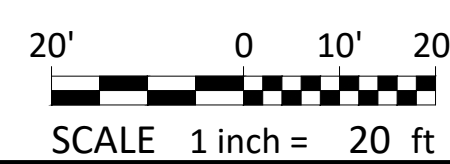
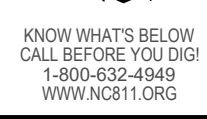

GROUND STABILIZATION AND MATERIALS HANDLING PRACTICES FOR COMPLIANCE WITH THE NCG01 CONSTRUCTION GENERAL PERMIT

Implementing the details and specifications on this plan sheet will result in the construction activity being considered compliant with the Ground Stabilization and Materials Handling sections of the NCG01 Construction General Permit (Sections E and F, respectively). The permittee shall comply with the Erosion and Sediment Control plan approved by the delegated authority having jurisdiction. All details and specifications shown on this sheet may not apply depending on site conditions and the delegated authority having jurisdiction.

SECTION E: GROUND STABILIZATION

| Required Ground Stabilization Timeframes | | |
|--|---|--|
| Site Area Description | Stabilize within this many calendar days after ceasing land disturbance | Timeframe variations |
| (a) Perimeter dikes, swales, ditches, and perimeter slopes | 7 | None |
| (b) High Quality Water (HQW) Zones | 7 | None |
| (c) Slopes steeper than 3:1 | 7 | If slopes are 10' or less in length and are not steeper than 2:1, 14 days are allowed |
| (d) Slopes 3:1 to 4:1 | 14 | - 7 days for slopes greater than 50' in length and with slopes steeper than 4:1 - 7 days for perimeter dikes, swales, ditches, perimeter slopes and HQW Zones - 10 days for Falls Lake Watershed |
| (e) Areas with slopes flatter than 4:1 | 14 | - 7 days for perimeter dikes, swales, ditches, perimeter slopes and HQW Zones - 10 days for Falls Lake Watershed unless there is zero slope |

Note: After the permanent cessation of construction activities, any areas with temporary ground stabilization shall be converted to permanent ground stabilization as soon as practicable but in no case longer than 90 calendar days after the last land disturbing activity. Temporary ground stabilization shall be maintained in a manner to render the surface stable against accelerated erosion until permanent ground stabilization is achieved.

GROUND STABILIZATION SPECIFICATION

Stabilize the ground sufficiently so that rain will not dislodge the soil. Use one of the techniques in the table below:

| Temporary Stabilization | Permanent Stabilization |
|---|--|
| <ul style="list-style-type: none">Temporary grass seed covered with straw or other mulches and tackifiersHydroseedingRoller erosion control products with or without temporary grass seedAppropriately applied straw or other mulchplastic sheeting | <ul style="list-style-type: none">Permanent grass seed covered with straw or other mulches and tackifiersGeotextile fabrics such as permanent soil reinforcement mattingHydroseedingShrubs or other permanent plantings covered with mulchUniform and evenlyh distributed ground cover sufficient to restrain erosionStructural methods such as concrete, asphalt, or retaining wallsRoller erosion control products with grass seed |

POLYACRYLAMIDES (PAMS) AND FLOCCULANTS

- Select flocculants that are appropriate for the soils being exposed during construction, selecting from the *NC DWR List of Approved PAMS/Flocculants*.
- Apply flocculants at or before the inlets to Erosion and Sediment Control Measures.
- Apply flocculants at the concentrations specified in the *NC DWR List of Approved PAMS/Flocculants* and in accordance with the manufacturer's instructions.
- Provide ponding area for containment of treated Stormwater before discharging offsite.
- Store flocculants in leak-proof containers that are kept under storm-resistant cover or surrounded by secondary containment structures.

EQUIPMENT AND VEHICLE MAINTENANCE

- Maintain vehicles and equipment to prevent discharge of fluids.
- Provide drip pans under any stored equipment.
- Identify leaks and repair as soon as feasible, or remove leaking equipment from the project.
- Collect all spent fluids, store in separate containers and properly dispose as hazardous waste (recycle when possible).
- Remove leaking vehicles and construction equipment from service until the problem has been corrected.
- Bring used fuels, lubricants, coolants, hydraulic fluids and other petroleum products to a recycling or disposal center that handles these materials.

LITTER, BUILDING MATERIAL AND LAND CLEARING WASTE

- Never bury or burn waste. Place litter and debris in approved waste containers.
- Provide a sufficient number and size of waste containers (e.g dumpster, trash receptacle) on site to contain construction and domestic wastes.
- Locate waste containers at least 50 feet away from storm drain inlets and surface waters unless no other alternatives are reasonably available.
- Locate waste containers on areas that do not receive substantial amounts of runoff from upland areas and does not drain directly to a storm drain, stream or wetland.
- Cover waste containers at the end of each workday and before storm events or provide secondary containment. Repair or replace damaged waste containers.
- Anchor all lightweight items in waste containers during times of high winds.
- Empty waste containers as needed to prevent overflow. Clean up immediately if containers overflow.
- Dispose waste off-site at an approved disposal facility.
- On business days, clean up and dispose of waste in designated waste containers.

PAINT AND OTHER LIQUID WASTE

- Do not dump paint and other liquid waste into storm drains, streams or wetlands.
- Locate paint washouts at least 50 feet away from storm drain inlets and surface waters unless no other alternatives are reasonably available.
- Contain liquid wastes in a controlled area.
- Containment must be labeled, sized and placed appropriately for the needs of site.
- Prevent the discharge of soaps, solvents, detergents and other liquid wastes from construction sites.

PORTABLE TOILETS

- Install portable toilets on level ground, at least 50 feet away from storm drains, streams or wetlands unless there is no alternative reasonably available. If 50 foot offset is not attainable, provide relocation of portable toilet behind silt fence or place on a gravel pad and surround with sand bags.
- Provide staking or anchoring of portable toilets during periods of high winds or in high foot traffic areas.
- Monitor portable toilets for leaking and properly dispose of any leaked material. Utilize a licensed sanitary waste hauler to remove leaking portable toilets and replace with properly operating unit.

EARTHEN STOCKPILE MAINTENANCE

- Show stockpile locations on plans. Locate earthen-material stockpile areas at least 50 feet away from storm drain inlets, sediment basins, perimeter sediment controls and surface waters unless it can be shown no other alternatives are reasonably available.
- Protect stockpile with silt fence installed along toe of slope with a minimum offset of five feet from the toe of stockpile.
- Provide stable stone access point when feasible.
- Stabilize stockpile within the timeframes provided on this sheet and in accordance with the approved plan and any additional requirements. Soil stabilization is defined as vegetative, physical or chemical coverage techniques that will restrain accelerated erosion on disturbed soils for temporary or permanent control needs.

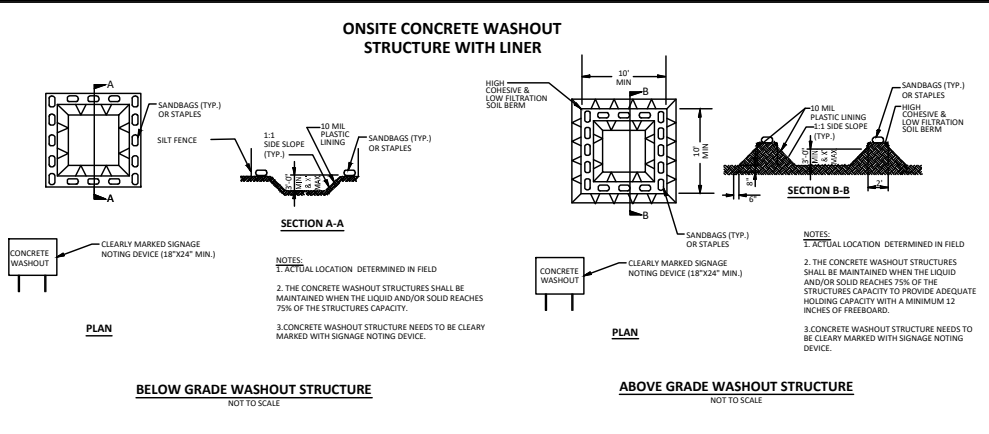

CONCRETE WASHOUTS

- Do not discharge concrete or cement slurry from the site.
- Dispose of, or recycle settled, hardened concrete residue in accordance with local and state solid waste regulations and at an approved facility.
- Manage washout from mortar mixers in accordance with the above item and in addition place the mixer and associated materials on impervious barrier and within lot perimeter silt fence.
- Install temporary concrete washouts per local requirements, where applicable. If an alternate method or product is to be used, contact your approval authority for review and approval. If local standard details are not available, use one of the two types of temporary concrete washouts provided on this detail.
- Do not use concrete washouts for dewatering or storing defective curb or sidewalk sections. Stormwater accumulated within the washout may not be pumped into or discharged to the storm drain system or receiving surface waters. Liquid waste must be pumped out and removed from project.
- Locate washouts at least 50 feet from storm drain inlets and surface waters unless it can be shown that no other alternatives are reasonably available. At a minimum, install protection of storm drain inlet(s) closest to the washout which could receive spills or overflow.
- Locate washouts in an easily accessible area, on level ground and install a stone entrance pad in front of the washout. Additional controls may be required by the approving authority.
- Install at least one sign directing concrete trucks to the washout within the project limits. Post signage on the washout itself to identify this location.
- Remove leavings from the washout when at approximately 75% capacity to limit overflow events. Replace the tarp, sand bags or other temporary structural components when no longer functional. When utilizing alternative or proprietary products, follow manufacturer's instructions.
- At the completion of the concrete work, remove remaining leavings and dispose of in an approved disposal facility. Fill pit, if applicable, and stabilize any disturbance caused by removal of washout.

HERBICIDES, PESTICIDES AND RODENTICIDES

- Store and apply herbicides, pesticides and rodenticides in accordance with label restrictions.
- Store herbicides, pesticides and rodenticides in their original containers with the label, which lists directions for use, ingredients and first aid steps in case of accidental poisoning.
- Do not store herbicides, pesticides and rodenticides in areas where flooding is possible or where they may spill or leak into wells, stormwater drains, ground water or surface water. If a spill occurs, clean area immediately.
- Do not stockpile these materials onsite.

HAZARDOUS AND TOXIC WASTE

- Create designated hazardous waste collection areas on-site.
- Place hazardous waste containers under cover or in secondary containment.
- Do not store hazardous chemicals, drums or bagged materials directly on the ground.

Wake County Basin Removal Sequence:

- SCHEDULE A SITE MEETING WITH THE ENVIRONMENTAL CONSULTANT TO DETERMINE IF A BASIN CAN BE REMOVED. INSTALL SILT FENCING OR OTHER TEMPORARY EROSION CONTROL MEASURES AS NEEDED PRIOR TO REMOVAL OF THE BASIN.
- CONTACT NCDEQ - RALEIGH REGIONAL OFFICE (919) 791-4200 TO DETERMINE THE DIVISION OF ENERGY, MINERAL AND LAND RESOURCES CONTACT PERSON TO RECEIVE DEWATERING NOTIFICATIONS. AT LEAST 10 DAYS PRIOR TO BEGINNING DEWATERING ACTIVITY, SEND EMAIL TO NCDEQ-DEMLR CONTACT PERSON AND COPY ENVIRONMENTAL CONSULTANT THAT MET YOU ONSITE. THE EMAIL SHOULD INCLUDE: E&S JURISDICTION: WAKE COUNTY, WAKE COUNTY PROJECT: NAME, NUMBER, AND LOCATION (CITY/TOWN), ENVIRONMENTAL CONSULTANT NAME, AND ADDRESS THE FOLLOWING: A) REASON FOR CONVERSION, B) BASIN #, C) DEWATERING METHOD, AND D) ALL OTHER NECESSARY INFO FROM PART II, SECTION G, ITEM 4 OF THE NCG01. KEEP EMAIL FOR YOUR NPDES MONITORING DOCUMENTATION
- AFTER RECEIVING POSITIVE CONFIRMATION FROM NCDEQ-DEMLR THAT YOU MAY REMOVE THE BASIN OR ON > DAY 11, WHICHEVER IS SOONER, REMOVE BASIN(S) AND ASSOCIATED TEMPORARY DIVERSION DITCHES. IF PIPES NEED TO BE EXTENDED, PERFORM THIS OPERATION AT THIS TIME. FINE GRADE AREA IN PREPARATION FOR SEEDING.
- PERFORM SEEDBED PREPARATION, SEED, MULCH AND ANCHOR ANY RESULTING BARE AREAS IMMEDIATELY.
- INSTALL VELOCITY DISSIPATORS AND/OR LEVEL SPREADERS AS REQUIRED ON THE EROSION CONTROL PLAN.
- WHEN SITE IS FULLY STABILIZED, CALL ENVIRONMENTAL CONSULTANT FOR APPROVAL OF REMOVING REMAINING TEMPORARY EROSION CONTROL MEASURES AND ADVISE ON WHEN SITE CAN BE ISSUED A CERTIFICATE OF COMPLETION. NOTE: A MEETING SHOULD ALSO BE SCHEDULED WITH THE ENVIRONMENTAL CONSULTANT TO DETERMINE WHEN A BASIN MAY BE CONVERTED FOR STORMWATER USE. SOME MUNICIPALITIES MAY ALSO REQUIRE THIS.

Erosion Control Provisions:

- NO PERSON MAY INITIATE A LAND DISTURBING ACTIVITY BEFORE NOTIFYING WAKE COUNTY WATERSHED MANAGEMENT OF THE DATE THAT THE LAND DISTURBING ACTIVITY WILL BEGIN.
- LAND DISTURBING ACTIVITY BEYOND THAT REQUIRED TO INSTALL APPROPRIATE EROSION CONTROL MAY NOT PROCEED UNTIL EROSION CONTROL MEASURES ARE INSPECTED AND APPROVED BY THE ENGINEER.
- SCHEDULING OF A PRE-CONSTRUCTION CONFERENCE WITH THE WAKE COUNTY WATERSHED MANAGER, JEEVAN NEUPANE, PE (919-819-8907) PRIOR TO INITIATING LAND DISTURBING ACTIVITIES IS REQUIRED. FOR INSPECTION CALL 919-819-8907. 48 HOUR NOTICE IS REQUIRED.
- INSTALL TREE PROTECTION FENCING AROUND ALL AREAS OUTSIDE OF THE LIMITS OF DISTURBANCE AS SHOWN ON PLANS.
- PROVIDE 20' X 50' X 6" STONE CONSTRUCTION ENTRANCES AS SHOWN ON PLAN.
- SEED OR OTHERWISE PROVIDE GROUND COVER DEVICES OR STRUCTURES SUFFICIENT TO RESTRAIN EROSION FOR ALL EXPOSED SLOPES WITHIN 7 DAYS OF CONITION. OF ANY PHASE OF GRADING ON PERIMETER AREAS AND SLOPES STEEPER THAN 3:1. ALL OTHER AREAS SHALL BE STABILIZED WITHIN 14 DAYS.
- CONTRACTOR SHALL INSPECT AND MAINTAIN AS NEEDED ALL EROSION CONTROL DEVICES ON A WEEKLY BASIS AND AFTER EACH MAJOR STORM EVENT. FAILURE TO KEEP ALL EROSION CONTROL DEVICES IN PROPER WORKING ORDER MAY RESULT IN A STOP WORK ORDER OR CIVIL PENALTIES UP TO \$5000.00 PER DAY OF VIOLATION.
- THE ENGINEER RESERVES THE RIGHT TO REQUIRE ADDITIONAL EROSION CONTROL MEASURES SHOULD THE PLAN OR ITS IMPLEMENTATION PROVE TO BE INADEQUATE.
- ACCEPTANCE AND APPROVAL OF THIS PLAN IS CONDITIONED UPON YOUR COMPLIANCE WITH FEDERAL AND STATE WATER QUALITY LAWS, REGULATION AND RULES. IN ADDITION LOCAL CITY AND COUNTY ORDINANCES OR RULES MAY ALSO APPLY TO THIS LAND DISTURBING ACTIVITY. APPROVAL BY THE COUNTY DOES NOT SUPERSEDE ANY OTHER PERMIT OR APPROVAL.
- PLEASE BE ADVISED OF THE RULES TO PROTECT AND MAINTAIN EXISTING BUFFERS ALONG WATERCOURSES IN THE NEUSE AND RIVER BASIN. THESE RULES ARE ENFORCED BY THE DIVISION OF WATER RESOURCES (DWR). DIRECT ANY QUESTIONS ABOUT THE APPLICABILITY OF THESE RULES TO YOUR PROJECT TO THE REGIONAL WATER QUALITY SUPERVISOR, RALEIGH REGIONAL OFFICE AT (919) 791-4200.
- ALL AREAS DOWNSTREAM OF TEMPORARY BASINS AND DITCHES ARE TO BE STABILIZED IMMEDIATELY UPON CONSTRUCTION.

Construction Sequence:

- EROSION AND SEDIMENT CONTROL (E&S) PERMIT AND A CERTIFICATE OF COVERAGE (COC) MUST BE OBTAINED BEFORE ANY LAND DISTURBING ACTIVITIES OCCUR.
- CALL WAKE COUNTY WATERSHED MANAGER JEEVAN NEUPANE AT (919) 819-8907 A MINIMUM OF 48 HOURS IN ADVANCE TO SCHEDULE A PRE-CONSTRUCTION MEETING AND FOR NOTIFICATION OF PROJECT START UP.
- ANY DEWATERING ON THE SITE SHALL BE DONE THROUGH A SILT BAG THAT IS CONSTANTLY MONITORED.
- INSTALL GRAVEL CONSTRUCTION PAD, SILT FENCE, SEDIMENT BASINS OR OTHER MEASURES AS SHOWN ON THE APPROVED PLAN. CLEAR ONLY AS NECESSARY TO INSTALL THESE DEVICES. SEED TEMPORARY DIVERSIONS, BERMS AND BASINS IMMEDIATELY AFTER CONSTRUCTION.
- CALL WATERSHED MANAGER, JEEVAN NEUPANE FOR AN ONSITE INSPECTION TO OBTAIN A CERTIFICATE OF COMPLIANCE.
- CLEAR AND GRUB EXISTING VEGETATION AS SHOWN ON THE DEMOLITION PLAN. REMOVE EXISTING STRUCTURES AND UTILITIES AS SHOWN ON THE DEMOLITION PLAN. BEGIN GRADING. MAINTAIN DEVICES AS NEEDED. ROUGH GRADE SITE. INSTALL TEMPORARY SKIMMER SEDIMENT BASINS, ALONG WITH TEMPORARY DIVERSION DITCHES THAT SHALL BE INSTALLED TO ENSURE AS MUCH FLOW AS POSSIBLE IS DIRECTED TO THE BASINS.
- SEDIMENT BASIN FOR PERMANENT USE AS WET POND SHALL BE REMOVED AS FOLLOWS: DEWATER (THROUGH SILT BAG), CLEAN SEDIMENT, AND REMOVE BAFFLES. RE-SHAPE THE BASIN AS REQUIRED BY THE DESIGN DRAWINGS, INCLUDING EXCAVATION/SHAPING OF THE FOREBAY. SEED AND STABILIZE BASIN SLOPES. DEWATERING OPERATIONS THROUGH SILT BAGS SHALL BE MONITORED CONTINUOUSLY.
- STABILIZE SITE AS AREAS ARE BROUGHT UP TO FINISH GRADE WITH VEGETATION, DITCH LININGS, ETC. SEED AND MULCH DENUDED AREAS PER GROUND STABILIZATION TIME FRAME.
- INSTALLATION OF UNDERGROUND UTILITIES AND STONE BASE FOR ROADWAYS.
- INSTALLATION OF CONCRETE CURB & GUTTER, CONCRETE SIDEWALK, & ASPHALT PAVEMENT.
- WHEN GRADING IS COMPLETE AND ALL AREAS ARE STABILIZED COMPLETELY, CALL WATERSHED MANAGER JEEVAN NEUPANE FOR INSPECTION.
- IF SITE IS APPROVED, MAINTAIN TEMPORARY DIVERSIONS, SILT FENCE, SEDIMENT BASINS, ETC., AND SEED OR STABILIZE ANY RESULTING BARE AREAS. ALL REMAINING PERMANENT EROSION CONTROL DEVICES, SUCH AS VELOCITY DISSIPATORS, SHOULD NOW BE INSTALLED.
- WHEN VEGETATION HAS BECOME ESTABLISHED, CALL FOR FINAL SITE INSPECTION BY THE WATERSHED MANAGER, JEEVAN NEUPANE. OBTAIN CERTIFICATE OF COMPLETION.

**PART III
SELF-INSPECTION, RECORDKEEPING AND REPORTING**

SECTION A: SELF-INSPECTION

Self-inspections are required during normal business hours in accordance with the table below. When adverse weather or site conditions would cause the safety of the inspection personnel to be in jeopardy, the inspection may be delayed until the next business day on which it is safe to perform the inspection. In addition, when a storm event of equal to or greater than 1.0 inch occurs outside of normal business hours, the self-inspection shall be performed upon the commencement of the next business day. Any time when inspections were delayed shall be noted in the Inspection Record.

| Inspect | Frequency (during normal business hours) | Inspection records must include: |
|--|---|--|
| (1) Rain gauge maintained in good working order | Daily | Daily rainfall amounts. If no daily rain gauge observations are made during weekend or holiday periods, and no individual day rainfall information is available, record the cumulative rain measurement for those unattended days (and this will determine if a site inspection is needed). Days on which no rainfall occurred shall be recorded as "zero". The permittee may use another rain-monitoring device approved by the Division. |
| (2) E&S Measures | At least once per 7 calendar days and within 24 hours of a rain event ≥ 1.0 inch in 24 hours | 1. Identification of the measures inspected. 2. Date and time of the inspection. 3. Name of the person performing the inspection. 4. Indication of whether the measures were operating properly. 5. Description of maintenance needs for the measures. 6. Description, evidence, and date of corrective actions taken. |
| (3) Stormwater discharge outfalls (SDOs) | At least once per 7 calendar days and within 24 hours of a rain event ≥ 1.0 inch in 24 hours | 1. Identification of the discharge outfalls inspected. 2. Date and time of the inspection. 3. Name of the person performing the inspection. 4. Evidence of indicators of stormwater pollution such as oil sheen, floating or suspended solids or discoloration. 5. Indication of visible sediment leaving the site. 6. Description, evidence, and date of corrective actions taken. |
| (4) Perimeter of site | At least once per 7 calendar days and within 24 hours of a rain event ≥ 1.0 inch in 24 hours | 1. Visible sedimentation is found outside site limits, then a record of the following shall be made: 1. Actions taken to clean up or stabilize the sediment that has left the site limits. 2. Description, evidence, and date of corrective actions taken, and 3. An explanation as to the actions taken to control future releases. |
| (5) Streams or wetlands onsite or offsite (where accessible) | At least once per 7 calendar days and within 24 hours of a rain event ≥ 1.0 inch in 24 hours | 1. If the stream or wetland has increased visible sedimentation or a stream has visible increased turbidity from the construction activity, then a record of the following shall be made: 1. Description, evidence and date of corrective actions taken, and 2. Records of the required reports to the appropriate Division Regional Office per Part II, Section C, Item (2)(a) of this permit. |
| (6) Ground stabilization measures | After each phase of grading | 1. The phase of grading (installation of perimeter E&S measures, clearing and grubbing, installation of storm drainage facilities, completion of all land-disturbing activity, construction or redevelopment, permanent ground cover). 2. Documentation that the required ground stabilization measures have been provided within the required timeframe or an assurance that they will be provided as soon as possible. |

NOTE: The rain inspection resets the required 7 calendar day inspection requirement.

**PART II, SECTION G, ITEM (4)
DRAW DOWN OF SEDIMENT BASINS FOR MAINTENANCE OR CLOSE OUT**

Sediment basins and traps that receive runoff from drainage areas of one acre or more shall use outlet structure that withdraw water from the surface when these devices need to be drawn down for maintenance or close out unless this is infeasible. The circumstances in which it is not feasible to withdraw water from the surface shall be rare (for example, times with extended cold weather). Non-surface withdrawals from sediment basins shall be allowed only when all of the following criteria have been met:

- The E&S plan authority has been provided with documentation of the non-surface withdrawal and the specific time periods or conditions in which it will occur. The non-surface withdrawal shall not commence until the E&S plan authority has approved these items.
- The non-surface withdrawal has been reported as an anticipated bypass in accordance with Part III, Section C, Item (2)(c) and (d) of this permit.
- Dewatering discharges are treated with controls to minimize discharges of pollutants from stormwater that is removed from the sediment basin. Examples of appropriate controls include properly sited, designed and maintained dewatering tanks, weir tanks, and filtration systems.
- Vegetated, upland areas of the sites are a properly designed stone pad is used to the extent feasible at the outlet of the dewatering treatment devices described in item (c) above.
- Velocity dissipation devices such as check dams, sediment traps, and riprap are provided at the discharge points of all dewatering devices, and
- Sediment removed from the dewatering treatment devices described in item (c) above is disposed of in a manner that does not cause deposition of sediment into water of the United States.

**PART III
SELF-INSPECTION, RECORDKEEPING AND REPORTING**

SECTION B: RECORDKEEPING

- E&S Plan Documentation**
The approved E&S plan as well as any approved deviation shall be kept on the site. The approved E&S plan must be kept up-to-date throughout the coverage under this permit. The following items pertaining to the E&S plan shall be kept on site and available for inspection at all times during normal business hours:
 - Each E&S Measure has been installed and does not significantly deviate from the locations, dimensions and relative elevations shown on the approved E&S Plan.
 - A phase of grading has been completed.
 - Ground cover is located and installed in accordance with the approved E&S Plan.
 - The maintenance and repair requirements for all E&S Measures have been performed.
 - Corrective actions have been taken to E&S measures.

| Item to Document | Documentation Requirements |
|---|---|
| (a) Each E&S Measure has been installed and does not significantly deviate from the locations, dimensions and relative elevations shown on the approved E&S Plan. | Initial and date each E&S Measure on a copy of the approved E&S Plan or complete, date and sign an inspection report that lists each E&S measure shown on the approved E&S Plan. This documentation is required upon the initial installation of the E&S measures or if the E&S measures are modified after initial installation. |
| (b) A phase of grading has been completed. | Initial and date a copy of the approved E&S plan or complete, date and sign an inspection report to indicate completion of the construction phase. |
| (c) Ground cover is located and installed in accordance with the approved E&S Plan. | Initial and date a copy of the approved E&S plan or complete, date and sign an inspection report to indicate compliance with approved ground cover specifications. |
| (d) The maintenance and repair requirements for all E&S Measures have been performed. | Complete, date and sign an inspection report. |
| (e) Corrective actions have been taken to E&S measures. | Initial and date a copy of the approved E&S Plan or complete, date and sign an inspection report to indicate the completion of the corrective action. |

- Additional Documentation**
In addition to the E&S plan documents above, the following items shall be kept on the site and available for inspectors at all times during normal business hours, unless the Division provides a site-specific exemption based on unique site conditions that make this requirement not practical:
 - This General Permit as well as the Certificate of Coverage, after it is received.

- Records of inspections made during the previous twelve months. The permittee shall record the required observations on the Inspection Record Form provided by the Division or a similar inspection form that includes all the required elements. Use of electronically-available records in lieu of the required paper copies will be allowed if shown to provide equal access and utility as the hard-copy records.

- Documentation to be Retained for Three Years
All data used to complete the e-NIO and all inspection records shall be maintained for a period of three years after project completion and made available upon request. [40 CFR 122.41]

**PART III
SELF-INSPECTION, RECORDKEEPING AND REPORTING**

SECTION C: REPORTING

1. Occurrences that Must be Reported

Permittees shall report the following occurrences:

- Visible sediment deposition in a stream or wetland.
- Oil spills if:
 - They are 25 gallons or more,
 - They are less than 25 gallons but cannot be cleaned up within 24 hours,
 - They cause sheen on surface waters (regardless of volume), or
 - They are within 100 feet of surface waters (regardless of volume).

- Releases of hazardous substances in excess of reportable quantities under Section 311 of the Clean Water Act (Ref: 40 CFR 110.3 and 40 CFR 117.3) or Section 102 of CERCLA (Ref: 40 CFR 302.4) or G.S. 143-215.85.

- Anticipated bypasses and unanticipated bypasses.

- Noncompliance with the conditions of this permit that may endanger health or the environment.

2. Reporting Timesframes and Other Requirements

After a permittee becomes aware of an occurrence that must be reported, he shall contact the appropriate Division regional office within the timeframes and in accordance with the other requirements listed below. Occurrences outside normal business hours may also be reported to the Department's Environmental Emergency Center personnel at (800) 858-0368.

| Occurrence | Reporting Timeframes (After Discovery) and Other Requirements |
|--|--|
| (a) Visible sediment deposition in a stream or wetland | <ul style="list-style-type: none">Within 24 hours, an oral or electronic notification.Within 7 calendar days, a report that contains a description of the sediment and actions taken to address the cause of the deposition. Division staff may waive the requirement for a written report on a case-by-case basis.If the stream is named on the NC 303(d) list as impaired for sediment-related causes, the permittee may be required to perform additional monitoring, inspections or apply more stringent practices if staff determine that additional requirements are needed to assure compliance with the federal or state impaired-waters conditions. |
| (b) Oil spills and release of hazardous substances per item 1(b)(i) above | <ul style="list-style-type: none">Within 24 hours, an oral or electronic notification. The notification shall include information about the date, time, nature, volume and location of the spill or release. |
| (c) Anticipated bypasses [40 CFR 122.41(m)(3)] | <ul style="list-style-type: none">A report at least ten days before the date of the bypass, if possible. The report shall include an evaluation of the anticipated quality and effect of the bypass. |
| (d) Unanticipated bypasses [40 CFR 122.41(m)(3)] | <ul style="list-style-type: none">Within 24 hours, an oral or electronic notification.Within 7 calendar days, a report that includes an evaluation of the quality and effect of the bypass. |
| (e) Noncompliance with the conditions of this permit that may endanger health or the environment [40 CFR 122.41(i)(7)] | <ul style="list-style-type: none">Within 24 hours, an oral or electronic notification.Within 7 calendar days, a report that contains a description of the noncompliance, and its causes; the period of noncompliance, including exact dates and times, and if the noncompliance has not been corrected, the anticipated time noncompliance is expected to continue; and steps taken or planned to reduce, eliminate, and prevent recurrence of the noncompliance. [40 CFR 122.41(i)(6)].Division staff may waive the requirement for a written report on a case-by-case basis. |

NCG01 SELF-INSPECTION, RECORDKEEPING AND REPORTING

EFFECTIVE: 04/01/19

Seeding Specifications

NPDES Stormwater Discharge Permit for Construction Activities (NCG01 - 4/1/19)
NCDEQ/Division of Energy, Mineral and Land Resources

| Site Area Description | Seeding Rate | Seeding Method |
|--|--------------|----------------|
| (a) Perimeter dikes, swales, ditches, and perimeter slopes | 2 | None |
| (b) High Quality Water (HQW) Zones | 2 | None |
| (c) Slopes steeper than 3:1 | 2 | None |
| (d) Slopes 3:1 to 4:1 | 2 | None |
| (e) Areas with slopes flatter than 4:1 | 2 | None |

Seedbed Preparation:

- Chisel compacted areas and spread topsoil three inches deep over adverse soil conditions, if available.
- Rip the entire area to six inches deep.
- Remove all loose rock, roots and other obstructions, leaving surface reasonably smooth and uniform.
- Apply agricultural lime, fertilizer and superphosphate uniformly and mix with soil (see mixture below).
- Continue tillage until a well-pulverized, firm, reasonably uniform seedbed is prepared four to six inches deep.
- Seed on a freshly prepared seedbed and cover seed lightly with seeding equipment or cultipack after seeding.
- Mulch immediately after seeding and anchor mulch.

| Mixture | Planting Rate |
|------------------------|---|
| Agricultural Limestone | 2 tons/acre (3 tons/acre in clay soils) |
| Fertilizer | 1,000 lbs/acre – 10-10-10 |
| Superphosphate | 500 lbs/acre – 20% analysis |
| Mulch | 2 tons/acre – small grain straw |
| Anchor | Asphalt emulsion at 400 gals/acre |

Seeding Schedule

For Shoulders, Side Ditches, Slopes (Max 3:1):

| Date | Type | Planting Rate |
|----------------|---|--|
| Aug 15- Nov 1 | Tall Fescue | 300 lbs/acre |
| Nov 1- Mar 1 | Tall Fescue & Abruzzi Rye | 300 lbs/acre |
| Mar 1- Apr 15 | Tall Fescue | 300 lbs/acre |
| Apr 15- Jun 30 | Hulled Common Bermudagrass | 25 lbs/acre |
| Jul 1- Aug 15 | Tall Fescue AND Browntop Millet or Sorghum-Sudan Hybrids*** | 125 lbs/acre (Tall Fescue): 35 lbs/acre (Browntop Millet), 30 lbs/acre (Sorghum-Sudan Hybrids) |

For Shoulders, Side Ditches, Slopes (3:1 to 2:1):

| Date | Type | Planting Rate |
|---------------|---|--|
| Mar 1- Jun 1 | Sericea Lespedeza (scarified) and use the following combinations: | 50 lbs/acre (Sericea Lespedeza); |
| Mar 1- Apr 15 | Add Tall Fescue | 120 lbs/acre |
| Mar 1- Jun 30 | Or add Weeping Love grass | 10 lbs/acre |
| Mar 1- Jun 30 | Or add Hulled Common Jun 30 Bermudagrass | 25 lbs/acre |
| Jul 1- Sept 1 | Tall Fescue AND Browntop Millet or Sorghum-Sudan Hybrids*** | 120 lbs/acre (Tall Fescue): 35 lbs/acre (Browntop Millet), 30 lbs/acre (Sorghum-Sudan Hybrids) |
| Sept 1- Mar 1 | Sericea Lespedeza (unhulled –unscarified) AND Tall Fescue | 70 lbs/acre (Sericea Lespedeza); 120 lbs/acre (Tall Fescue) |
| Nov 1- Mar 1 | AND Abruzzi Rye | 25 lbs/acre |

*** TEMPORARY: Reseed according to optimum season for desired permanent vegetation. Do not allow temporary cover to grow more than 12" in height before mowing; otherwise, rescue may be shaded out.

EROSION CONTROL - NOTES
CHIPOTLE AT WALLBROOK (LOT 5B)

Town of Rolesville Project No. SDP 25-03
Wake Forest Township, Town of Rolesville, Wake County, North Carolina

NC License: P-1139
ARK CONSULTING GROUP, PLLC
ENGINEERS & SURVEYORS
925-A Conference Drive
Raleigh, NC 27606
(757) 558-0888
www.arkconsultinggroup.com

PRELIMINARY
Do Not Use for Construction
7/1/2025

| | |
|------------------|--------|
| Project Manager: | BCF |
| Drawn By: | DLC |
| Checked By: | BCF |
| Project Number: | 24138 |
| Drawing Number: | D-1592 |

C1.0

Date: July 1, 2025

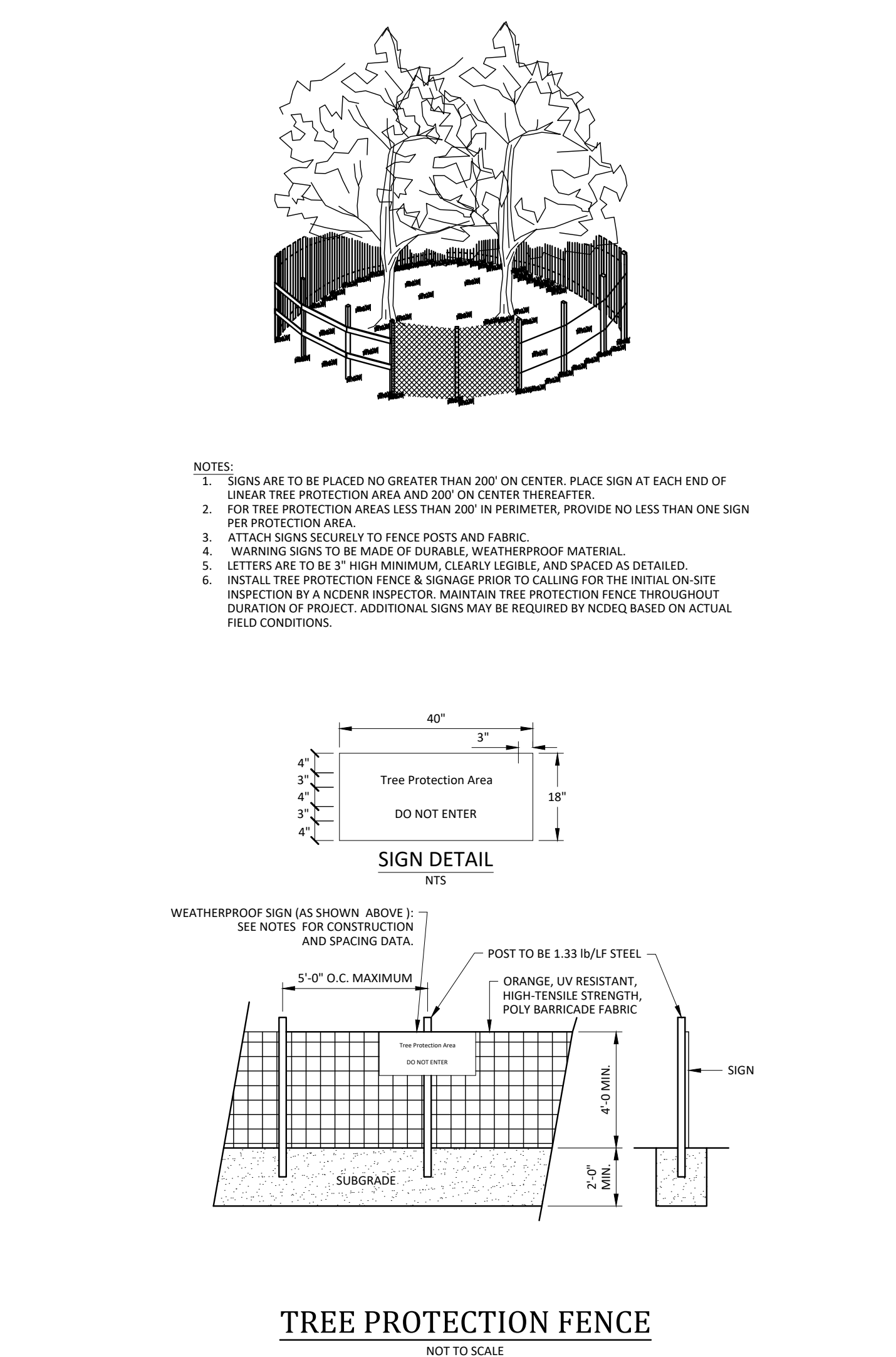
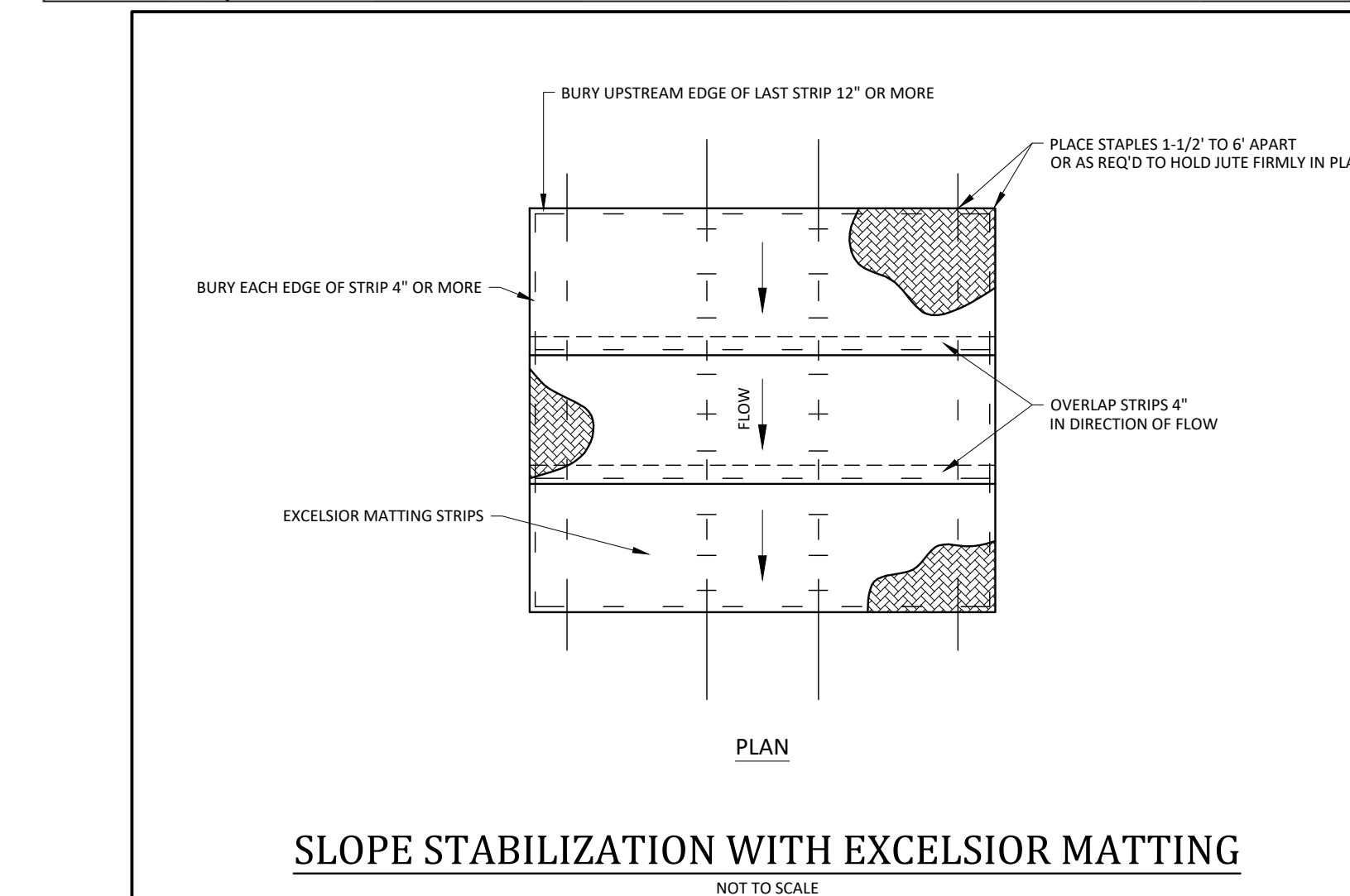
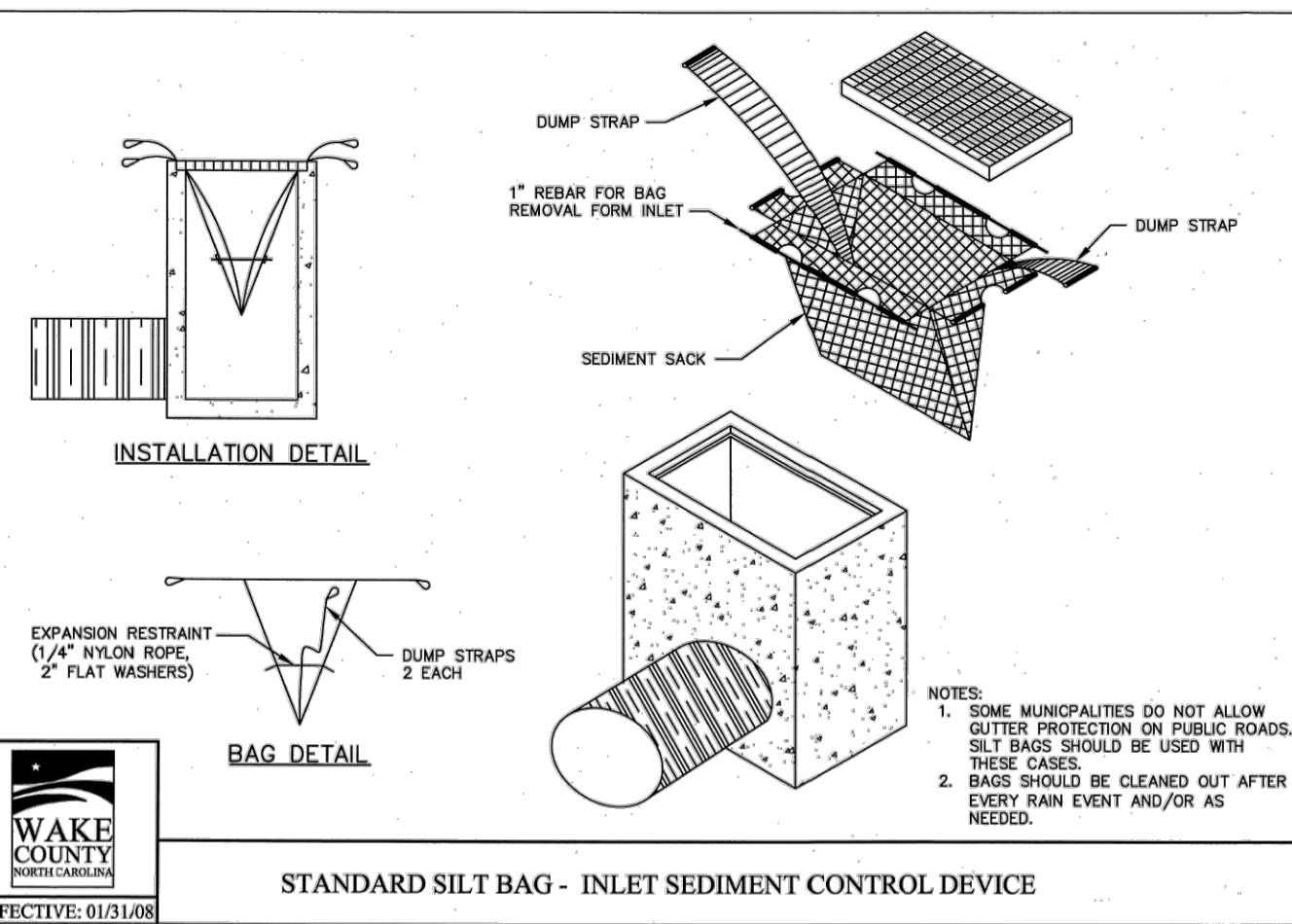
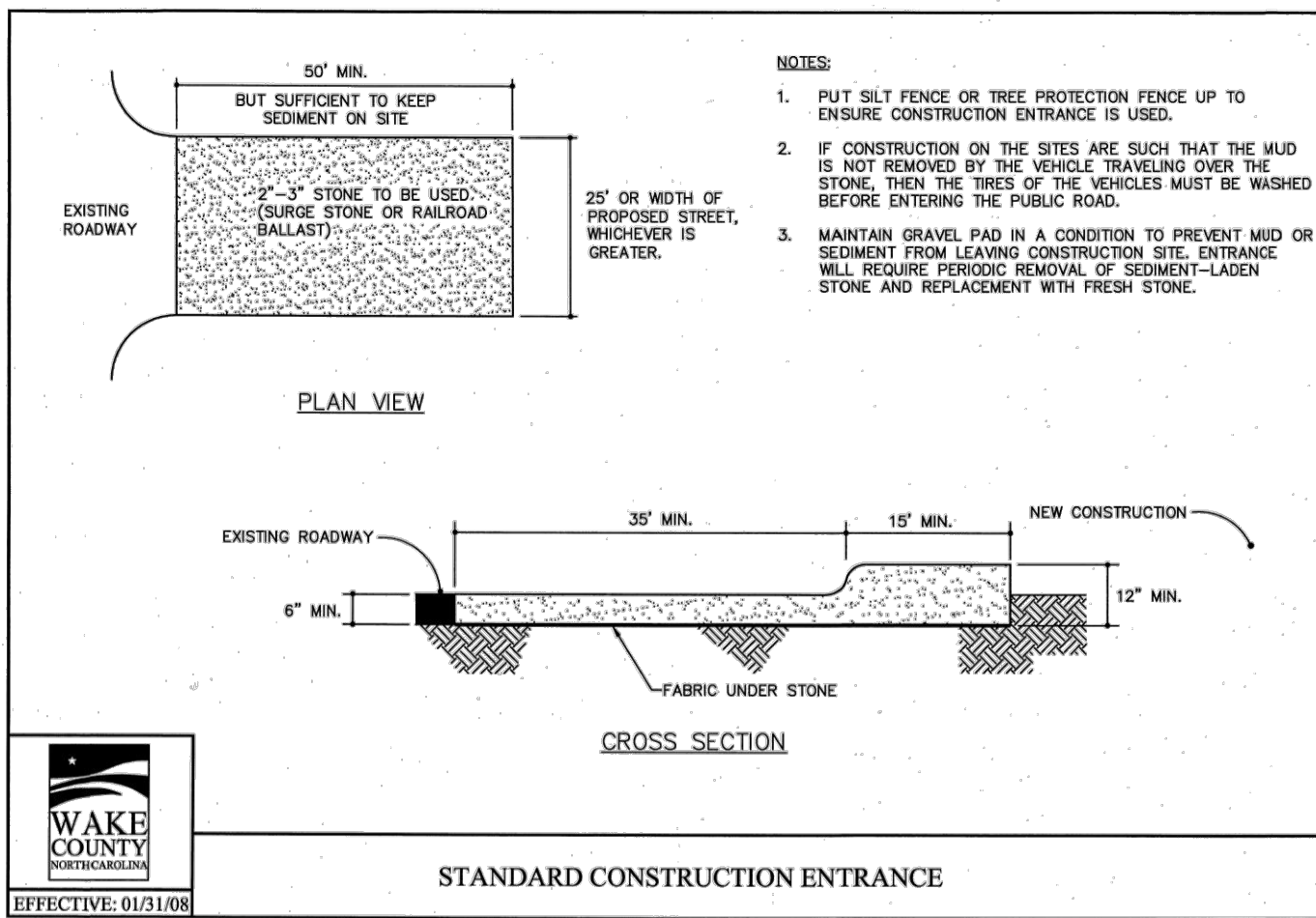
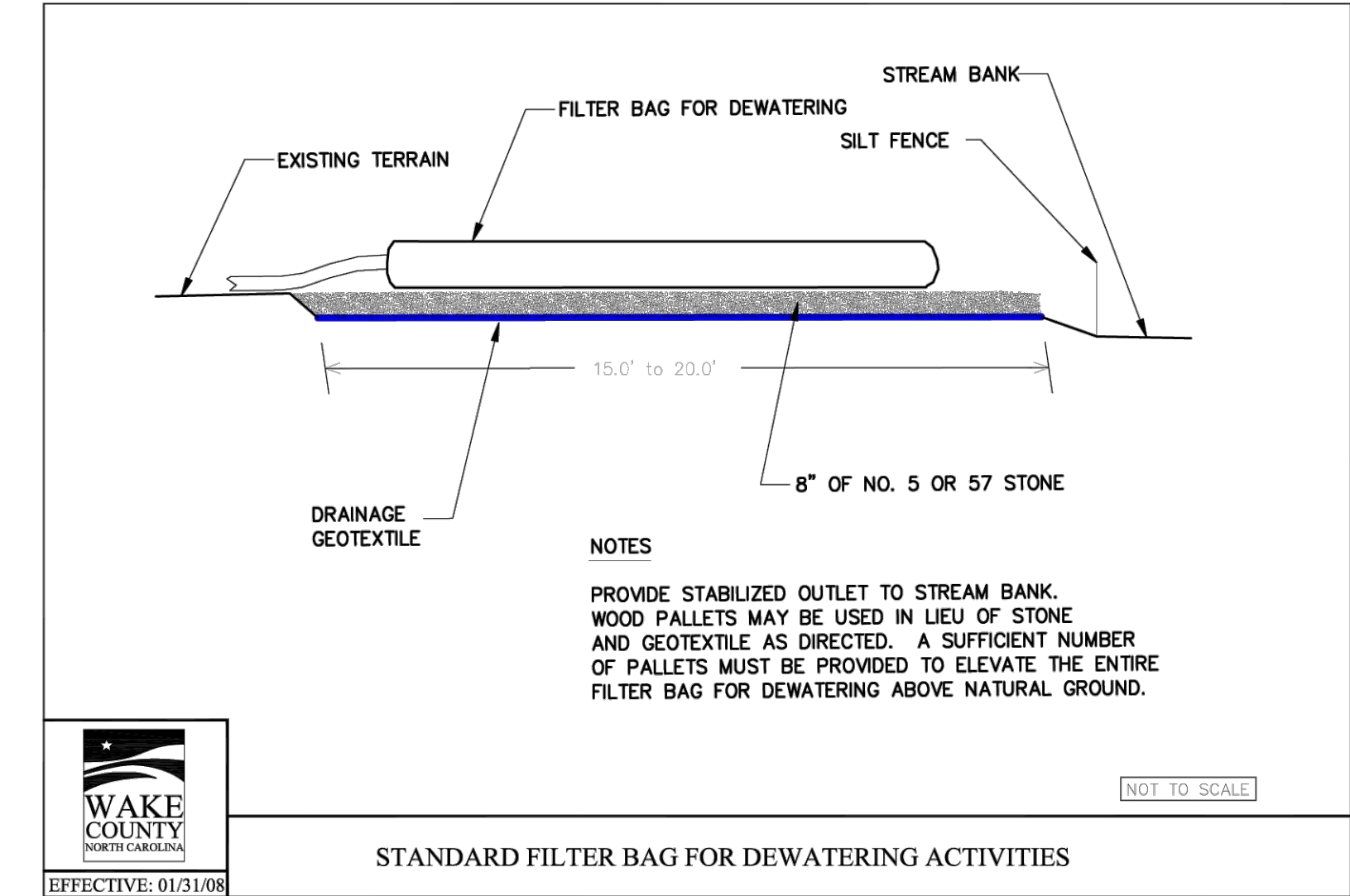
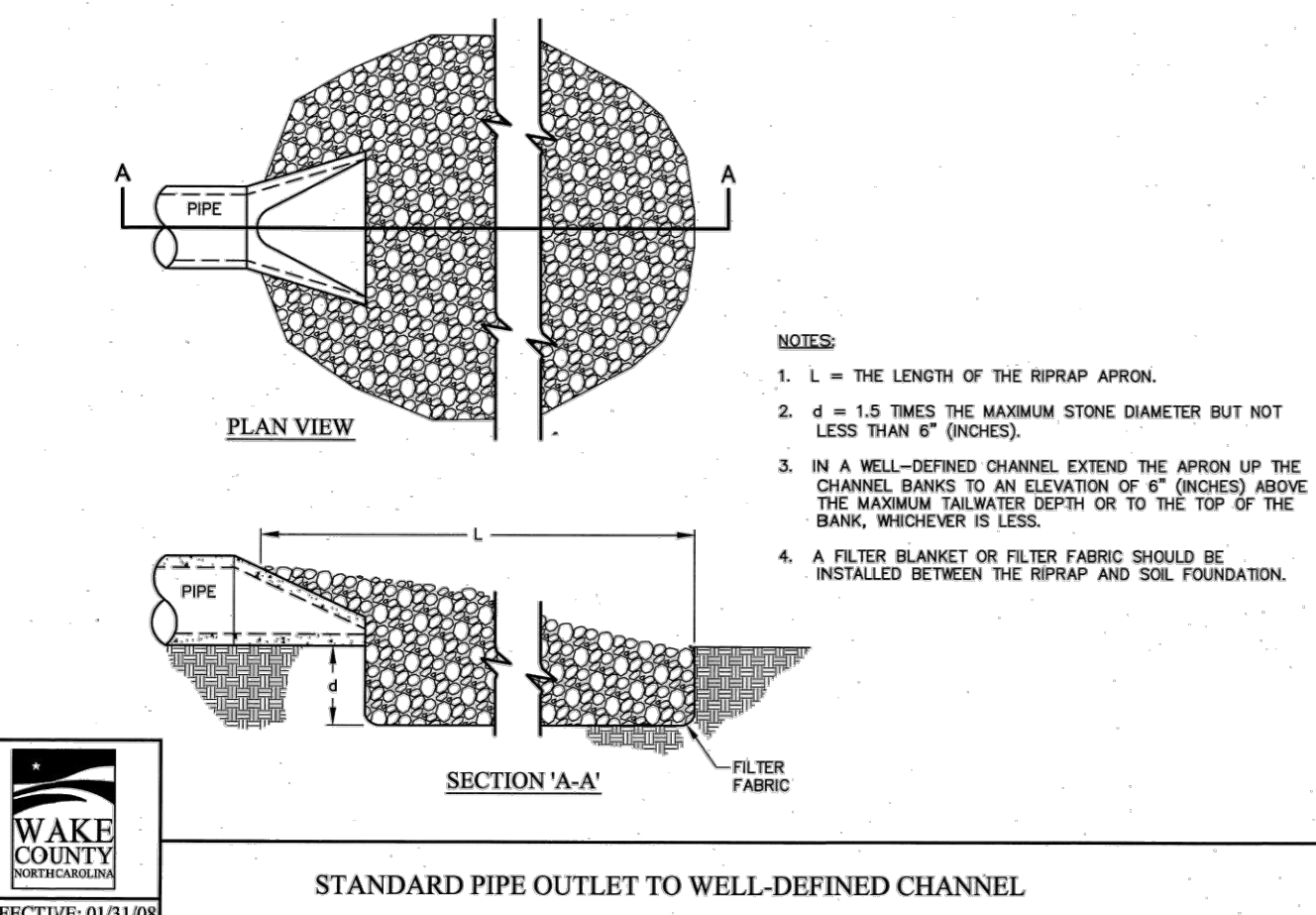
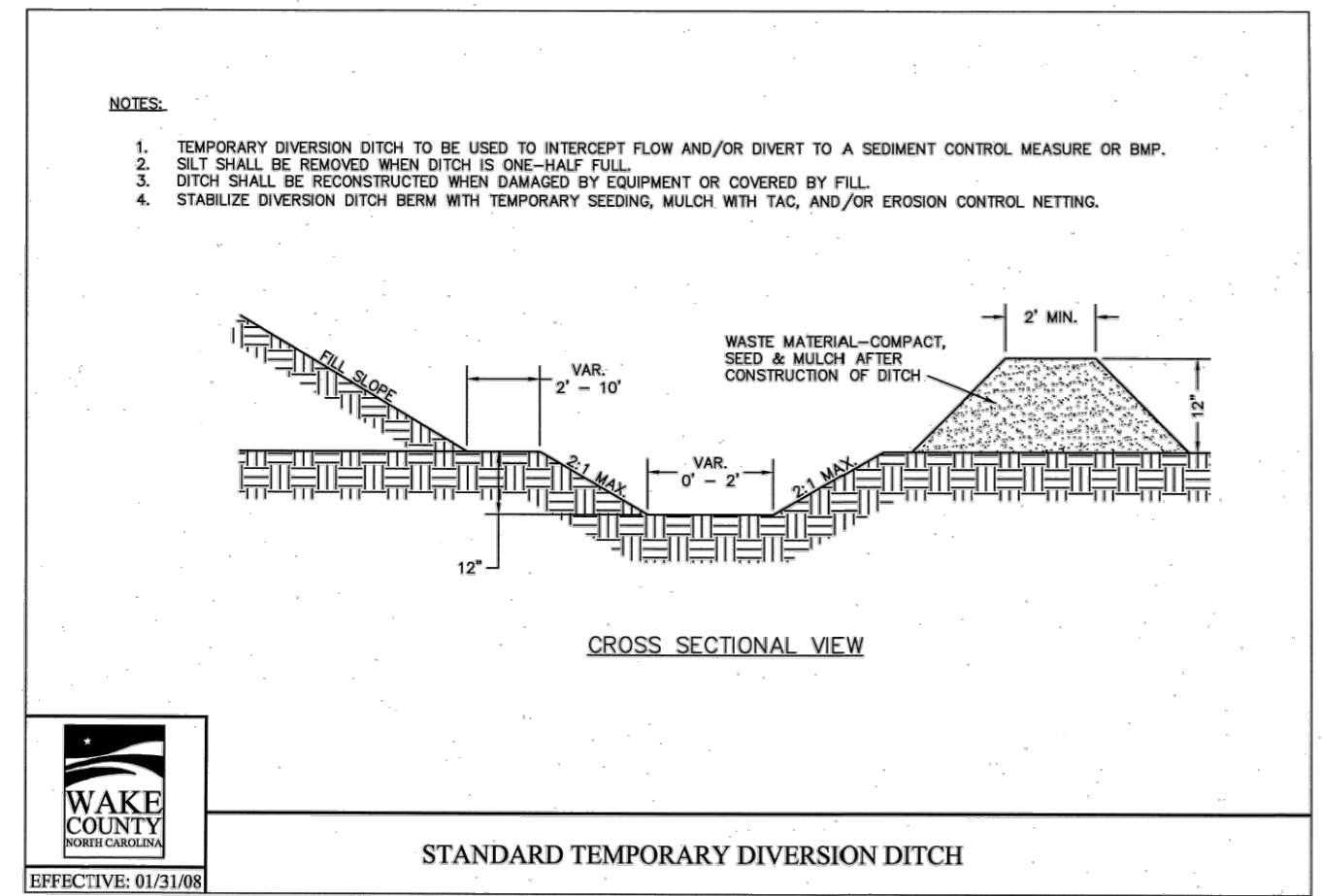
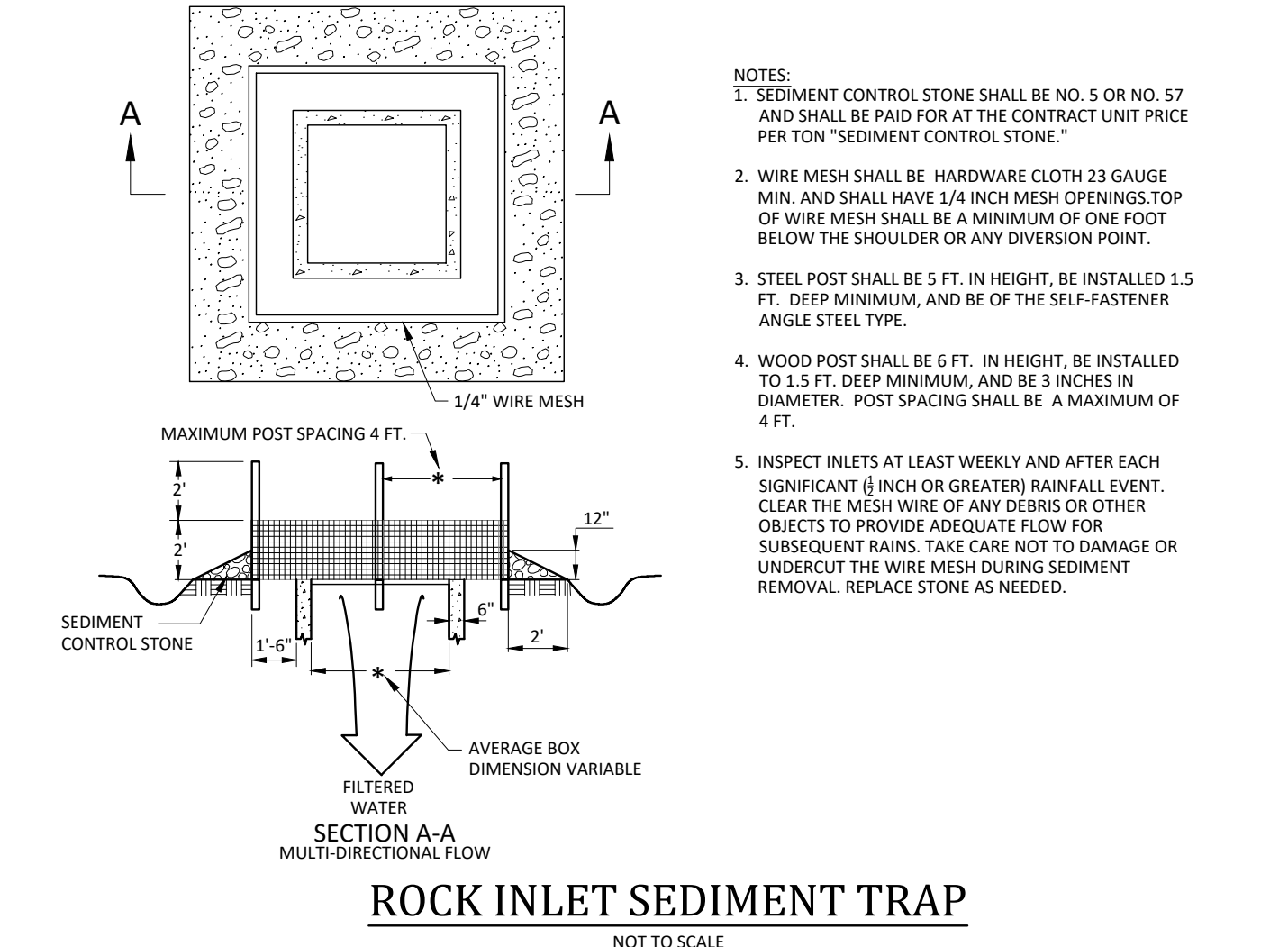
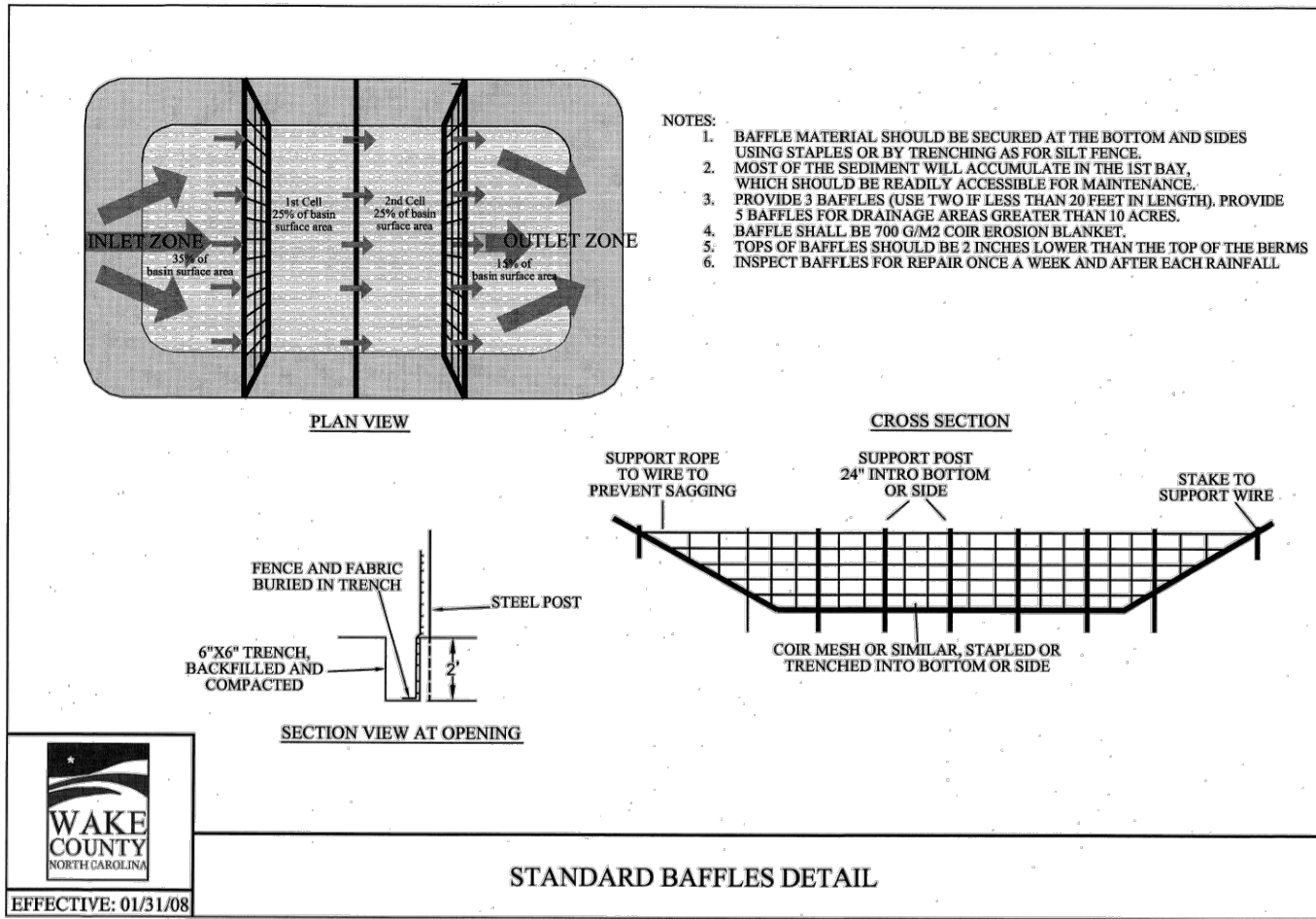
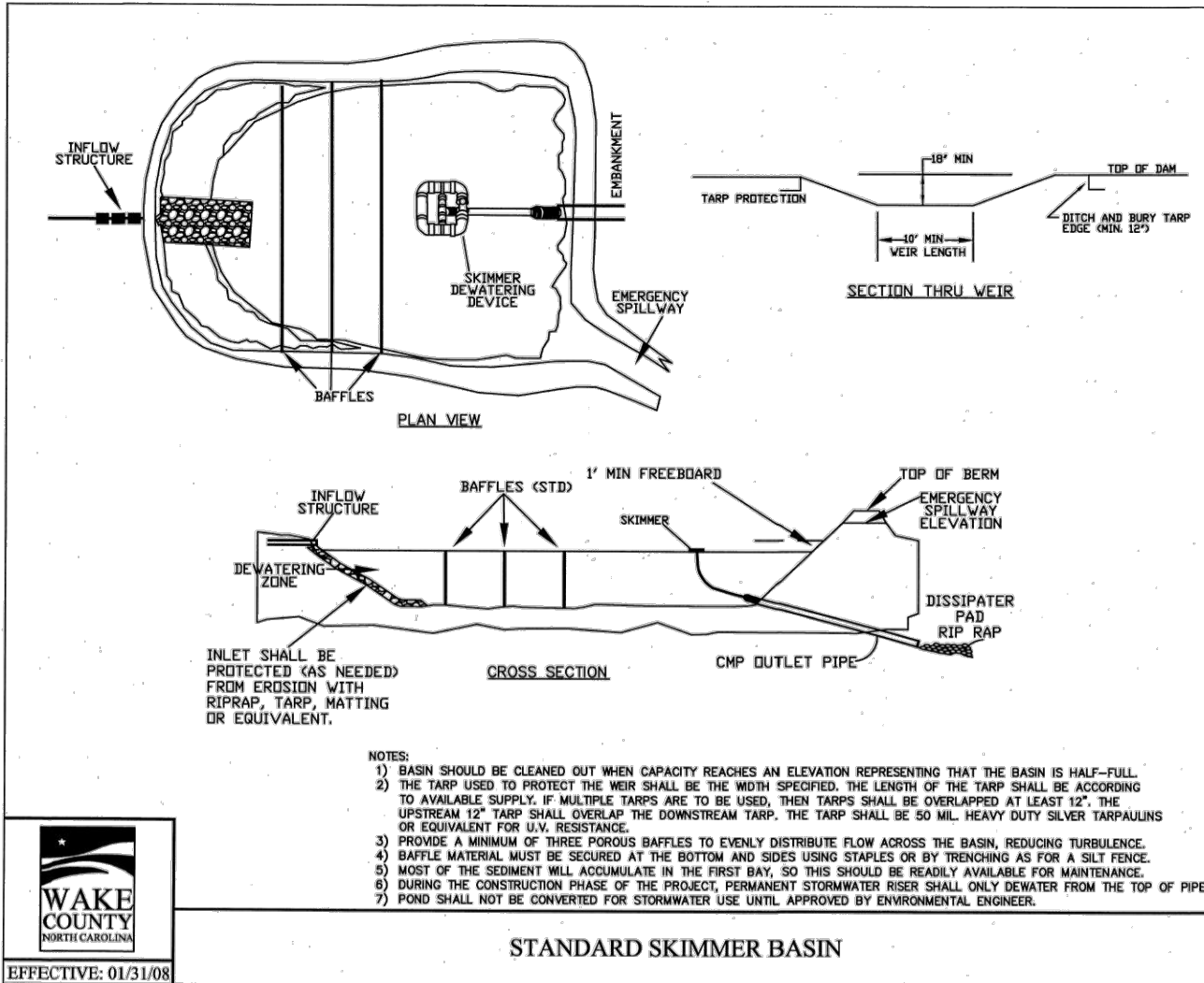
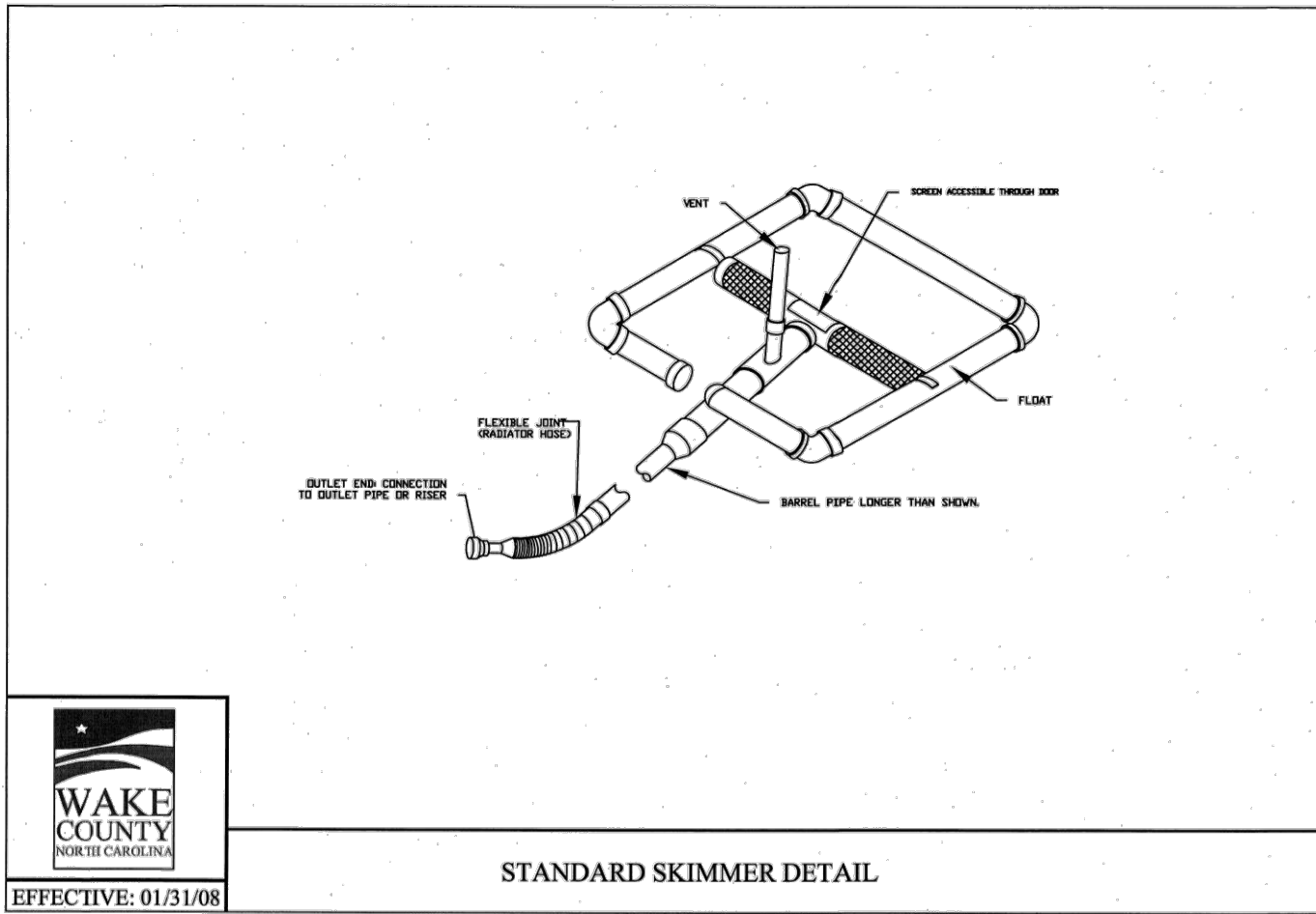
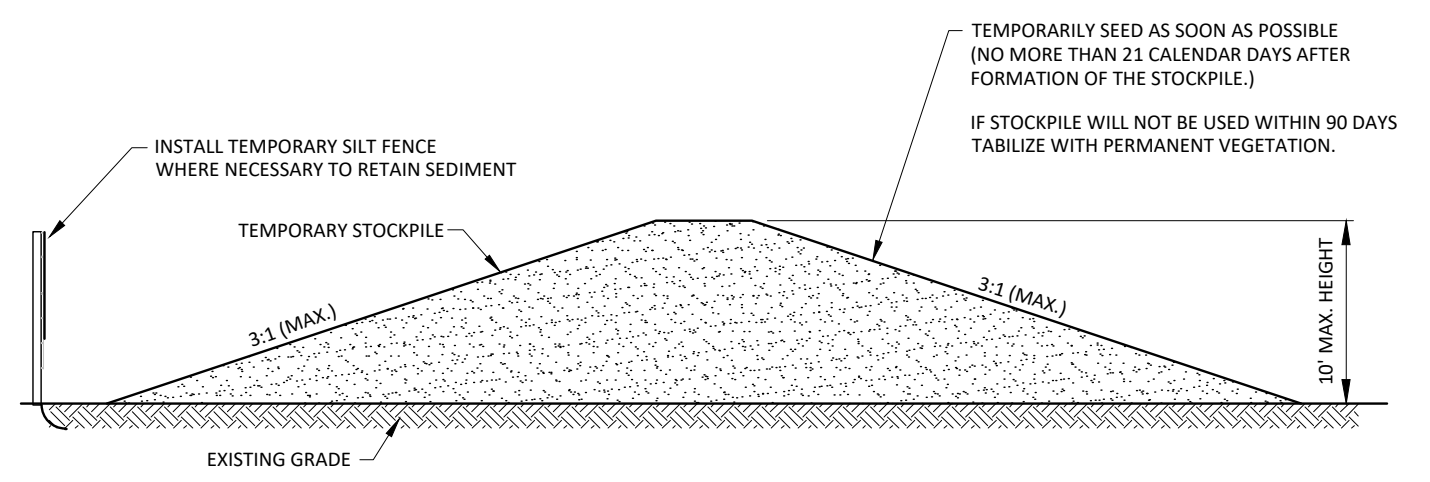
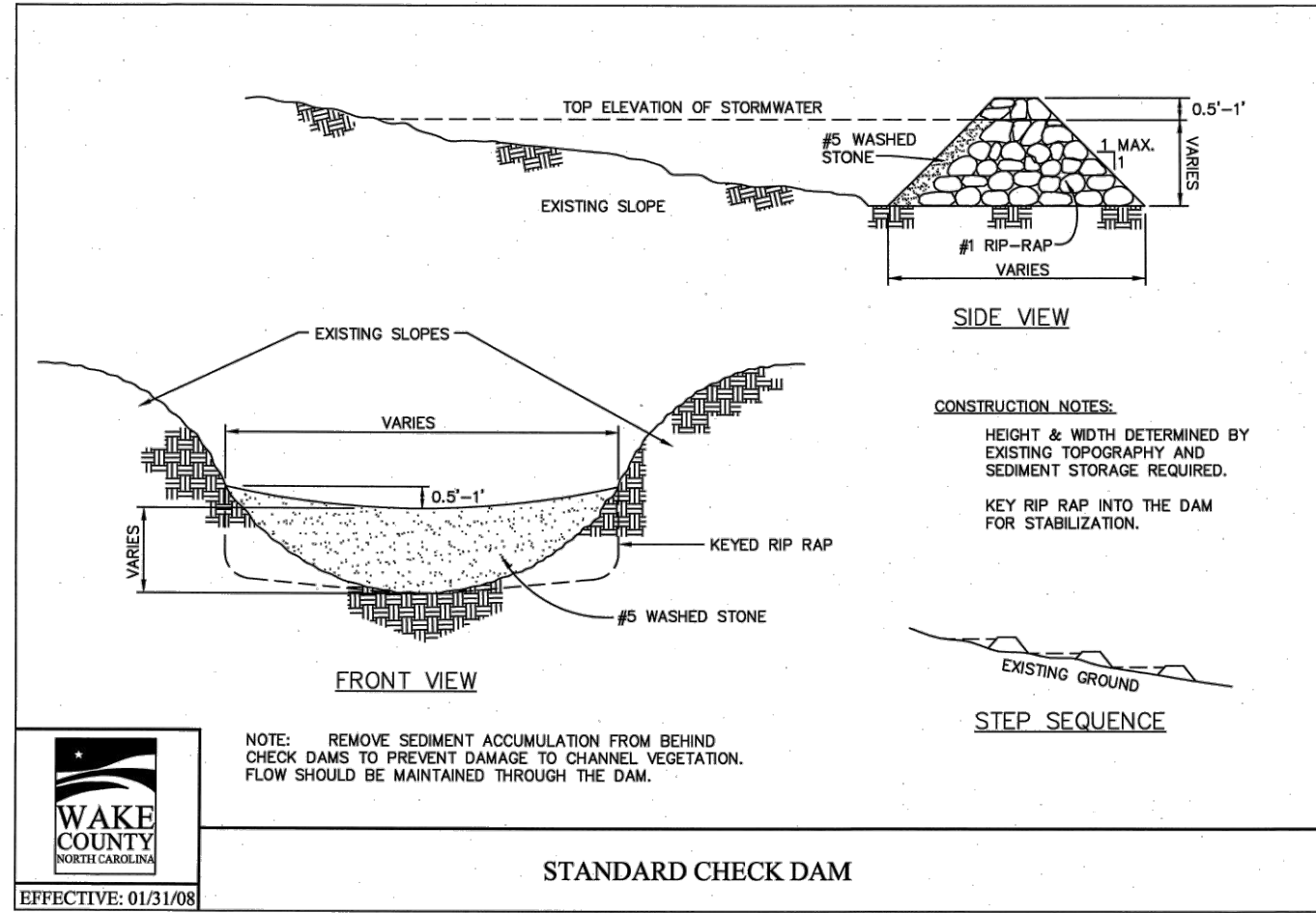
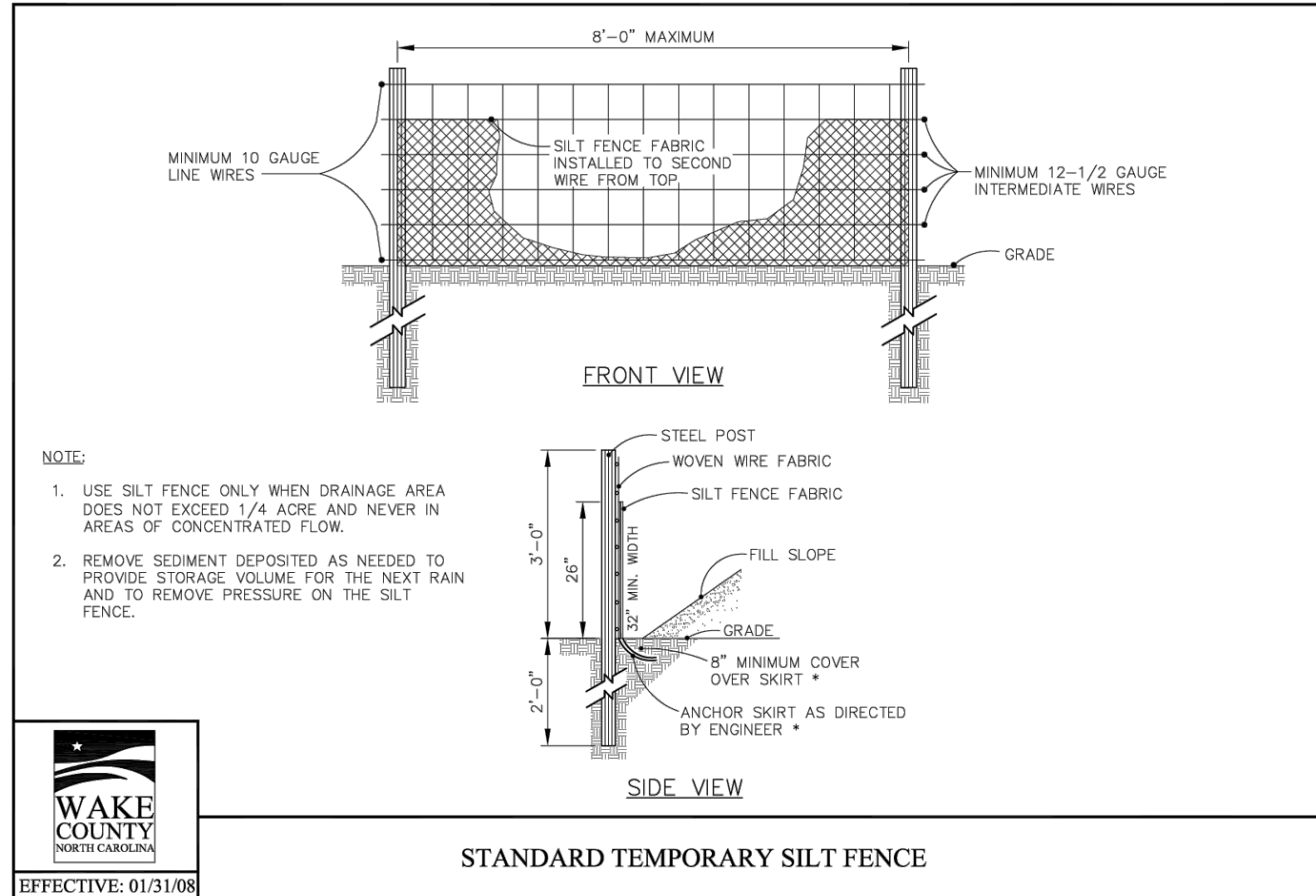
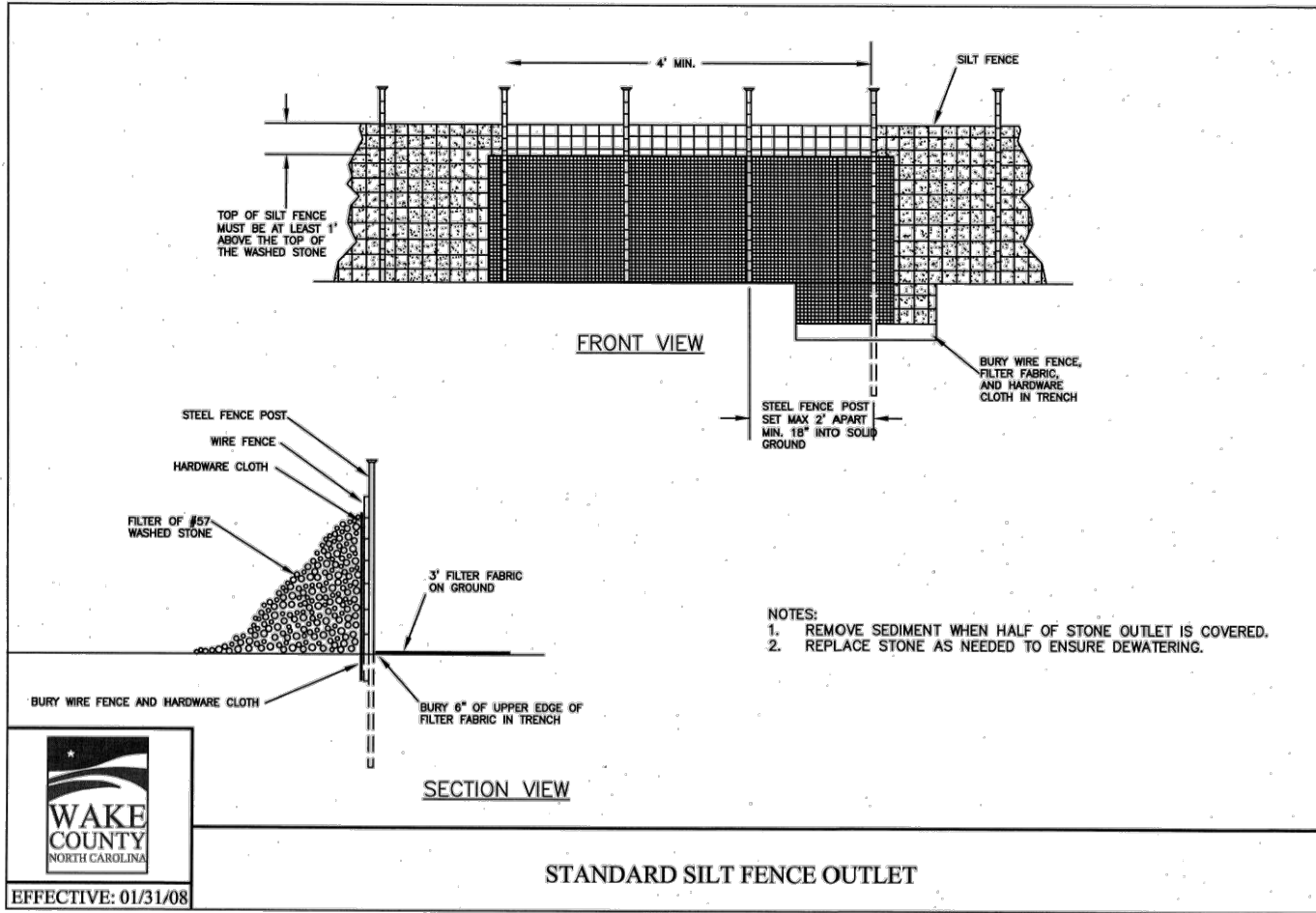

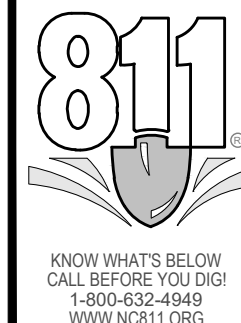

NC License: P-1359

ARK
CONSULTING
GROUP, PLLC
ENGINEERS & SURVEYORS

925-A Conference Drive
Greenville, NC 27658
(252) 558-0688
www.arkconsultinggroup.com

PRELIMINARY
Do Not Use
for Construction

7/1/2025

| | | |
|------------------|--------|--|
| Project Manager: | BCF | |
| Drawn By: | DLF | |
| Checked By: | BCF | |
| Project Number: | 24138 | |
| Drawing Number: | D-1592 | |

C2.0

Date: _____
July 1, 2005

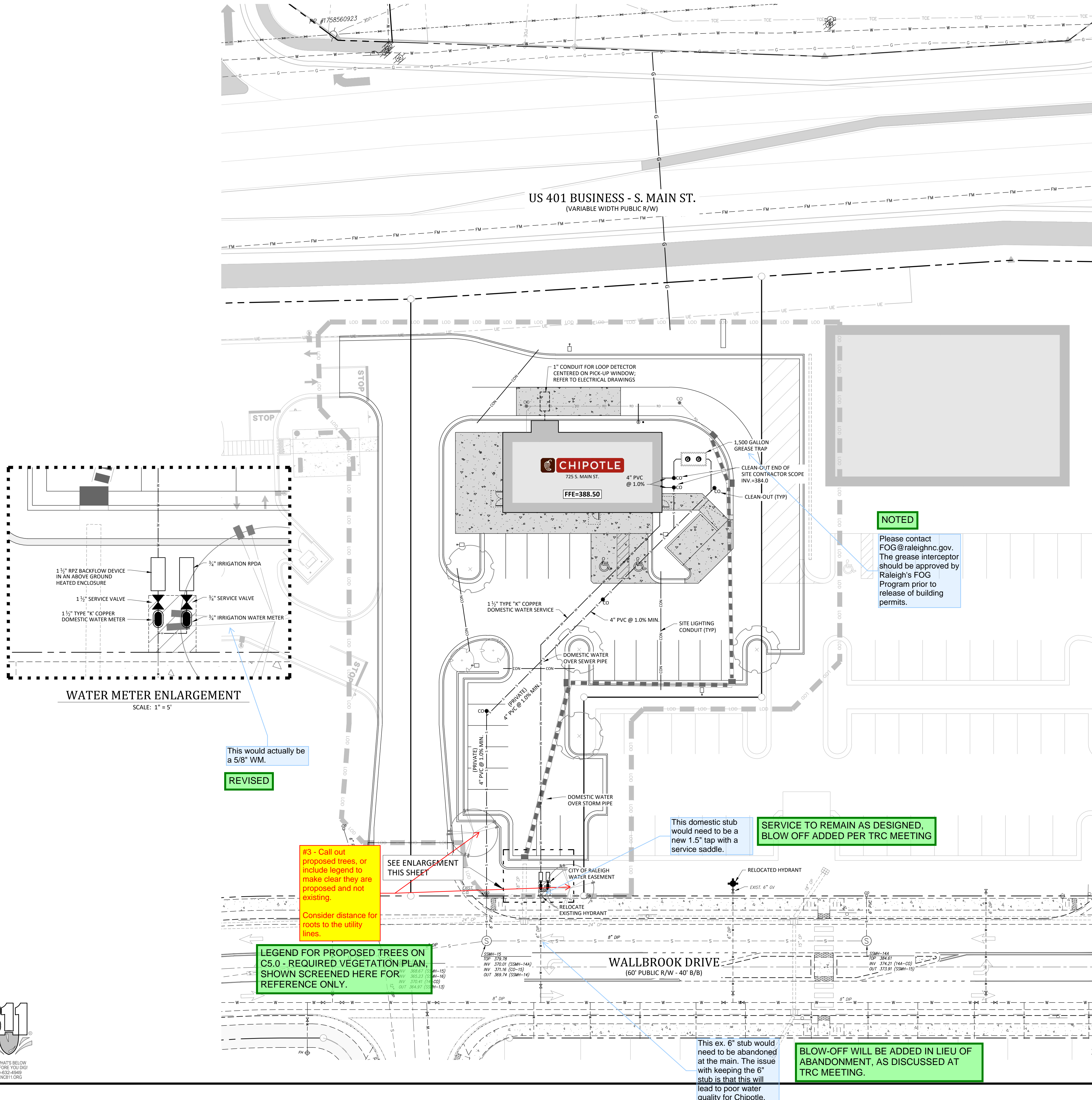

CORPUD Standard Utility Notes:

- ALL MATERIALS & CONSTRUCTION METHODS SHALL BE IN ACCORDANCE WITH CITY OF RALEIGH DESIGN STANDARDS, DETAILS & SPECIFICATIONS (REFERENCE: CORPUD HANDBOOK, CURRENT EDITION).
- UTILITY SEPARATION REQUIREMENTS:
 - A DISTANCE OF 100' SHALL BE MAINTAINED BETWEEN SANITARY SEWER & ANY PRIVATE OR PUBLIC WATER SUPPLY SOURCE SUCH AS AN IMPOUNDED RESERVOIR USED AS A SOURCE OF DRINKING WATER. IF ADEQUATE LATERAL SEPARATION CANNOT BE ACHIEVED, FERROUS SANITARY SEWER PIPE SHALL BE SPECIFIED & INSTALLED TO WATERLINE SPECIFICATIONS. HOWEVER, THE MINIMUM SEPARATION SHALL NOT BE LESS THAN 25' FROM A PRIVATE WELL OR 50' FROM A PUBLIC WELL.
 - WHEN INSTALLING WATER &/OR SEWER MAINS, THE HORIZONTAL SEPARATION BETWEEN UTILITIES SHALL BE 10'. IF THIS SEPARATION CANNOT BE MAINTAINED DUE TO EXISTING CONDITIONS, THE VARIATION ALLOWED IS THE WATER MAIN IN A SEPARATE TRENCH WITH THE ELEVATION OF THE WATER MAIN AT LEAST 18" ABOVE THE TOP OF THE SEWER & MUST BE APPROVED BY THE PUBLIC UTILITIES DIRECTOR. ALL DISTANCES ARE MEASURED FROM OUTSIDE DIAMETER TO OUTSIDE DIAMETER.
 - WHERE IT IS IMPOSSIBLE TO OBTAIN PROPER SEPARATION, OR ANYTIME A SANITARY SEWER PASSES OVER A WATERMAIN, DIP MATERIALS OR STEEL ENCASMENT EXTENDED 10' ON EACH SIDE OF CROSSING MUST BE SPECIFIED & INSTALLED TO WATERLINE SPECIFICATIONS.
 - 5.0' MINIMUM HORIZONTAL SEPARATION IS REQUIRED BETWEEN ALL SANITARY SEWER & STORM SEWER FACILITIES, UNLESS DIP MATERIAL IS SPECIFIED FOR SANITARY SEWER.
 - MAINTAIN 18" MIN. VERTICAL SEPARATION AT ALL WATERMAIN & RCP STORM DRAIN CROSSINGS; MAINTAIN 18" MIN. VERTICAL SEPARATION AT ALL SANITARY SEWER & RCP STORMDRAIN CROSSINGS. WHERE ADEQUATE SEPARATIONS CANNOT BE ACHIEVED, SPECIFY DIP MATERIALS & A CONCRETE CRADLE HAVING 6" MIN. CLEARANCE (PER CORPUD DETAILS W-41 & S-49).
 - ALL OTHER UNDERGROUND UTILITIES SHALL CROSS WATER & SEWER FACILITIES WITH 18" MIN. VERTICAL SEPARATION REQUIRED.
- ANY NECESSARY FIELD REVISIONS ARE SUBJECT TO REVIEW & APPROVAL OF AN AMENDED PLAN &/OR PROFILE BY THE CITY OF RALEIGH PUBLIC UTILITIES DEPARTMENT PRIOR TO CONSTRUCTION.
- DEVELOPER SHALL PROVIDE 30 DAYS ADVANCE WRITTEN NOTICE TO OWNER FOR ANY WORK REQUIRED WITHIN AN EXISTING CITY OF RALEIGH UTILITY EASEMENT TRAVERSING PRIVATE PROPERTY.
- CONTRACTOR SHALL MAINTAIN CONTINUOUS WATER & SEWER SERVICE TO EXISTING RESIDENCES & BUSINESSES THROUGHOUT CONSTRUCTION OF PROJECT. ANY NECESSARY SERVICE INTERRUPTIONS SHALL BE PRECEDED BY A 24-HOUR ADVANCE NOTICE TO THE CITY OF RALEIGH PUBLIC UTILITIES DEPARTMENT.
- SEWER BYPASS PUMPING – A BYPASS PLAN SEALED BY AN NC PROFESSIONAL ENGINEER SHALL BE PROVIDED TO RALEIGH WATER PRIOR TO PUMPING OPERATIONS FOR APPROVAL. THE OPERATIONS AND EQUIPMENT SHALL COMPLY WITH THE PUBLIC UTILITIES HANDBOOK.
- 3.0' MINIMUM COVER IS REQUIRED ON ALL WATER MAINS & SEWER FORCE MAINS. 4.0' MINIMUM COVER IS REQUIRED ON ALL REUSE MAINS.
- IT IS THE DEVELOPER'S RESPONSIBILITY TO ABANDON OR REMOVE EXISTING WATER & SEWER SERVICES NOT BEING USED IN REDEVELOPMENT OF A SITE UNLESS OTHERWISE DIRECTED BY THE CITY OF RALEIGH PUBLIC UTILITIES DEPARTMENT. THIS INCLUDES ABANDONING TAP AT MAIN & REMOVAL OF SERVICE FROM ROW OR EASEMENT PER CORPUD HANDBOOK PROCEDURE.
- INSTALL WATER SERVICES WITH METERS LOCATED AT ROW OR WITHIN A 2'X2' WATERLINE EASEMENT IMMEDIATELY ADJACENT. NOTE: IT IS THE APPLICANT'S RESPONSIBILITY TO PROPERLY SIZE THE WATER SERVICE FOR EACH CONNECTION TO PROVIDE ADEQUATE FLOW & PRESSURE.
- INSPECTIONS OF 4" AND LARGER WATER MAINS OF THE PRIVATE DISTRIBUTION SYSTEM WILL BE INSPECTED AS PART OF THE INFRASTRUCTURE PERMIT.
- PRIVATE SEWER MAINS AS PART OF A COLLECTION SYSTEM ARE PERMITTED AND INSPECTED UNDER THE PRIVATE INFRASTRUCTURE PERMIT FOR SEWER.
- ANY WATER OR SEWER SERVICES ON PRIVATE PROPERTY THAT WILL BE INSTALLED UNDER CONSTRUCTION DRAWINGS MAY REQUIRE A PLUMBING UTILITY PERMIT IN THE CITY OF RALEIGH. CONSULT WITH THE ENGINEERING INSPECTION COORDINATOR DURING THE PRE-CONSTRUCTION MEETING ON THE NECESSARY PERMITS.
- INSTALL SEWER SERVICES WITH CLEANOUTS LOCATED AT ROW OR EASEMENT LINE & SPACED PER THE CURRENT NC PLUMBING CODE.
- PRESSURE REDUCING VALVES ARE REQUIRED ON ALL WATER SERVICES EXCEEDING 80 PSI; BACKWATER VALVES ARE REQUIRED ON ALL SANITARY SEWER SERVICES HAVING BUILDING DRAINS LOWER THAN 1.0' ABOVE THE NEXT UPSTREAM MANHOLE.
- ALL ENVIRONMENTAL PERMITS APPLICABLE TO THE PROJECT MUST BE OBTAINED FROM NCDWQ, USACE &/OR FEMA FOR ANY RIPARIAN BUFFER, WETLAND &/OR FLOODPLAIN IMPACTS (RESPECTIVELY) PRIOR TO CONSTRUCTION.
- NC DOT / RAILROAD ENCRoACHMENT AGREEMENTS ARE REQUIRED FOR ANY UTILITY WORK (INCLUDING MAIN EXTENSIONS & SERVICE TAPS) WITHIN STATE OR RAILROAD ROW PRIOR TO CONSTRUCTION.
- GREASE INTERCEPTOR / OIL WATER SEPARATOR SIZING CALCULATIONS & INSTALLATION SPECIFICATIONS SHALL BE APPROVED BY THE RW FOG PROGRAM COORDINATOR PRIOR TO ISSUANCE OF A UC AND/OR BUILDING PERMIT. CONTACT (919) 996-4516 OR FOG@RALEIGHNC.GOV FOR MORE INFORMATION.
- CROSS-CONNECTION CONTROL PROTECTION DEVICES ARE REQUIRED BASED ON THE DEGREE OF HEALTH HAZARD INVOLVED AS LISTED IN APPENDIX B OF THE RULES GOVERNING PUBLIC WATER SYSTEMS IN NORTH CAROLINA.
- THE DEVICES SHALL MEET THE AMERICAN SOCIETY OF SANITARY ENGINEERING (ASSE) STANDARDS AND BE ON THE UNIVERSITY OF SOUTHERN CALIFORNIA APPROVAL LIST.
- THE DEVICE AND INSTALLATION SHALL MEET THE GUIDELINES OF APPENDIX A – GUIDELINES AND REQUIREMENTS FOR THE CROSS CONNECTION PROGRAM IN RALEIGH'S SERVICE AREA.
- THE DEVICES SHALL BE INSTALLED AND TESTED (BOTH, INITIAL AND PERIODIC TESTING THEREAFTER) IN ACCORDANCE WITH THE MANUFACTURER'S RECOMMENDATIONS OR THE LOCAL CROSS CONNECTION CONTROL PROGRAM, WHICHEVER IS MORE STRINGENT. CONTACT CROSS.CONNECTION@RALEIGHNC.GOV FOR MORE INFORMATION.
- NOTICE FOR PROJECTS THAT INVOLVE AN OVERSIZED MAIN OR URBAN MAIN REPLACEMENT. ANY CITY REIMBURSEMENT GREATER THAN \$250,000.00 MUST UNDERGO THE PUBLIC BIDDING PROCESS.
- PRIVATE SUB-METERING - NO RESALE OF WATER SHALL OCCUR WITHOUT APPROVAL OF THE NORTH CAROLINA UTILITY COMMISSION. SUB-METERING SHALL BE IN ACCORDANCE WITH SECTION 1400 OF THE "SAFE DRINKING WATER ACT".

NOTED

This review will require additional reviews please apply in the Raleigh Portal.
Merger Communities Plan Review Process:
<https://raleighnc.gov/water-and-sewer/services/merger-communities-plan-review-process-raleigh-water-and-sewer>

NOTED

Please contact
FOG@raleighnc.gov.
The grease interceptor
should be approved by
Raleigh's FOG
Program prior to
release of building
permits.

SERVICE TO REMAIN AS DESIGNED,
BLOW OFF ADDED PER TRC MEETING

BLOW-OFF WILL BE ADDED IN LIEU OF
ABANDONMENT, AS DISCUSSED AT
TRC MEETING.

This ex. 6" stub would
need to be abandoned
at the main. The issue
with keeping the 6"
stub is that this will
lead to poor water
quality for Chipotle.

This domestic stub
would need to be a
new 1.5" tap with a
service saddle.

SEE ENLARGEMENT
THIS SHEET

#3 - Call out
proposed trees, or
include legend to
make clear they are
proposed and not
existing.
Consider distance for
roots to the utility
lines.

LEGEND FOR PROPOSED TREES ON
C5.0 - REQUIRED VEGETATION PLAN.
SHOWN SCREENED HERE FOR
REFERENCE ONLY.

This would actually be
a 5/8" WM.

REVISED

WATER METER ENLARGEMENT
SCALE: 1" = 5'

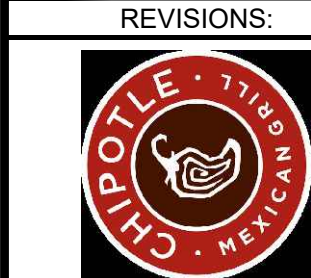

REVISIONS:
1. JUL-25 SUBMIT FOR PERMIT REVIEW
DATE

UTILITY PLAN
CHIPOTLE AT WALLBROOK (LOT 5B)
Town of Rolesville Project No. SDP 25-03
Wake Forest Township, Town of Rolesville, Wake County, North Carolina

NC License: P-1199
ARK CONSULTING GROUP PLLC
ENGINEERS & SURVEYORS
925-A Conference Drive
Raleigh, NC 27606
(919) 558-8888
www.arkconsultinggroup.com
PRELIMINARY
Do Not Use
for Construction
1/1/2025

Project Manager: BCF
Drawn By: DLC
Checked By: BCF
Project Number: 24138
Drawing Number: D-1592

C3.0
Date: July 1, 2025

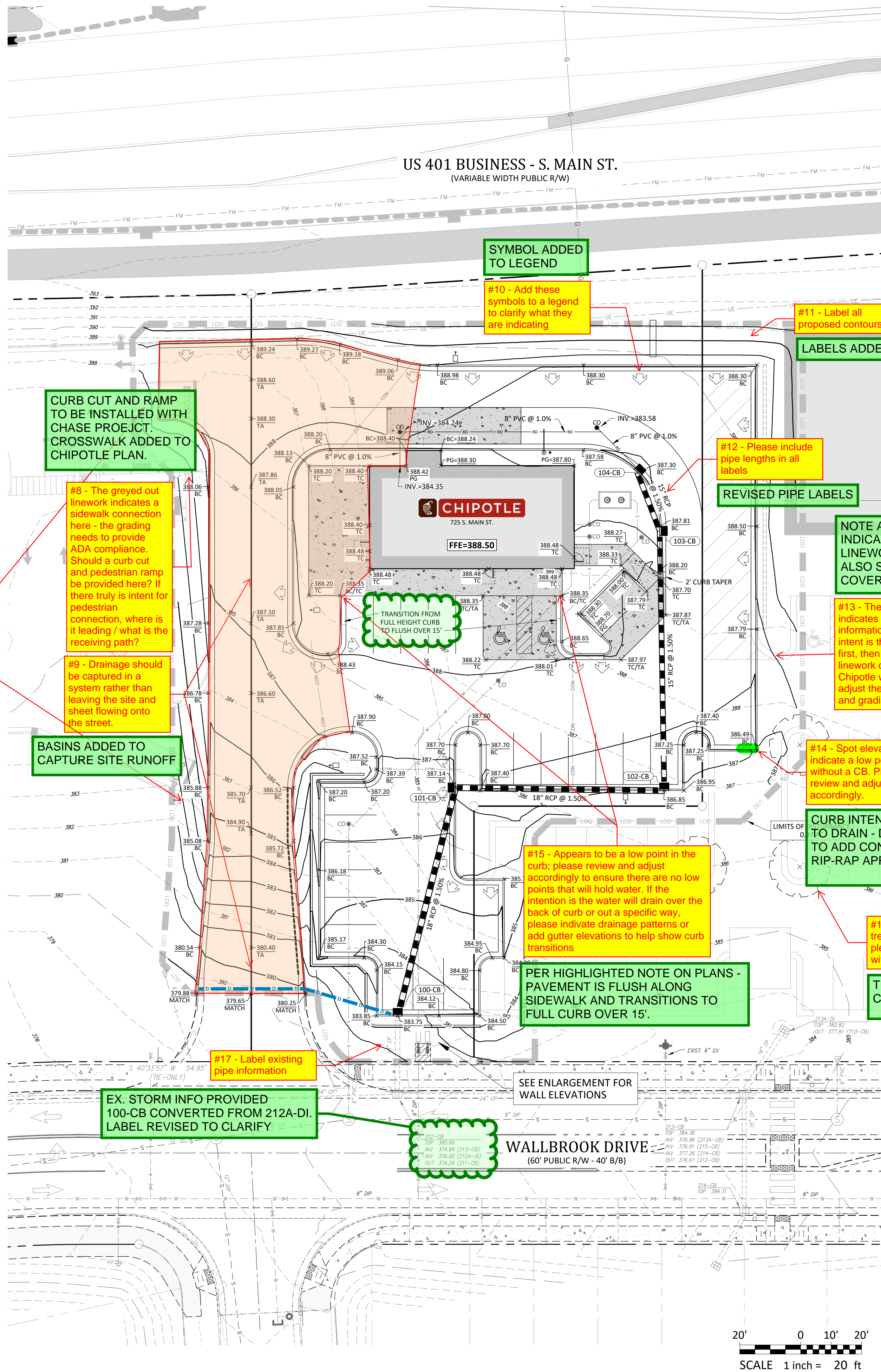

Grading Notes:

1. SITE GRADING SHALL BE PERFORMED IN ACCORDANCE WITH THESE PLANS AND SPECIFICATIONS AND THE RECOMMENDATIONS SET FORTH IN THE GEOTECHNICAL REPORT REFERENCED IN THIS PLAN SET.
2. SITE CONTRACTOR TO GRADE ALL AREAS WITHIN THE LIMITS OF DISTURBANCE FROM BUILDING TO PROPERTY LINES AND TO EDGE OF PAVEMENT ON STREET SIDES, INCLUDING ROW.
3. TREES OUTSIDE OF CONSTRUCTION LIMITS OR TREES NOT INDICATED TO BE REMOVED SHALL BE PROTECTED.
4. TOP SOIL SHALL BE STRIPPED FROM ALL CUT AND FILL AREAS, STOCKPILED AND REDISTRIBUTED OVER GRADED AREAS. PROVIDE EROSION AND SEDIMENTATION CONTROLS AROUND STOCKPILES DURING CONSTRUCTION.
5. TILL TOP SOIL TO A DEPTH OF 4" MINIMUM AND REMOVE ALL ROCKS LARGER THAN 1" MEASURED IN LARGEST DIRECTION.
6. GRADE ALL AREAS TO MAINTAIN POSITIVE SLOPE AWAY FROM BUILDING.
7. ALL GRADED AREAS TO RECEIVE SEED OR SOD, TOP SOIL, STRAW AND WATER UNTIL A HEALTHY STAND OF GRASS IS OBTAINED.
8. INSTALL TEMPORARY TURF REINFORCEMENT MATTING ON ALL SLOPES STEEPER THAN 3:1. MATTING SHALL BE CONTECH LANDLOK C2 OR EQUAL.
9. REFER TO CIVIL DETAILS FOR PAVEMENT IN PARKING AND DRIVE AREAS.
10. ALL SIDEWALKS SHALL BE CONSTRUCTED OF 3,500 PSI CONCRETE AND SHALL HAVE TOOLED CONTROL JOINTS PER THE JOINT SPACING REFERENCED ON THE PLAN.
11. MATERIALS SELECTED FOR USE AS STRUCTURAL FILL SHALL BE FREE OF VEGETABLE MATTER, WASTE CONSTRUCTION DEBRIS, AND OTHER DELETERIOUS MATERIALS. THE MATERIAL SHALL NOT CONTAIN ROCKS HAVING A DIAMETER OVER 3 INCHES.
12. SOILS REPRESENTED BY THEIR USCS GROUP SYMBOLS WILL TYPICALLY BE SUITABLE FOR USE AS STRUCTURAL FILL: (ML), (CL), (SM), AND (SC).
13. THE FOLLOWING SOILS ARE CONSIDERED SUITABLE IN AREAS WHERE A MINIMUM THICKNESS OF 3' OF LOW PERMEABILITY SOILS CAN BE USED AS COVER: (SW), (SP), (SP-SM), AND (SP-SC).
14. THE FOLLOWING SOILS ARE CONSIDERED SUITABLE IN AREAS WHERE A MINIMUM THICKNESS OF 3' OF NON-EXPANSIVE SOILS CAN BE USED AS COVER: (MH) AND (CH).
15. THE FOLLOWING SOIL TYPES ARE CONSIDERED UNSUITABLE: (OL), (OH), AND (PI).
16. ALL STRUCTURAL FILL SHALL BE COMPACTED TO A MINIMUM OF 95% OF THE STANDARD PROCTOR MAXIMUM DRY DENSITY (ASTM D698). ADDITIONALLY, THE IN-PLACE MAXIMUM DRY DENSITY OF STRUCTURAL FILL SHOULD BE NO LESS THAN 90 PCF.
17. THE UPPER 12" OF BUILDING FLOOR SLAB SUBGRADES SHALL BE COMPACTED TO AT LEAST 98% OF THE STANDARD PROCTOR MAXIMUM DRY DENSITY (ASTM D698).
18. FILL PLACEMENT IN PAVEMENT AREAS SHALL BE PERFORMED IN ACCORDANCE WITH NCDOT STANDARD SPECIFICATIONS.
19. SUITABLE FILL MATERIAL SHALL BE PLACED IN 8" LIFTS AND COMPACTED BY MECHANICAL MEANS. PROOFROLLING WITH RUBBER TIRE, HEAVILY LOADED VEHICLES MAY BE DESIRABLE AT INTERVALS OF APPROXIMATELY 2 VERTICAL FEET TO BIND THE LIFTS TOGETHER AND TO SEAL THE SURFACE OF THE COMPACTED AREAS.
20. ALL BUILDING, SIDEWALK, AND PAVEMENT SUB-GRADE COMPACTIONS SHALL BE INTERMEDIATELY TESTED THROUGHOUT FILL PLACEMENT OPERATIONS AND APPROVED BY THE GEOTECHNICAL ENGINEER. ALL SUB-GRADES SHALL BE THOROUGHLY PROOF-ROLLED TO IDENTIFY SMALL LOCALIZED AREAS OF UNSUITABLE SOILS. ALL UNSUITABLE SOILS SHALL BE UNDERCUT, REPLACED WITH STRUCTURAL FILL, AND COMPACTED AS DESCRIBED ABOVE.
21. WHERE REQUIRED, PAVEMENT SHALL BE SAW CUT IN STRAIGHT LINES, AND EXCEPT FOR EDGE OF BUTT JOINTS, SHALL EXTEND TO THE FULL DEPTH OF THE EXISTING PAVEMENT. ALL DEBRIS FROM REMOVAL OPERATIONS SHALL BE REMOVED FROM THE SITE AT THE TIME OF EXCAVATION. STOCKPILING OF DEBRIS WILL NOT BE PERMITTED.
22. THE TOPS OF EXISTING MANHOLES, INLET STRUCTURES, CLEANOUTS, ETC. SHALL BE ADJUSTED, AS REQUIRED, TO MATCH PROPOSED GRADES.
23. SITE CONTRACTOR SHALL BE REQUIRED TO SECURE ALL NECESSARY PERMITS AND APPROVALS FOR OFF SITE MATERIAL SOURCES AND / OR DISPOSAL FACILITIES. CONTRACTOR SHALL SUPPLY A COPY OF APPROVALS PRIOR TO INITIATING WORK.
24. UNLESS INDICATED OTHERWISE, ALL STORM DRAINAGE PIPE SHALL BE REINFORCED CONCRETE PIPE (RCP) CLASS III WITH SOIL TIGHT JOINTS.
25. CONTRACTOR SHALL INSTALL BUILDING ROOF DRAINS TO WITHIN 2' OF THE BUILDING EXTERIOR WALL AND PROVIDE ABOVE GROUND MARKER FOR LOCATION PURPOSES. GENERAL CONTRACTOR IS RESPONSIBLE FOR TIE-INS OF BUILDING DOWNSPOUTS TO SITE ROOF DRAINAGE PIPING.

| STRUCTURE TABLE | | | | |
|-----------------|--------|-----------------|-----------------|----------------------|
| ID | TOP | IN | OUT | DESC |
| 100-CB | 383.75 | 378.12 (101-CB) | 376.50 (212-CB) | Catch Basin |
| 101-CB | 387.14 | 379.78 (102-CB) | 379.28 (100-CB) | Catch Basin |
| 102-CB | 386.85 | 381.01 (103-CB) | 380.81 (101-CB) | Catch Basin |
| 103-CB | 387.85 | 382.49 (104-CB) | 382.29 (102-CB) | Catch Basin |
| 104-CB | 387.30 | | 382.80 (103-CB) | Catch Basin |
| 212-CB | 380.96 | 376.00 (100-CB) | | Existing Catch Basin |

Abbreviations

| | |
|-----|-----------------------|
| BC | BACK OF CURB |
| TC | TOP OF CONCRETE |
| TA | TOP OF ASPHALT |
| TW | TOP OF WALL |
| BW | BOTTOM OF WALL |
| PG | PROPOSED GRADE/GROUND |
| CB | CATCH BASIN |
| DI | DROP INLET |
| INV | INVERT |
| U/G | UNDERGROUND |

6. LDO Section 6.2.4. Landscaping Standards:-
- 6.2.4.2.9. Note plant spacing and native status.
 - 6.2.4.4.D. Parking Terminal Islands Standards—review compliance with items 3 and 4.
 - 6.2.4.4.F. Parking Divider Medians Standards—review compliance with item 2.

a) VEGETATION LEGEND UPDATED WITH SPACING & NATIVE STATUS

b) LARGE TREE ADDED TO TERMINAL ISLAND.
SHRUBS AND GROUNDCOVER DETAIL ADDED.

c) HIGHLIGHTED PARKING BAY SHIFTED TO REACH 7' MIN.

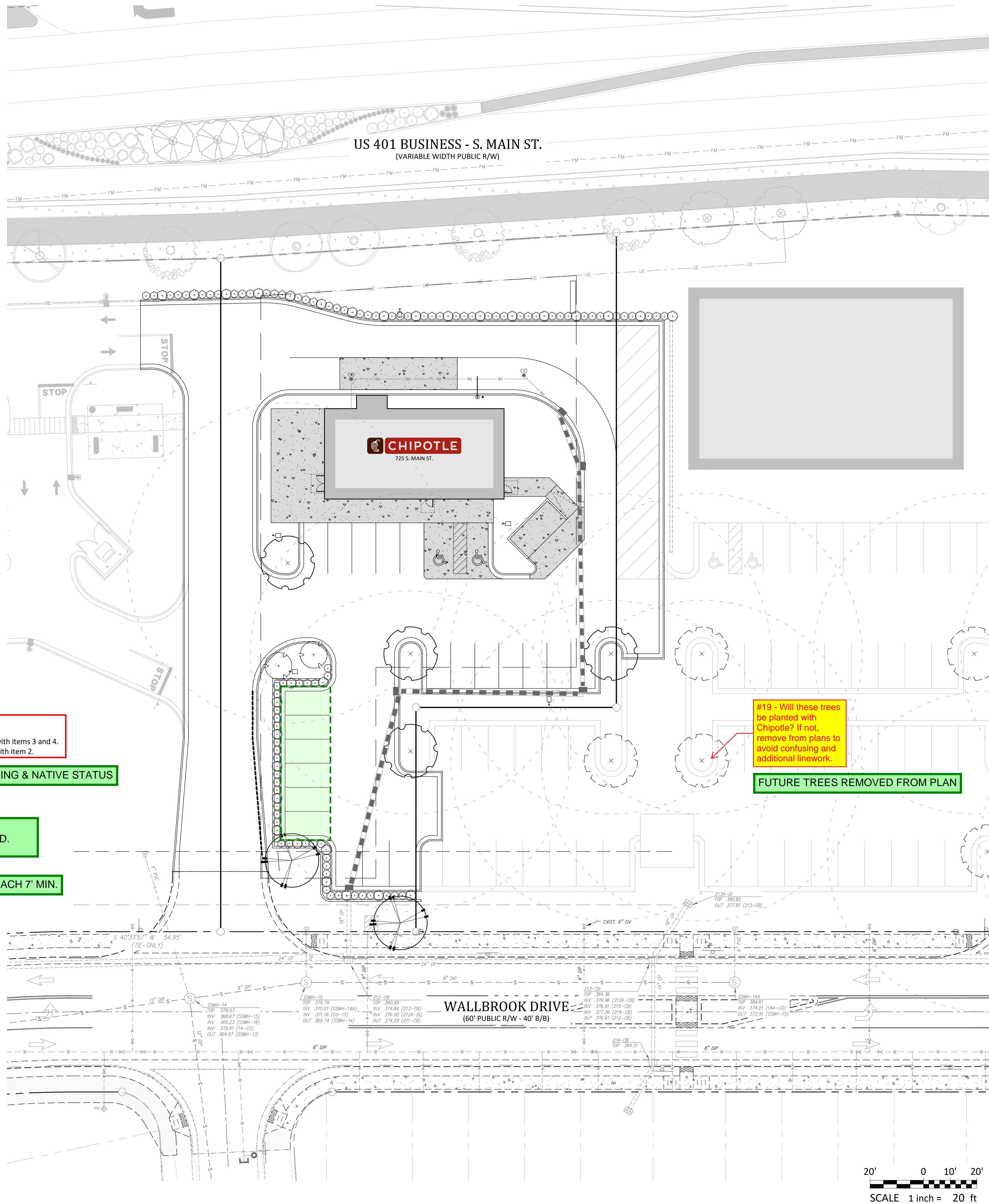

- CONTAINER STOCK: REMOVE CONTAINER AND LOOSEN ROOTBALL PRIOR TO INSTALLATION
- BACKFILL MIXTURE (REFER TO SPECS) PLACE IN 12" LIFTS & THOROUGHLY WATER BETWEEN LIFTS
- TAMP SOIL AROUND ROOT BALL BASE FIRMLY WITH FOOT PRESSURE SO THAT ROOT BALL DOES NOT SHIFT
- EXCAVATE 2X ROOT BALL DIAMETER. PLACE BACKFILL MIXTURE IN 12" LIFTS & THOROUGHLY WATER BETWEEN LIFTS
- SELECTIVELY THIN ALL BRANCHING TO REMOVE DISCOLORED FOLIAGE MAINTAIN PLANT SHAPE
- TRIPLE SHREDDED HARDWOOD BARK MULCH (NON-DYED) MIN 4"D. DO NOT PLACE MULCH IN CONTACT WITH THE TRUNK. TOP OF ROOTBALL SHALL BE 1" - 2" ABOVE SURROUNDING FIN. GRADE
- REMOVE BURLAP FROM TOP 1/3 OF ROOTBALL
- CREATE 3" WATER SAUCER FOR INDIVIDUALLY PLANTED SHRUBS. CREATE MULCHED BEDS FOR MASS PLANTING
- UNDISTURBED SUBGRADE

SHRUB PLANTING

NOT TO SCALE

NOTE:
TREES SHALL BE STAKED ONLY IF DIRECTED BY THE OWNER.

- SET ROOT BALL FLUSH WITH FINISH GRADE
- TRIPLE SHREDDED HARDWOOD BARK MULCH (NON-DYED) MIN 4"D. DO NOT PLACE MULCH IN CONTACT WITH THE TREE TRUNK.
- EXCAVATE 2X ROOT BALL DIAMETER. PLACE BACKFILL MIXTURE IN 12" LIFTS AND THOROUGHLY WATER BETWEEN LIFTS.
- MULCH RING 8" DIA.
- 4" HIGH TOPSOIL SAUCER BEYOND EDGE OF ROOT BALL.
- REMOVE ALL TWINE, ROPE, WIRE AND BURLAP FROM TOP HALF OF THE ROOT BALL.
- IF THE PLANT IS SHIPPED WITH A WIRE BASKET AROUND THE ROOT BALL, CUT THE WIRE BASKET IN FOUR PLACES AND FOLD DOWN 8" INTO PLANTING HOLE.
- PLACE ROOT BALL ON UNEXCAVATED OR TAMPED SOIL.
- TAMP SOIL AROUND ROOT BALL BASE FIRMLY WITH FOOT PRESSURE SO THAT ROOT BALL DOES NOT SHIFT.
- EACH TREE MUST BE PLANTED SUCH THAT THE TRUNK FLARE IS VISIBLE AT THE TOP OF THE ROOT BALL. TREES WHERE THE TRUNK FLARE IS NOT VISIBLE SHALL BE REJECTED. DO NOT COVER THE TOP OF THE ROOT BALL WITH SOIL.

LARGE AND SMALL TREE PLANTING

NOT TO SCALE

Bufferyard Notes:

- SITE DATA:
 - PROVIDED VEGETATION FOR LOT:
LARGE TREES: 6 PROVIDED
 - REQUIRED STREET VEGETATION:
LARGE TREES: S. MAIN STREET = 148 LF / 40' * 1 TREE = 4 TREES (4 PROVIDED BY MAIN STREET IMPROVEMENTS)
WALLBROOK DRIVE = 73 LF / 40' * 1 TREE = 2 TREES (2 PROVIDED)
 - REQUIRED SCREENING VEGETATION: NONE
 - REQUIRED VEGETATION LOCATED IN EASEMENTS: NONE
- NOTES:
 - MINIMUM PLANT SIZES SHALL BE IN ACCORDANCE WITH THE SECTION 6.2.4.3 OF THE LDO AS FOLLOWS:

| PLANTING MATERIAL TYPE | MINIMUM PLANTING SIZE |
|-----------------------------------|--|
| 1. LARGE (CANOPY) TREE | 8" (HEIGHT) AND 2" CALIPER |
| 2. SMALL/MEDIUM (UNDERSTORY) TREE | 8" (HEIGHT) AND 1" CALIPER |
| 3. SHRUB | 24" (HEIGHT) - EVERGREEN 18" (HEIGHT) - DECIDUOUS |
 - NO PORTION OF ANY PARKING SPACE SHALL BE LOCATED MORE THAN SIXTY (60) FEET FROM AN ON-SITE LARGE (CANOPY) TREE. FOR PURPOSES OF THIS SECTION, THE MEASUREMENT SHALL BE FROM THE CLOSEST EDGE OF THE SUBJECT AREA TO THE CENTER OF THE BASE OF THE CLOSEST QUALIFYING TREE IN ACCORDANCE WITH SECTION 6.2.4.4 OF THE LDO.
 - DUMPSTER/COMPACTOR SHALL BE SCREENED ON 3 SIDES IN ACCORDANCE WITH SECTION 6.2.4.6 OF THE LDO.
 - NO TREES OR SHRUBS SHALL BE PLANTED WITHIN SANITARY SEWER, WATERLINE OR ELECTRIC EASEMENTS WITHOUT THE TOWN AND EASEMENT HOLDER APPROVAL.
 - ALL MULTI-STEM TREES SHALL HAVE AT LEAST THREE STALKS WITH A MINIMUM CALIPER OF 2.5" IN ACCORDANCE WITH SECTION 6.2.4.7 OF THE LDO.
 - LANDSCAPING SHALL BE COMPLIANT WITH LDO SECTION 6.2.4
 - MINIMUM OF 3 FEET CLEARANCE MUST BE MAINTAINED AROUND ALL FIRE HYDRANTS IN ACCORDANCE WITH STATE BUILDING CODE.
 - PLANTINGS WITHIN THE R/W ARE TO BE INSTALLED AS PART OF THE MAIN STREET PROJECT (NCDOT U-6241). SEE STANTEC PLAN SHEET L-4.
 - REFER TO WALLBROOK PRELIMINARY PLAT (PR 21-04 REV) FOR VEGETATION PRESERVATION IN THIS AREA.
 - CONTRACTOR SHALL PLACE WEED MATTING AND METAL EDGING LOCATED AT THE BACK OF CURB AROUND ALL MULCH BEDS

Vegetation Legend:

- PROPOSED LARGE TREE (CANOPY)
TOTAL QUANTITY = 4
CALIPER = 3"
HEIGHT = 12"
MATURE HEIGHT = 50' - 80'
COMMON NAME: RED MAPLE
BOTANICAL NAME: ACER RUBRUM
- PROPOSED LARGE TREE (CANOPY)
TOTAL QUANTITY = 2
CALIPER = 3"
HEIGHT = 15"
MATURE HEIGHT = 50' - 80'
COMMON NAME: WHITE OAK
BOTANICAL NAME: QUERCUS ALBA
- PROPOSED SHRUB(S)
TOTAL QUANTITY = 88
HEIGHT = 24"
MATURE HEIGHT = 24" - 36"
COMMON NAME = GREY OWL, EASTERN RED CEDAR
BOTANICAL NAME = JUNIPERUS VIRGINIANA 'GREY OWL'
- PROPOSED SHRUB(S)
TOTAL QUANTITY = 30
HEIGHT = 24"
MATURE HEIGHT = 24" - 36"
COMMON NAME = BLUEBEARD
BOTANICAL NAME = CARYOPTERIS X CLANDONENSIS

REQUIRED VEGETATION PLAN CHIPOTLE AT WALLBROOK (LOT 5B)

Town of Rolesville Project No. SDP 25-03

Wake Forest Township, Town of Rolesville, Wake County, North Carolina

NC License: PL 1199
ARK CONSULTING GROUP PLLC
ENGINEERS & SURVEYORS
925-A Conference Drive
Charlotte, NC 28202
(704) 558-0888
www.arkconsultinggroup.com

PRELIMINARY
Do Not Use
for Construction
1/11/2025

Project Manager: BCF
Drawn By: DLC
Checked By: BCF
Project Number: 24138
Drawing Number: D-1592

C5.0

Date: July 1, 2025



REVISIONS:

| # | DATE | DESCRIPTION |
|---|----------|--------------------------|
| 1 | 1-JUL-25 | SUBMIT FOR PERMIT REVIEW |



-

NOT TO SCALE

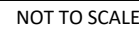
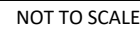
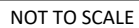
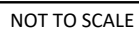

1. CONTRACTION JOINTS SHALL BE SPACED AT 10' INTERVALS, EXCEPT THAT A 15" SPACING MAY BE USED WHEN A MACHINE IS USED OR WHEN SATISFACTORY SUPPORT FOR THE FACE CAN BE MAINTAINED WITHIN THE SPACING OF 15' INTERVALS. JOINT SPACING MAY BE ALTERED BY THE ENGINEER TO PREVENT UNCONTROLLED CRACKING.
2. CONTRACTION JOINTS MAY BE INSTALLED BY THE USE OF TEMPLATES OR FORMED BY OTHER APPROVED METHODS, WHEN SUCH METHODS ARE NOT FORMED BY TEMPLATES, A MINIMUM DEPTH OF 1 1/2" SHALL BE OBTAINED.
3. ALL CONTRACTION JOINTS SHALL BE FILLED WITH JOINT FILLER.
4. EXPANSION JOINTS SHALL BE SPACED AT 90' INTERVALS, AND ADJACENT TO ALL RIGID OBJECTS.
5. ALL CURB AND GUTTERS ARE TO BE POURED WITH CLASS "A" CONCRETE. (3000 PSI)
6. FLEXIBLE FORMS ARE TO BE USED WHEN RADII IS LESS THAN 200.

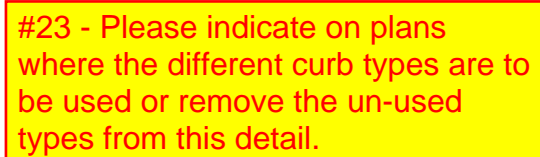

CONCRETE VALLEY GUTTER

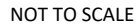
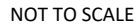

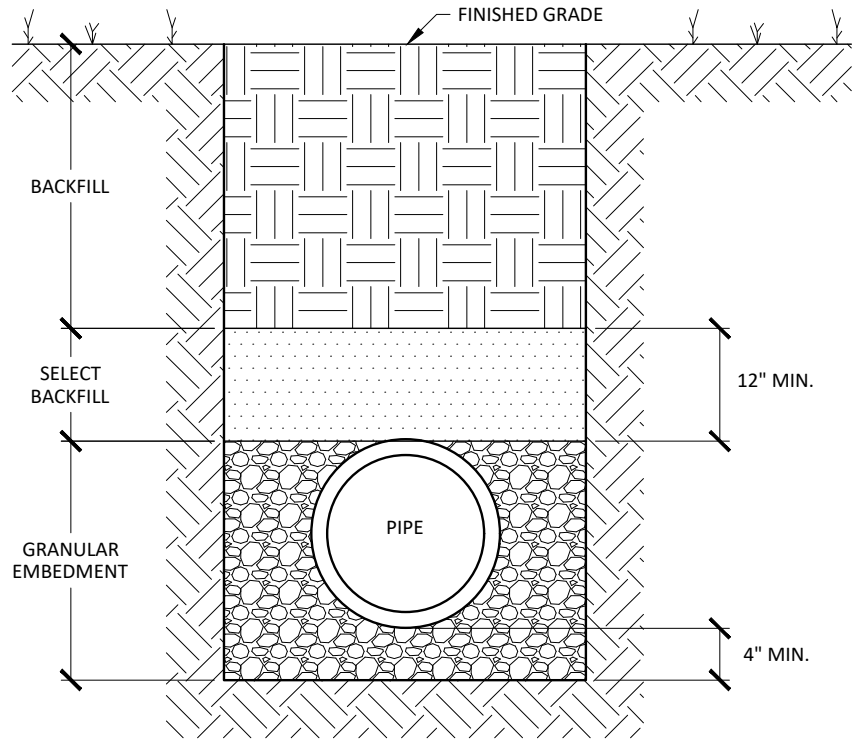
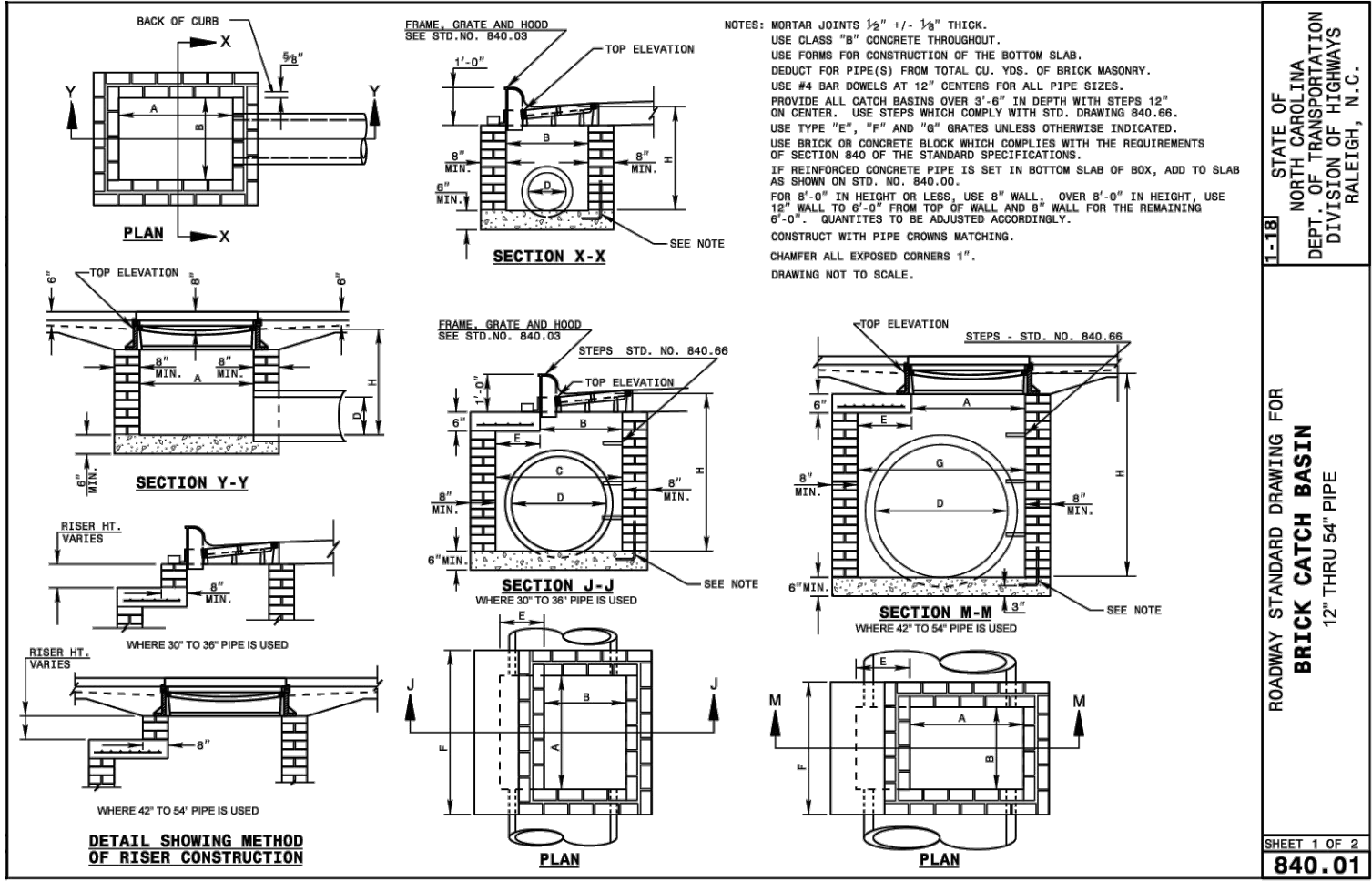

TRENCH SECTION DETAIL FOR THE INSTALLATION OF PVC GRAVITY STORM DRAIN & SANITARY SEWER PIPING

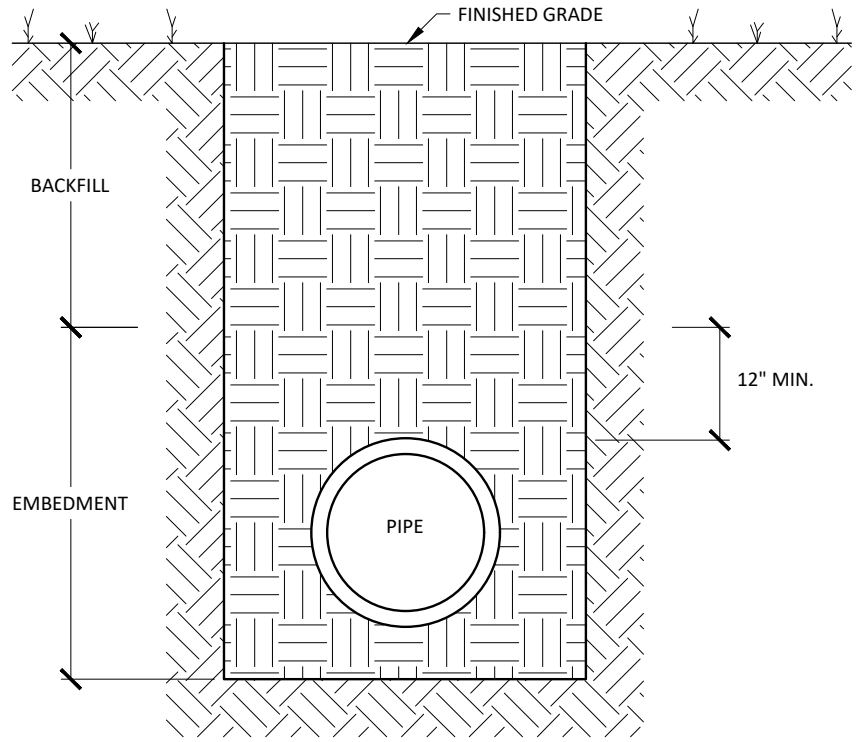
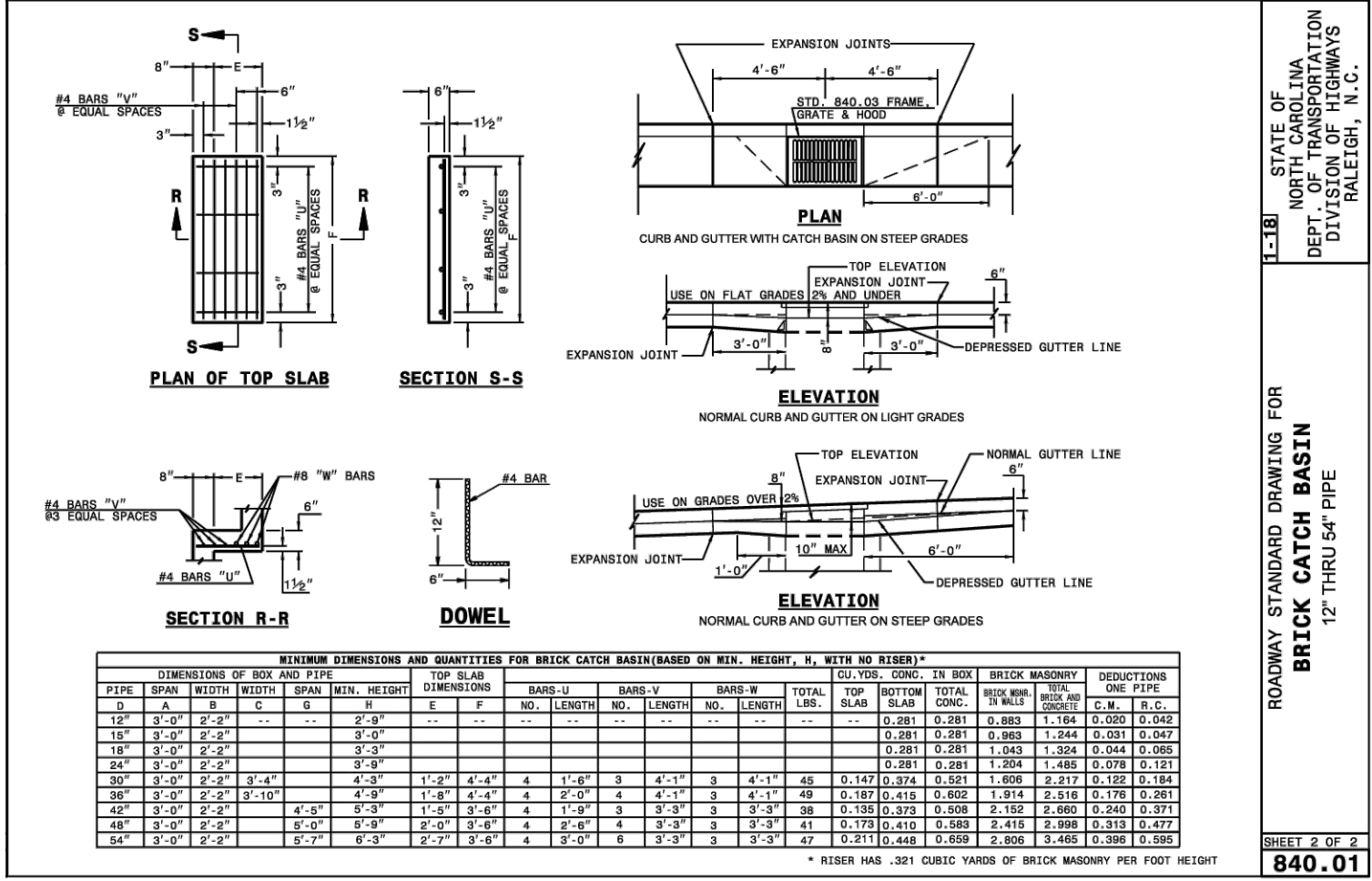

TRENCH SECTION FOR THE INSTALLATION OF REINFORCED CONCRETE PIPE

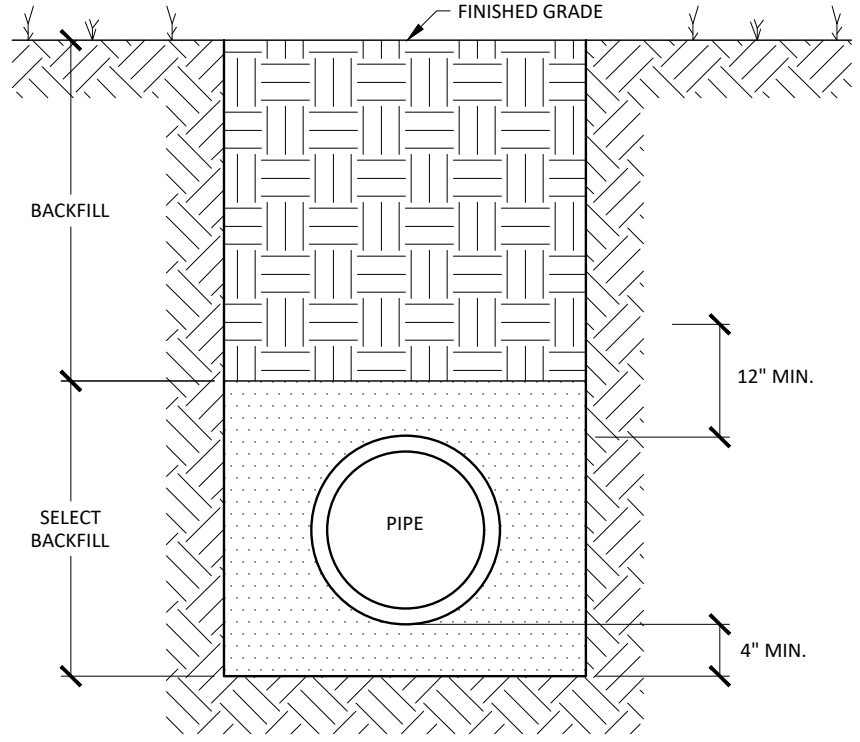
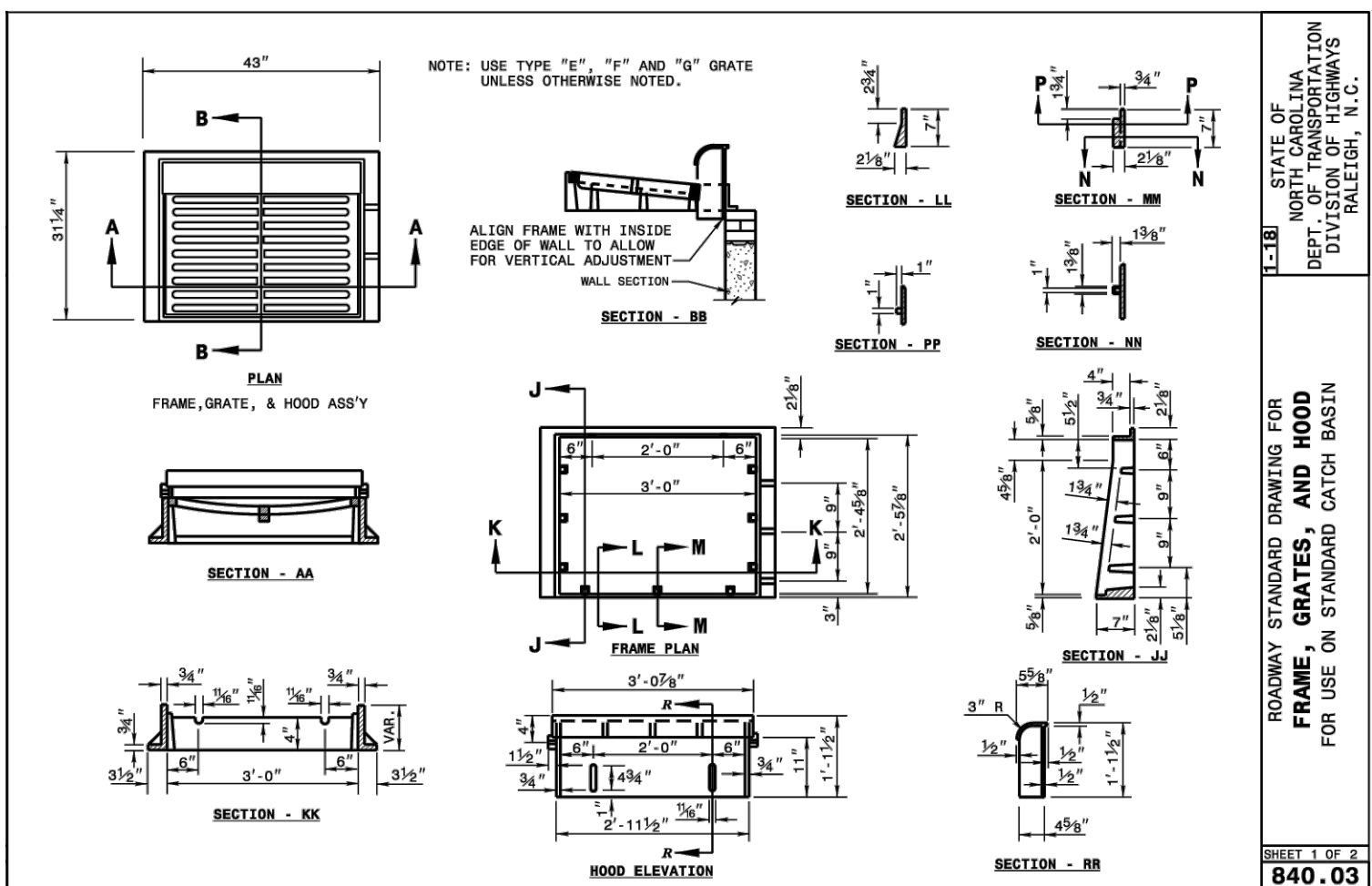

TRENCH SECTION DETAIL FOR THE INSTALLATION OF PVC PRESSURE PIPE

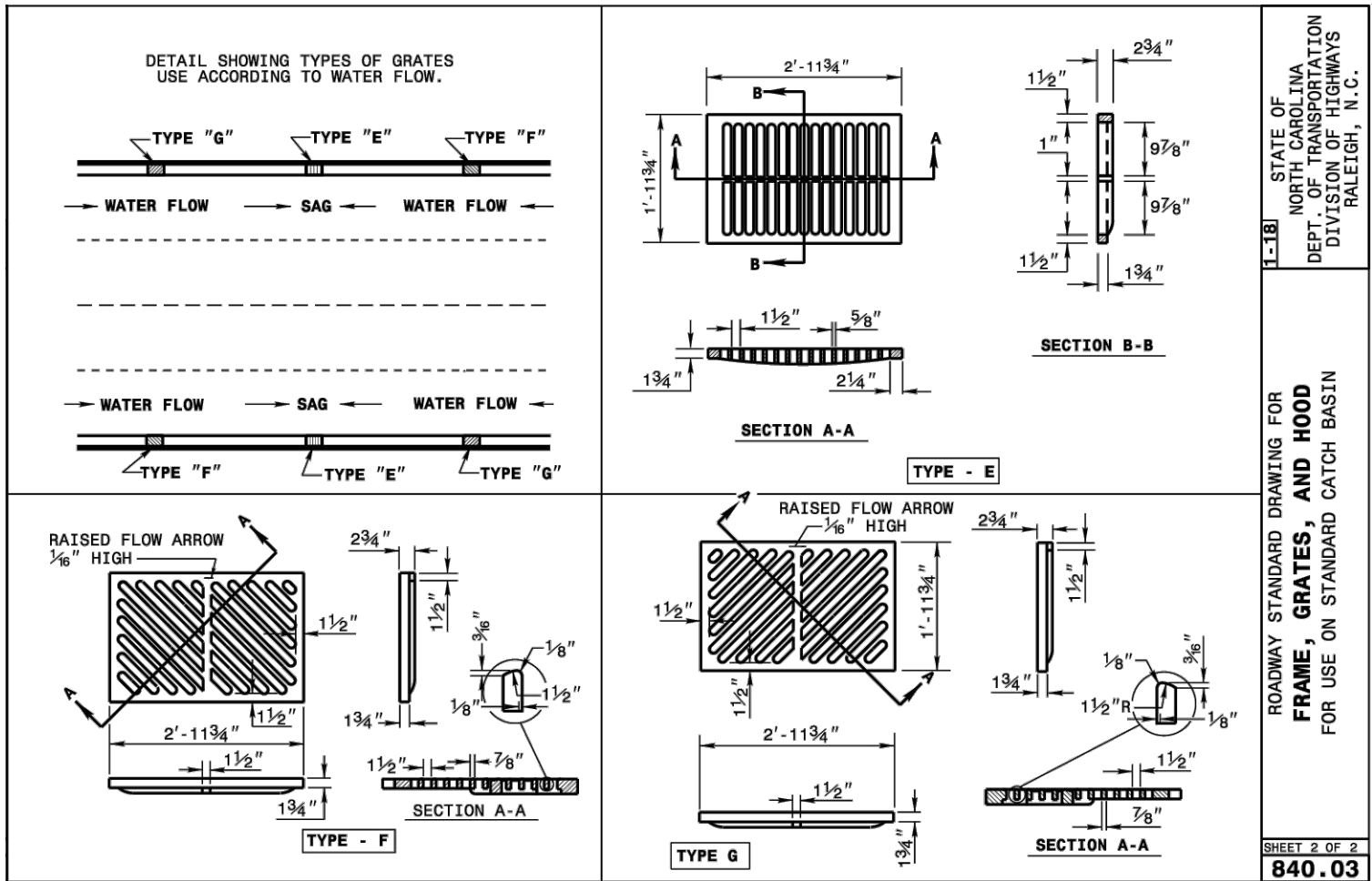

REVISIONS:

1

1 JUL 25

SUBMIT FOR PERMIT REVIEW

DATE

CHIPOTLE

CROSLAND SOUTHEAST

CORE SOUND

MISC. DETAILS

CHIPOTLE AT WALLBROOK (LOT 5B)

Town of Rolesville Project No. SDP 25-03

Wake Forest Township, Town of Rolesville, Wake County, North Carolina

NC License: P-1129

ARK CONSULTING GROUP PLLC

ENGINEERS & SURVEYORS

935-A Conference Drive

Greensboro, NC 27406

(353) 559-0888

www.arkconsultinggroup.com

PRELIMINARY

Do Not Use for Construction

7/1/2025

Project Manager: BCF

Drawn By: DLC

Checked By: BCF

Project Number: 24138

Drawing Number: D-1592

C6.2

Date: July 1, 2025

JAN2025M

Failure to call for inspection, install a downstream plug, have permitted plans on the jobsite, or any other violation of Raleigh Water Standards will result in a fine and possible exclusion from future work in the City of Raleigh.

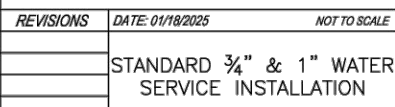
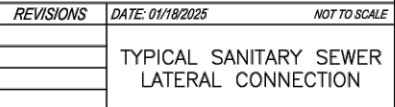
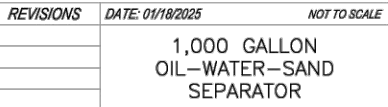
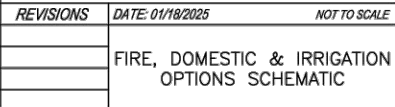
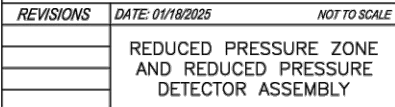

| | | |
|-----------|---|--------------|
| REVISIONS | DATE: 01/18/2025 | NOT TO SCALE |
| | DIMENSIONS: GREASE INTERCEPTORS & OIL-WATER SAND SEPARATORS | |

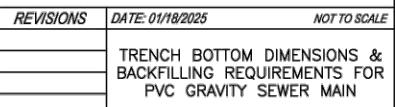
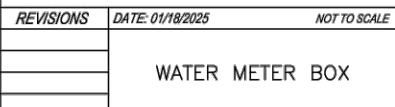
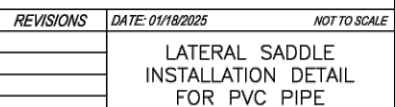

Wake Forest Township, Town of Rolesville, Wake County, North Carolina

www.arkconsultinggroup.com

Date: July 1, 2025