

I, MICHAEL A. MOSS CERTIFY THAT THIS PLAT WAS DRAWN UNDER MY SUPERVISION FROM AN ACTUAL SURVEY PERFORMED UNDER MY SUPERVISION FROM REFERENCES AS NOTED HEREON; THAT THE BOUNDARIES NOT SURVEYED ARE CLEARLY INDICATED AS DRAWN FROM INFORMATION SHOWN IN THE REFERENCES; THAT HORIZONTAL POSITIONAL ACCURACY AS CALCULATED .05"; THAT THE GLOBAL NAVIGATION SATELLITE SYSTEM(GNSS) SURVEY OBSERVATIONS WERE PERFORMED TO THE GEOSPATIAL POSITIONAL ACCURACY STANDARDS, PART 2: STANDARDS FOR GEODETIC NETWORKS AT THE 1-CENTIMETER ACCURACY CLASSIFICATION (95% CONFIDENCE) USING REAL TIME KINEMATIC FIELD PROCEDURES; THAT THIS PLAT WAS PREPARED IN ACCORDANCE WITH G.S. 47-30 AS AMENDED. WITNESS MY ORIGINAL SIGNATURE, LICENSE NUMBER AND SEAL.

THIS PLAT WAS PREPARED IN ACCORDANCE WITH G.S. 47-30 AS AMENDED, WITNESS MY ORIGINAL SIGNATURE, LICENSE NUMBER AND SEAL.

THIS \_\_\_\_\_ DAY OF \_\_\_\_\_ A.D. 2023.

PROFESSIONAL LAND SURVEYOR L-3794 LICENSE NUMBER

THAT THE SURVEY IS OF ANOTHER CATEGORY, SUCH AS THE RECOMBINATION OF EXISTING PARCELS, A COURT-ORDERED SURVEY OR OTHER EXEMPTION OR EXCEPTION TO THE DEFINITION OF SUBDIVISION.

PROFESSIONAL LAND SURVEYOR L-3794 LICENSE NUMBER

CLASS OF SURVEY: AA  
 POSITIONAL ACCURACY: HORIZONTAL 0.05 US SURVEY FEET  
 TYPE OF GPS FIELD PROCEDURE: REAL TIME KINEMATICS NETWORK (VRS)  
 DATES OF SURVEY:  
 DATUM/EPOCH: NAD 83(2011) 2010 00  
 PUBLISHED/FIXED CONTROL USE: RALEIGH DOT CORS ARP  
 LAT: 35°45'49.50795"  
 LONG: 78°34'44.39448"  
 GEIOD MODEL: GEOID12B  
 COMBINED GRID FACTORS: 1.00007411132077  
 UNITS: US SURVEY FOOT

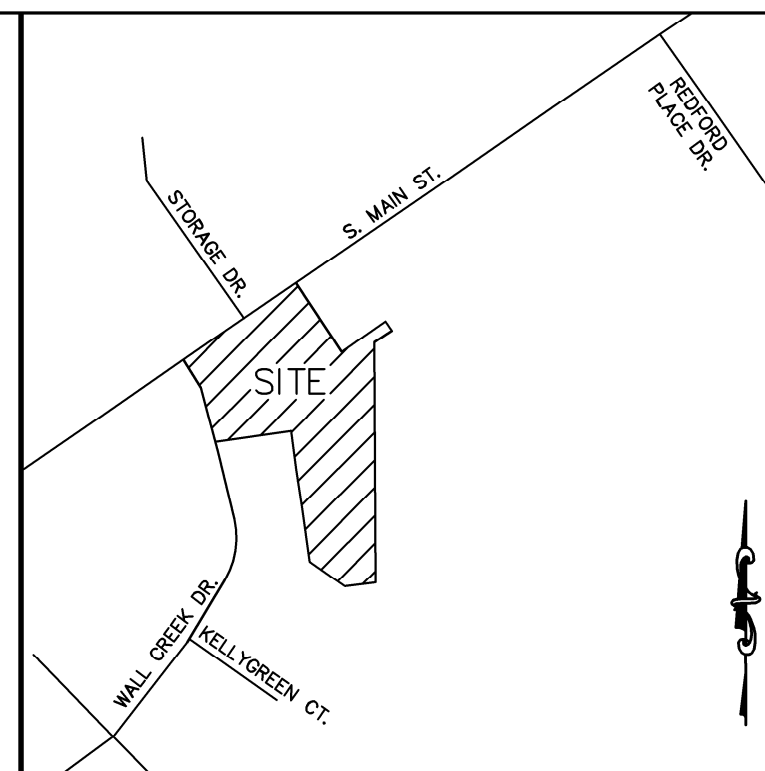

VICINITY MAP

**LEGEND:**

- EIP - EXISTING IRON PIPE
- EIB - EXISTING IRON BAR
- BEIP - BENT IRON PIPE
- BEIB - BENT IRON BAR
- CM - CONCRETE MONUMENT
- EPK - EXISTING PK NAIL
- SPK - SET PK NAIL
- NIP - NEW IRON PIPE SET
- R/W - RIGHT OF WAY
- CATV - CABLE TV BOX
- EB - ELECTRIC BOX
- TEL - TELEPHONE PEDESTAL
- PP - POWER POLE
- OHL - OVERHEAD LINE
- LP - LIGHT POLE
- WM - WATER METER
- WV - WATER VALVE
- CO - SEWER CLEAN-OUT
- CC - CONCRETE
- CB - CATCH BASIN
- MH - MANHOLE
- FH - FIRE HYDRANT

**SITE DATA**

OLD LOT 3 TOTAL AREA - (PER B.M. 2013, PG. 1030)	3.21 AC.
LESS AREA -	0.234 AC.
<b>NEW REMAINING AREA</b>	<b>2.976 AC.</b>
OLD LOT 4 TOTAL AREA -	1.800 AC.
PLUS PORTION OF OLD LOT 3 -	0.234 AC.
<b>NEW LOT 4 AREA</b>	<b>2.034 AC.</b>

RESIDENTIAL LOW DENSITY (RL) MINIMUM BUILDING SETBACKS	GENERAL COMMERCIAL (GC) MINIMUM BUILDING SETBACKS
FRONT 30'	FRONT 20'
20'(CLUSTER)	SIDE 15'
SIDE 12'	REAR 35'
5'(CLUSTER)	CORNER 25'
REAR 25'	WIDTH(MIN) 100'
20'(CLUSTER)	
CORNER 17'	
10'(CLUSTER)	
WIDTH(MIN) 100'	
50'(CLUSTER)	

**IMPERVIOUS SURFACE TABLE**

CONCRETE SLAB	1,135 S.F.
CONCRETE DRIVEWAY/PARKING	3,012 S.F.
RETAINING WALL	163 S.F.
<b>TOTAL IMPERVIOUS AREA</b>	<b>4,310 S.F.</b>
<b>TOTAL LOT AREA</b>	<b>88,808 S.F.</b>
<b>PERCENTAGE OF IMPERVIOUS AREA -</b>	<b>4.86%</b>

**NOTES:**

- 1) AREA COMPUTED BY COORDINATE METHOD.
- 2) THERE IS NO NCGS MONUMENT WITHIN 2000' OF THIS PROPERTY.
- 3) NORTH ROTATION WAS OBTAINED VIA NC-VRS.
- 4) IMPROVEMENTS ON LOT 3 ARE NOT FIELD LOCATED.

**LINE TYPE LEGEND**

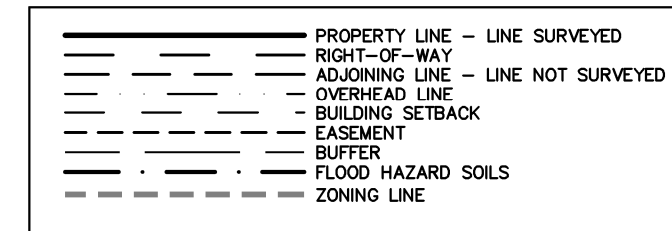

I HEREBY CERTIFY THAT I AM THE OWNER OF THE PROPERTY SHOWN AND DESCRIBED HEREON, WHICH IS LOCATED IN THE SUBDIVISION JURISDICTION OF THE TOWN OF ROLESVILLE AND THAT I HEREBY ADOPT THIS PLAN OF SUBDIVISION WITH MY FREE CONSENT, ESTABLISH MINIMUM BUILDING SETBACK LINES, AND DEDICATE ALL STREETS, ALLEYS, WALKS, PARKS, AND OTHER SITES AND EASEMENTS TO PUBLIC OR PRIVATE USE AS NOTED. FURTHERMORE, I HEREBY DEDICATE ALL SANITARY SEWER, STORM SEWER AND WATER LINES TO THE TOWN OF ROLESVILLE.

OWNER (TOY STORAGE, LLC) DATE

OWNER (STORAGE MAX VIII, LLC) DATE

ROLESVILLE, NORTH CAROLINA

I, \_\_\_\_\_, REVIEW OFFICER OF THE TOWN OF ROLESVILLE, WAKE COUNTY, CERTIFY THAT THE MAP OR PLAT TO WHICH THIS CERTIFICATION IS AFFIXED MEETS ALL STATUTORY REQUIREMENTS FOR RECORDING.

DATE REVIEW OFFICER

CERTIFICATE OF APPROVAL FOR RECORDING

I HEREBY CERTIFY THAT THE SUBDIVISION PLAT SHOWN HEREON HAS BEEN FOUND TO COMPLY WITH THE SUBDIVISION REGULATIONS OF THE TOWN OF ROLESVILLE, NORTH CAROLINA AND THAT THIS PLAT HAS BEEN APPROVED BY THE SUBDIVISION ADMINISTRATOR OF THE TOWN OF ROLESVILLE FOR RECORDING IN THE OFFICE OF THE REGISTER OF DEEDS OF WAKE COUNTY.

DATE SUBDIVISION ADMINISTRATOR, TOWN OF ROLESVILLE ROLESVILLE, NORTH CAROLINA

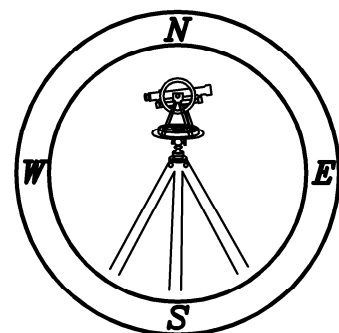

PROFESSIONAL LAND SURVEYORS, C-1525, 333 S. WHITE STREET, P.O. BOX 1253, WAKE FOREST N.C., 27588, (919) 556-3148

LINE	BEARING	DISTANCE
L-1	S 82°46'12" E	69.41'
L-2	N 55°19'04" E	68.15'
L-3	S 34°38'09" E	31.19'
L-4	S 55°23'33" W	59.56'
L-5	N 14°42'54" W	17.87'

CURVE	ARC LENGTH	RADIUS	CHORD LENGTH	CHORD BEARING
C-1	86.82'	340.00'	86.58'	N 21°57'55" W
C-2	37.12'	25.00'	33.80'	N 13°06'36" E

NO.	DATE	DESCRIPTION
1	01/13/23	V1 REVIEW COMMENTS
2	09/21/23	V2 REVIEW COMMENTS

(X: \PROJECTS\NMAIN503-TOY STORAGE - J)