

Y:\902154832-Wake Self Storage\DWG\54832V.XPSURV_REV.dwg | Plotted on 11/15/2023 2:07 PM | by Giovanni Canuto

| CURVE TABLE | | | | |
|-------------|--------|--------|---------------|--------|
| CURVE | RADIUS | LENGTH | CHORD BEARING | CHORD |
| EC1 | 42.00' | 68.68' | S87°29'06"W | 61.28' |
| EC2 | 20.50' | 32.20' | S89°19'41"W | 28.99' |
| EC3 | 40.50' | 63.62' | N89°19'41"E | 57.28' |
| EC4 | 22.00' | 36.00' | N87°26'58"E | 32.12' |

| LINE TABLE | | |
|------------|-------------|---------|
| LINE | BEARING | LENGTH |
| E1 | S44°21'27"W | 3.25' |
| E2 | S40°49'45"W | 22.66' |
| E3 | N45°40'19"W | 73.09' |
| E4 | S44°19'41"W | 406.50' |
| E5 | N45°40'19"W | 14.20' |
| E6 | S44°19'41"W | 2.41' |
| E7 | S44°19'41"W | 27.18' |
| E8 | S40°29'07"W | 2.33' |
| E9 | S45°40'19"E | 1.33' |
| E10 | S45°40'19"E | 218.44' |
| E11 | S44°19'41"W | 34.50' |
| E12 | N89°36'23"W | 9.22' |
| E13 | N89°36'23"W | 141.92' |
| E14 | N89°36'40"W | 127.52' |
| E15 | N0°30'50"W | 21.20' |
| E16 | N24°06'37"E | 24.43' |
| E17 | N32°37'59"E | 59.62' |
| E18 | N32°25'43"E | 182.04' |
| E19 | S45°13'47"E | 36.10' |
| E20 | S45°40'19"E | 11.85' |
| E21 | N44°19'41"E | 392.09' |
| E22 | S45°40'19"E | 73.09' |
| E23 | N40°49'45"E | 23.32' |
| E24 | N44°21'27"E | 2.54' |
| E25 | S49°26'01"E | 20.04' |
| E26 | S40°43'30"W | 4.00' |
| E27 | S49°26'01"E | 4.00' |
| E28 | S40°43'30"W | 4.00' |
| E29 | S49°26'01"E | 4.00' |

Area Table
Old Area = 5.50 Acres
New Lot = 5.31 Acres
R/W Dedication = 0.19 Acre

Notary Statement:
State of North Carolina
Town of Rolesville

I certify that the following person(s) personally appeared before me this day, each acknowledging to me that he or she voluntarily signed the foregoing document for the purpose stated therein and in the capacity indicated:

Date _____, 20____.

Notary Public (printed name)

Notary Public (signature)

my commission expires: _____

Owners Certificate:

This certifies and warrants that the undersigned is (are) the sole owner(s) of the property shown on the map or plat and any accompanying sheets having acquired the property in fee simple by deed(s) recorded in the county register of deeds office where the property is located and as such has (have) the right to convey the property in fee simple.

Book No.: _____

Page No.: _____

Signature(s) & title/position of property owner(s):

**State of North Carolina
County of Wake**

I, _____, review officer of Wake County, certify that this map or plat to which this certification is affixed meets all statutory requirements for recording.

Review Officer

Date

V1 - FSP-23-18 -
Jones Dairy
Storage

References
DB 3539 PG 26
DB 6397 PG 408
DB 15069 PG 36
DB 15206 PG 47
DB 15456 PG 2377
DB 15533 PG 1116
DB 15682 PG 1743
DB 15766 PG 670
DB 16276 PG 328
DB 16453 PG 1779
DB 17492 PG 2660
DB 18060 PG 336
BM 1990 PG 1413
BM 1994 PG 1943
BM 2007 PG 2000

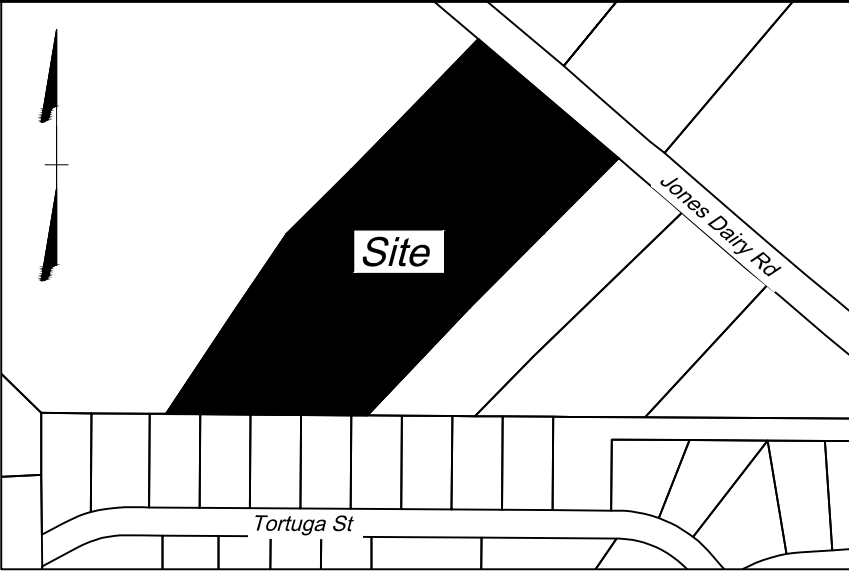

Survey Notes:

- Prepared for Rivercrest Realty Investors.
- This property lies in Zone X, not a special flood hazard area, per FIRM #3720185000K, PANEL 1850, effective date July 19, 2022.
- Horizontal control is based on NC State GRID, NAD'83 (2011) as determined by GPS. All distances shown are ground distances.
- Area computation is by the coordinate method.
- Names of adjoining owners shown, based on public record, tax records and/or deeds, as of the original date of this plat.
- This survey does not verify the existence of, nor certify the location of, any jurisdictional wetlands, stream buffers or any other environmental feature that may exist on this property.
- This survey was prepared without the benefit of a title search. Other easements may exist on this site.
- Right-of-Way and property boundary information is based on deeds and plats or record and an actual field survey performed by this firm.
- Property shown hereon is subject to all rights-of-way, easements and restrictions of record.

Surveyors Certificate

I, Martin W. Webb, PLS hereby certify that this plat was drawn under my supervision from an actual survey made under my supervision from references as noted on said map; that the boundaries not surveyed are clearly indicated as dashed lines, and drawn from information as indicated under references; that the ratio of precision as calculated is greater than 1:10,000+; that this plat was prepared in accordance with g.s. 47-30, as amended.
the following information was used to perform gps survey:
(1) class of survey: "class a"
(2) positional accuracy: 0.07'
(3) type of gps field procedure: NCVRS
(4) date of survey: 2/23/2023
(5) datum/epoch: nad83 (2011) - epoch 2010.00
(6) published/fixed-control use: NCVRS
(7) geoid model: 18b
(8) combined grid factor(s): 0.99994658
(9) units: US Survey Feet

That the survey is of another category, such as the recombination of existing parcels, a court - ordered survey, or other exemption or exception to the definition of subdivision.

**PRELIMINARY - NOT FOR SALES,
RECORDATION OR CONVEYANCES**

Right-of-Way Dedication & Easement Plat
prepared for
Rivercrest Realty Investors
Owner: Suzanne Shoaf Ward
DB 15069 PG 36
PIN: 1850608722
Jones Dairy Road
Wake Forest, North Carolina

| | |
|---------------------------------|---------------------|
| Wake Forest Township | Wake County |
| Date: 11/15/2023 | Scale: 1" = 60' |
| Sheet 1 of 1 | J.N.: 54832 |
| Drawn by: GC | PLS Checked by: MWW |
| Field Edit by: DM on 2/23/2023 | |
| Map Checked by: GC on 2/28/2023 | |
| Revisions: | |

THIS DRAWING PREPARED AT THE
RALEIGH OFFICE
5410 TRINITY ROAD, Suite 102, J. RALEIGH, NC 27607
TEL 919.866.4951 FAX 919.859.5663 www.timmons.com
NORTH CAROLINA LICENSE NUMBER C-1652

YOUR VISION ACHIEVED THROUGH OURS.

Technology
Infrastructure
Residential
Site Development

TIMMONS GROUP

Legend

- IPF - Iron Pipe Found
- NF - Nail Found
- CMF - Concrete Monument Found
- IRS - Capped 5/8" Iron Rebar Set
- Computed Point
- SF - Square Footage

- Surveyed Property Line
- Property Line to be Removed
- Line Not Surveyed
- Access Easement Line
- Water Easement Line
- Right of Way Line
- Edge of Pavement

Scale 1" = 60'
0' 60' 120'