

V2 - FSP-23-04

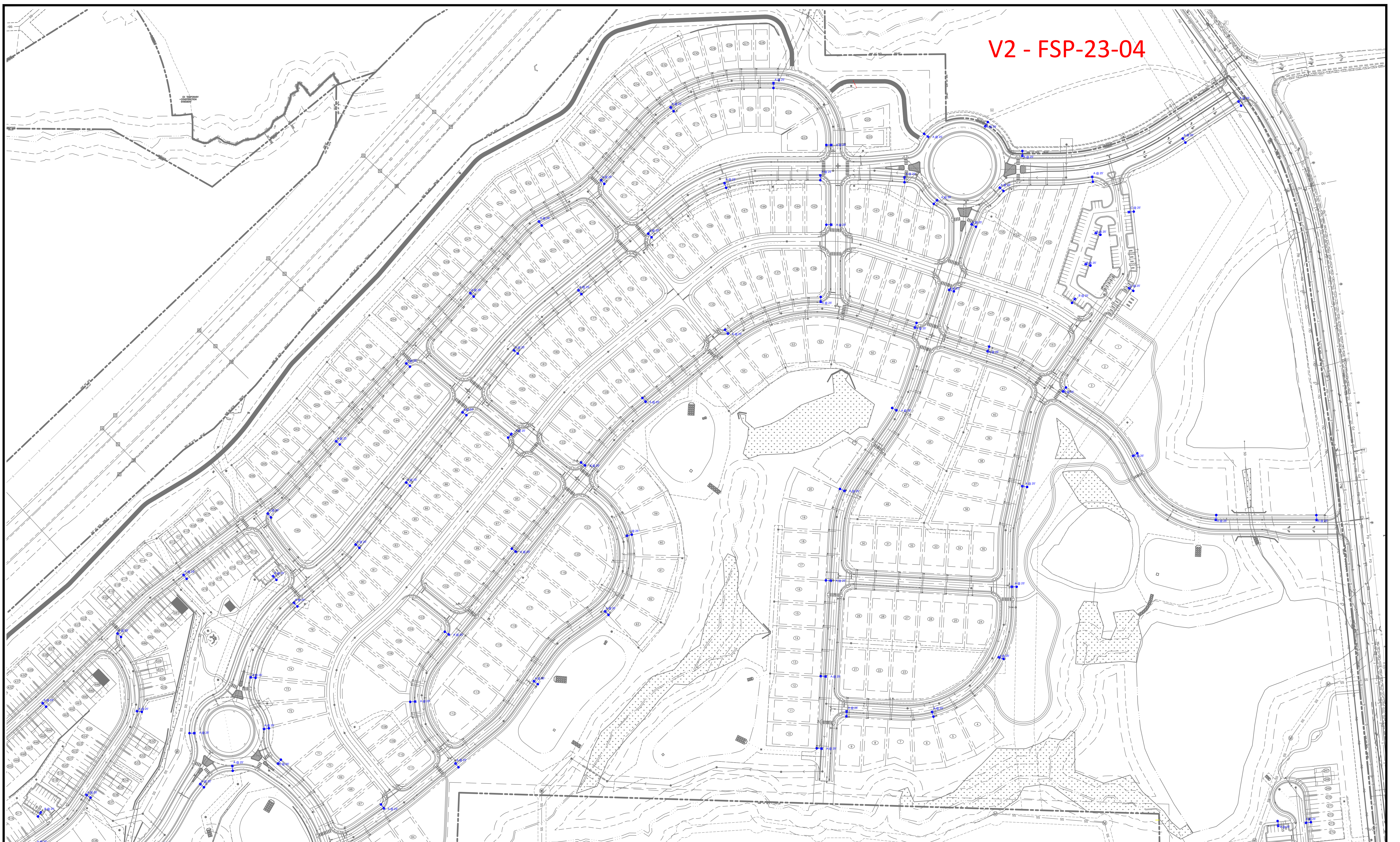

REV#	DATE	REVISION	BY
Rev A	02/08/22	LED Roadway - Gray	NJ

Customer approval _____
Date _____

DISTANCE CALIBRATION (INCHES)

LIGHTING DESIGN TOLERANCE

The calculated footcandle light levels in this lighting design are predicted values and are based on specific information that has been supplied to Duke Energy. Any inaccuracies in the supplied information, differences in luminaire installation, sighted area geometry including elevation differences, reflective properties of surrounding surfaces, obstructions (foliage or otherwise) in the lighted area, or lighting from sources other than listed in this design may produce different results from the predicted values. Normal tolerances of voltage, lamp output, and ballast and luminaire manufacture will also affect results.



PROPRIETARY & CONFIDENTIAL

This document together with the concepts and designs presented herein, presented as an instrument of service, is the sole property of Duke Energy, and is intended only for the specific purpose and prospective client as stated in the title block of this drawing. Any use, copying, reproduction or disclosure of the drawing, design or any information contained herein by the prospective customer or other entities, including without limitation, architects, engineers, or equipment manufacturers is hereby expressly prohibited and shall not be permitted absent prior written consent from, and payment of compensation to Duke Energy. Duke Energy disclaims any liability or responsibility for any unauthorized use of or reliance on this document.

THE POINT
Rolesville, NC
SITE LIGHTING PLAN

Designed by DEP LIGHTING SOLUTIONS
Reviewed by N. Johnson Scale 1" = 100'
Date 02/08/2022 Size "Arch D"
Description LED 50w & 150w Roadway
Drawing No. 22-0042A Sht. 1 OF 3



Rev A	02/08/22	LED Roadway - Gray	NJ
REV#	DATE	REVISION	BY

Customer approval _____
Date _____

DISTANCE CALIBRATION (INCHES)

LIGHTING DESIGN TOLERANCE
The calculated footcandle light levels in this lighting design are predicted values and are based on specific information that has been supplied to Duke Energy. Any inaccuracies in the supplied information, differences in luminaire installation, lighted area geometry including elevation differences, reflective properties of surrounding surfaces, obstructions (foliage or otherwise) in the lighted area, or lighting from sources other than listed in this design may produce different results from the predicted values. Normal tolerances of voltage, lamp output, and ballast and luminaire manufacture will also affect results.

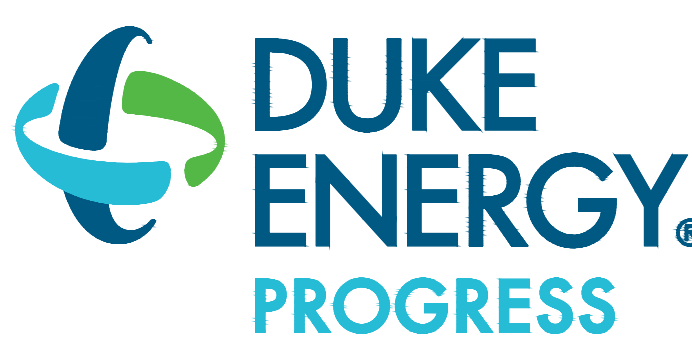

PROPRIETARY & CONFIDENTIAL
This document together with the concepts and designs presented herein, presented as an instrument of service, is the sole property of Duke Energy, and is intended only for the specific purpose and prospective client as stated in the title block of this drawing. Any use, copying, reproduction or disclosure of the drawing, design or any information contained herein by the prospective customer or other entities, including without limitation, architects, engineers, or equipment manufacturers is hereby expressly prohibited and shall not be permitted absent prior written consent from, and payment of compensation to Duke Energy. Duke Energy disclaims any liability or responsibility for any unauthorized use of or reliance on this document.

THE POINT	
Rolesville, NC	
SITE LIGHTING PLAN	
Designed by	DEP LIGHTING SOLUTIONS
Reviewed by	N. Johnson Scale 1" = 100'
Date	02/08/2022 Size "Arch D"
Description	LED 50w & 150w Roadway
Drawing No.	22-0042A Sht. 2 OF 3



Outdoor Lighting
Roadway LED



The Roadway LED is a green solution and great fit for streets, roads, long, narrow areas and parking lots. This energy-efficient luminaire delivers the light where it is needed while increasing visibility and reducing spill light to adjoining properties. Choose low to medium light output on wood or fiberglass poles (or mount on an existing pole). Available with one to four fixtures per pole, depending on the fixture/pole combination selected.

LED (Light Emitting Diode)	50 75 105 150 215 280 watts
Mounting heights	25', 30', 35'
Color	Gray, Black
Poles	Fiberglass Metal (special conditions) Wood

For additional information, visit us at duke-energy.com/OutdoorLighting or call us toll free at 866.769.6417.



Outdoor Lighting
Roadway LED

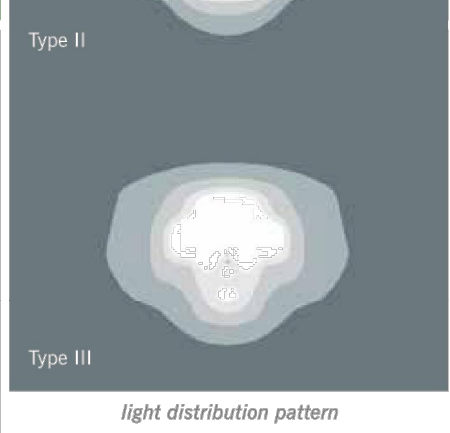

Light source: LED (white)
Lumens: 4,807 - 25,050 (fixture dependent)

Wattage	Light Pattern	IESNA Backlight-Uplight - Glare (BUG) Rating
LED 50	IESNA Type III (medium oval)	B1-UO-G1
LED 75	IESNA Type II (long oval)	B1-UO-G2
LED 105	IESNA Type II (long oval)	B2-UO-G3
LED 150	IESNA Type III (medium oval)	B2-UO-G2
LED 215	IESNA Type III (medium oval)	B3-UO-G3
LED 280	IESNA Type III (medium oval)	B3-UO-G4

Color temperature: 4,000K
Warm-up and restrike time: Instant on (no warm-up or restrike time)

Poles available:

Name	Mounting height	Color
Fiberglass	25', 30', 35'	Gray
Fiberglass	25', 30', 35'	Black (additional cost)
Wood	25', 30', 35'	Standard
Metal (special conditions)*	25', 30', 35'	Gray

Features

Features	Benefits
Little or no installation cost	Frees up capital for other projects
Design services by lighting professionals included	Meets industry standards and lighting ordinances
Maintenance included	Eliminates high and unexpected repair bills
Electricity included	Less expensive than metered service
Warranty included	Worry-free
One low monthly cost on your electric bill	Convenience and savings for you
Turnkey operation	Provides hassle-free installation and service
Backed by over 40 years of experience	A name you can trust today ... and tomorrow

*2" raised foundation available when required.

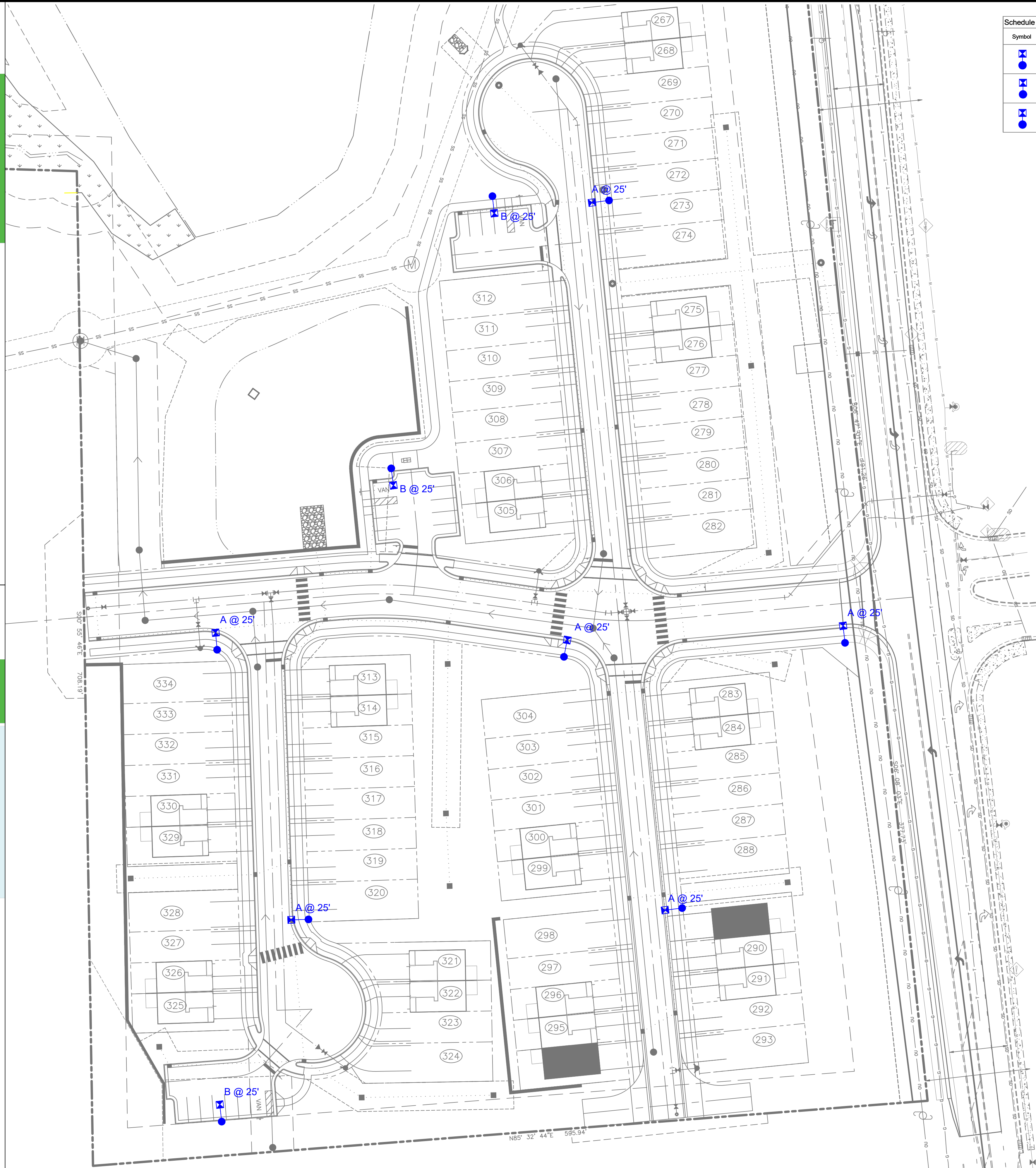

Symbol	Label	Quantity	Description	Number Lamps	Lumens Per Lamp	Light Loss Factor
⊠	A	115	LED 50w Roadway - Type III - 3000K - Public	1	5312	0.85
●	B	11	LED 50w Roadway - Type III - 3000K - Private	1	5312	0.85
⊠	C	2	LED 150w Roadway - Type IV - 3000K - Private	1	20049	0.85

ISOFOTCANDLE CURVES

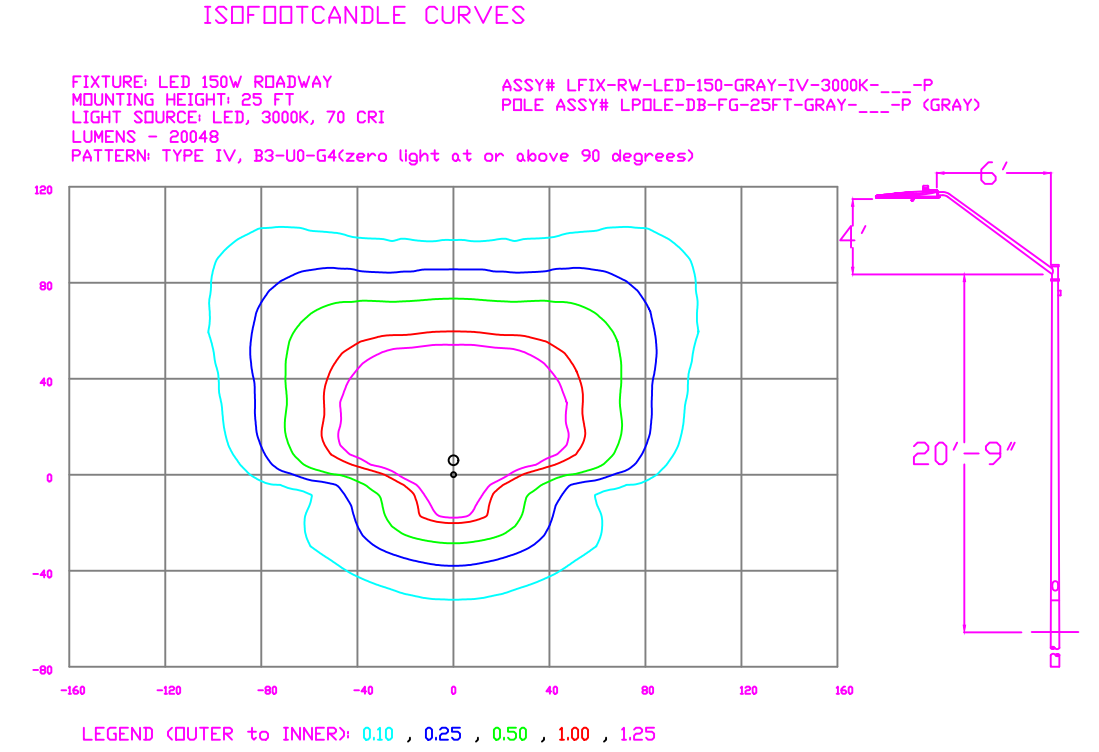
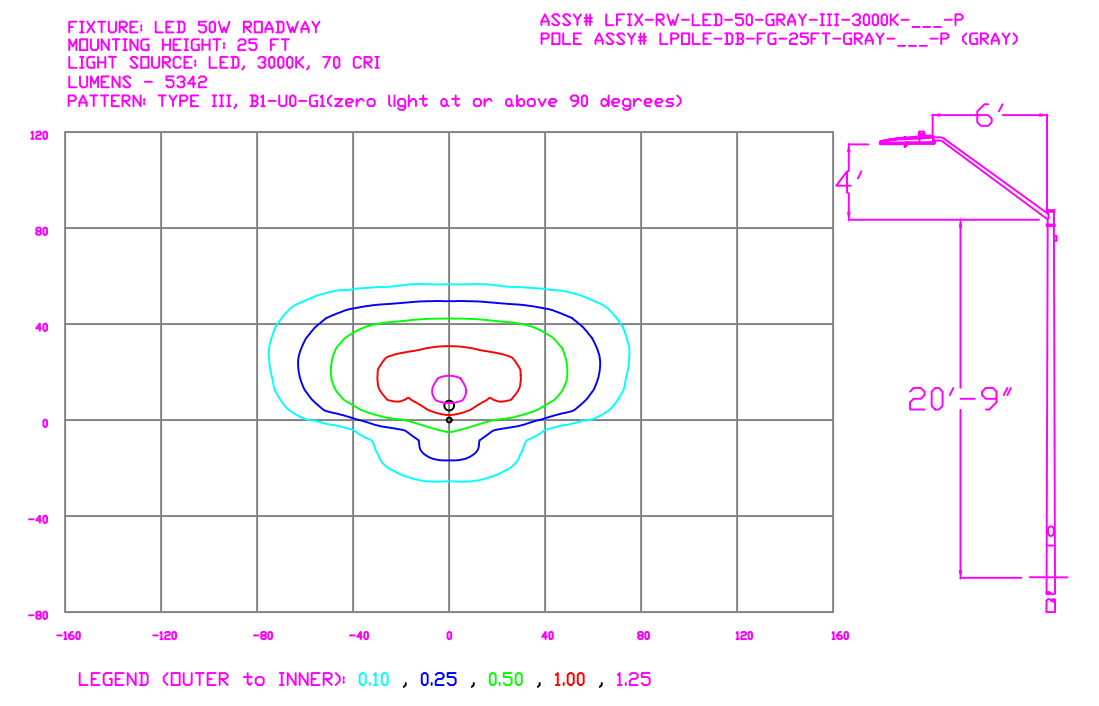

LIGHTING DESIGN TOLERANCE

The calculated footcandle light levels in this lighting design are predicted values and are based on specific information that has been supplied to Duke Energy. Any inaccuracies in the supplied information, differences in luminaire installation, lighted area geometry including elevation differences, reflective properties of surrounding surfaces, obstructions (foliage or otherwise) in the lighted area, or lighting from sources other than listed in this design may produce different results from the predicted values. Normal tolerances of voltage, lamp output, and ballast and luminaire manufacture will also affect results.



PROPRIETARY & CONFIDENTIAL

This document together with the concepts and designs presented herein, presented as an instrument of service, is the sole property of Duke Energy, and is intended only for the specific purpose and prospective client as stated in the title block of this drawing. Any use, copying, reproduction or disclosure of the drawing, design or any information contained herein by the prospective customer or other entities, including without limitation, architects, engineers, or equipment manufacturers is hereby expressly prohibited and shall not be permitted absent prior written consent from, and payment of compensation to Duke Energy. Duke Energy disclaims any liability or responsibility for any unauthorized use of or reliance on this document.

THE POINT

Rolesville, NC

SITE LIGHTING PLAN

Designed by	DEP LIGHTING SOLUTIONS
Reviewed by	N. Johnson Scale 1" = 40'
Date	02/08/2022 Size "Arch D"
Description	LED 50w & 150w Roadway
Drawing No.	22-0042A Sht. 3 OF 3

Customer approval _____
Date _____



REV#	DATE	REVISION	BY
Rev A	02/08/22	LED Roadway - Gray	NJ

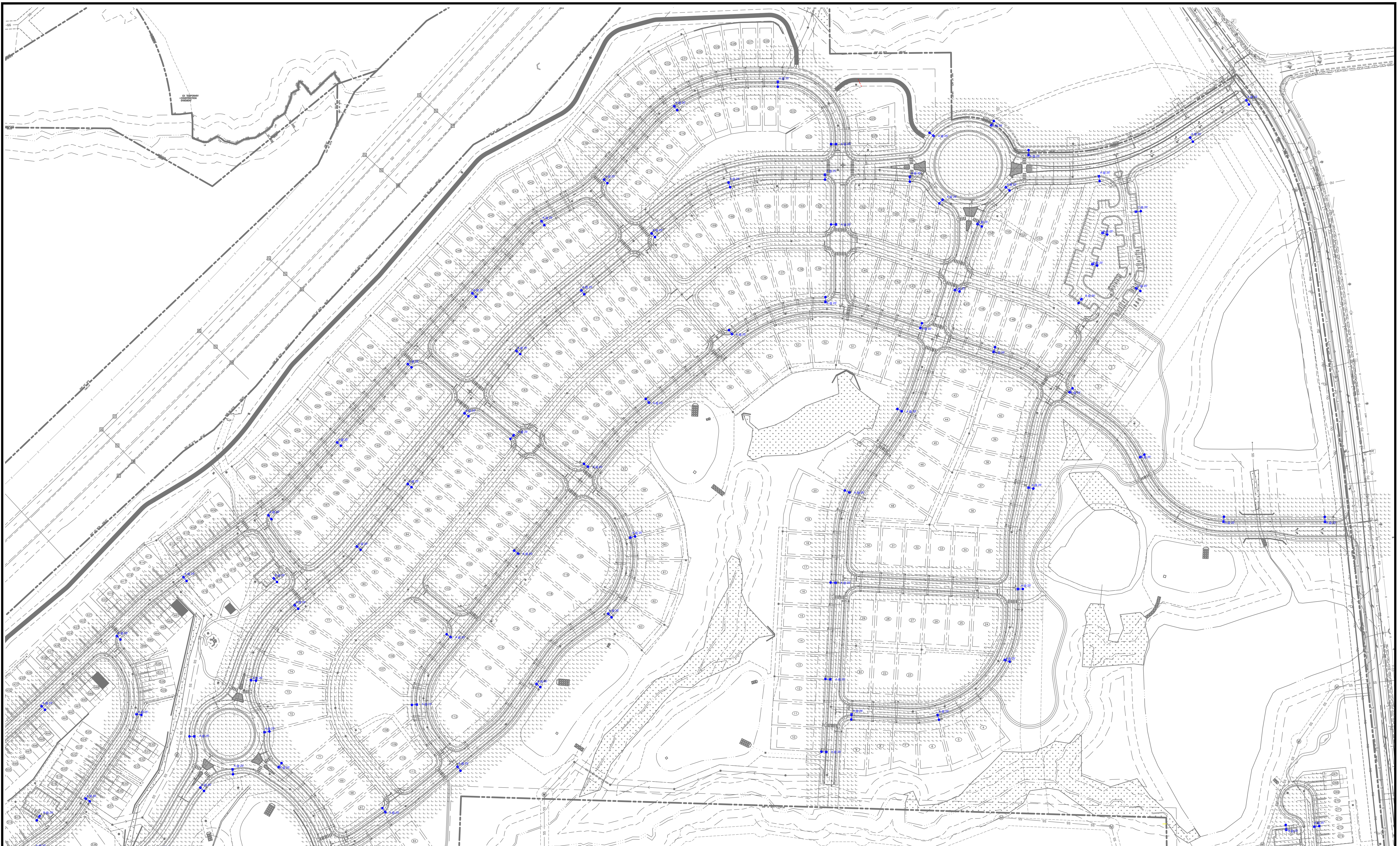

REV#	DATE	REVISION	BY
Rev A	02/08/22	LED Roadway - Gray	NJ

Customer approval _____
Date _____

DISTANCE CALIBRATION (INCHES)

LIGHTING DESIGN TOLERANCE

The calculated footcandle light levels in this lighting design are predicted values and are based on specific information that has been supplied to Duke Energy. Any inaccuracies in the supplied information, differences in luminaire installation, lighted area geometry including elevation differences, reflective properties of surrounding surfaces, obstructions (foliage or otherwise) in the lighted area, or lighting from sources other than listed in this design may produce different results from the predicted values. Normal tolerances of voltage, lamp output, and ballast and luminaire manufacture will also affect results.



PROPRIETARY & CONFIDENTIAL

This document together with the concepts and designs presented herein, presented as an instrument of service, is the sole property of Duke Energy, and is intended only for the specific purpose and prospective client as stated in the title block of this drawing. Any use, copying, reproduction or disclosure of the drawing, design or any information contained herein by the prospective customer or other entities, including without limitation, architects, engineers, or equipment manufacturers is hereby expressly prohibited and shall not be permitted absent prior written consent from, and payment of compensation to Duke Energy. Duke Energy disclaims any liability or responsibility for any unauthorized use of or reliance on this document.

THE POINT	
Rolesville, NC	
SITE LIGHTING PLAN	
Designed by	DEP LIGHTING SOLUTIONS
Reviewed by	N. Johnson Scale 1" = 100'
Date	02/08/2022 Size "Arch D"
Description	LED 50w & 150w Roadway
Drawing No.	22-0042A Sht. 1 OF 3



Rev A	02/08/22	LED Roadway - Gray	NJ
REV#	DATE	REVISION	BY

Customer approval _____
Date _____

DISTANCE CALIBRATION (INCHES)

LIGHTING DESIGN TOLERANCE
The calculated footcandle light levels in this lighting design are predicted values and are based on specific information that has been supplied to Duke Energy. Any inaccuracies in the supplied information, differences in luminaire installation, lighted area geometry including elevation differences, reflective properties of surrounding surfaces, obstructions (foliage or otherwise) in the lighted area, or lighting from sources other than listed in this design may produce different results from the predicted values. Normal tolerances of voltage, lamp output, and ballast and luminaire manufacture will also affect results.

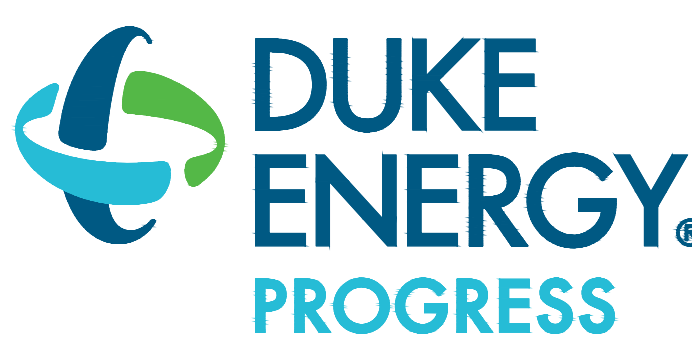

PROPRIETARY & CONFIDENTIAL
This document together with the concepts and designs presented herein, presented as an instrument of service, is the sole property of Duke Energy, and is intended only for the specific purpose and prospective client as stated in the title block of this drawing. Any use, copying, reproduction or disclosure of the drawing, design or any information contained herein by the prospective customer or other entities, including without limitation, architects, engineers, or equipment manufacturers is hereby expressly prohibited and shall not be permitted absent prior written consent from, and payment of compensation to Duke Energy. Duke Energy disclaims any liability or responsibility for any unauthorized use of or reliance on this document.

THE POINT	
Rolesville, NC	
SITE LIGHTING PLAN	
Designed by	DEP LIGHTING SOLUTIONS
Reviewed by	N. Johnson Scale 1" = 100'
Date	02/08/2022 Size "Arch D"
Description	LED 50w & 150w Roadway
Drawing No.	22-0042A Sht. 2 OF 3



Outdoor Lighting
Roadway LED



The Roadway LED is a green solution and great fit for streets, roads, long, narrow areas and parking lots. This energy-efficient luminaire delivers the light where it is needed while increasing visibility and reducing spill light to adjoining properties. Choose low to medium light output on wood or fiberglass poles (or mount on an existing pole). Available with one to four fixtures per pole, depending on the fixture/pole combination selected.

LED (Light Emitting Diode)	50 75 105 150 215 280 watts
Mounting heights	25', 30', 35'
Color	Gray, Black
Poles	Fiberglass Metal (special conditions) Wood

For additional information, visit us at duke-energy.com/OutdoorLighting or call us toll free at 866.769.6417.



Outdoor Lighting
Roadway LED

Light source: LED (white)		IESNA Backlight-Uplight - Glare (BUG) Rating
Lumens: 4,807 - 25,050 (fixture dependent)		
Wattage	Light Pattern	
LED 50	IESNA Type III (medium oval)	B1-UO-G1
LED 75	IESNA Type II (long oval)	B1-UO-G2
LED 105	IESNA Type II (long oval)	B2-UO-G3
LED 150	IESNA Type III (medium oval)	B2-UO-G2
LED 215	IESNA Type III (medium oval)	B3-UO-G3
LED 280	IESNA Type III (medium oval)	B3-UO-G4

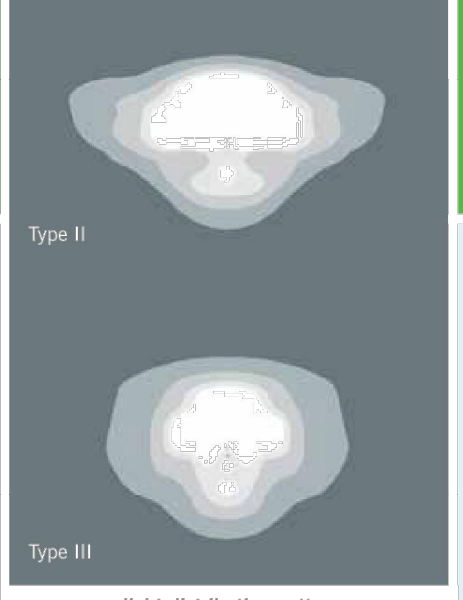

Color temperature: 4,000K
Warm-up and restrike time: Instant on (no warm-up or restrike time)

Name	Mounting height	Color
Fiberglass	25', 30', 35'	Gray
Fiberglass	25', 30', 35'	Black (additional cost)
Wood	25', 30', 35'	Standard
Metal (special conditions)*	25', 30', 35'	Gray

Features	Benefits
Little or no installation cost	Frees up capital for other projects
Design services by lighting professionals included	Meets industry standards and lighting ordinances
Maintenance included	Eliminates high and unexpected repair bills
Electricity included	Less expensive than metered service
Warranty included	Worry-free
One low monthly cost on your electric bill	Convenience and savings for you
Turnkey operation	Provides hassle-free installation and service
Backed by over 40 years of experience	A name you can trust today ... and tomorrow

*2" raised foundation available when required.



Symbol	Label	Quantity	Description	Number Lamps	Lumens Per Lamp	Light Loss Factor
⊕	A	115	LED 50w Roadway - Type III - 3000K - Public	1	5312	0.85
⊕	B	11	LED 50w Roadway - Type III - 3000K - Private	1	5312	0.85
⊕	C	2	LED 150w Roadway - Type IV - 3000K - Private	1	20049	0.85

ISOFOTPCANDLE CURVES

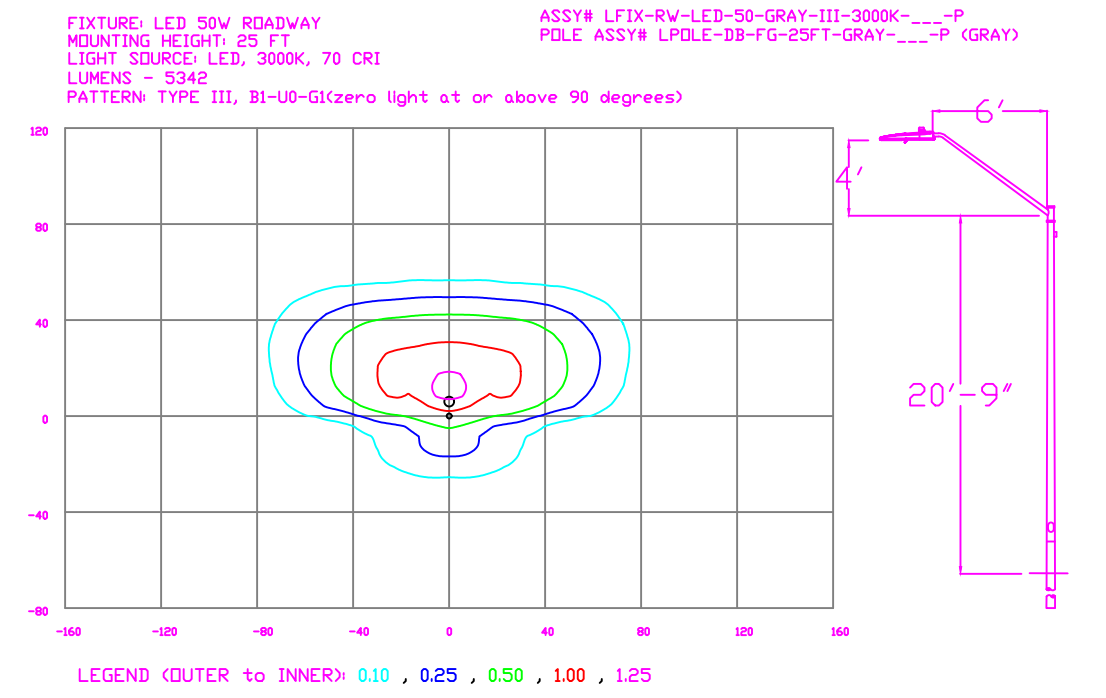

ISOFOTPCANDLE CURVES

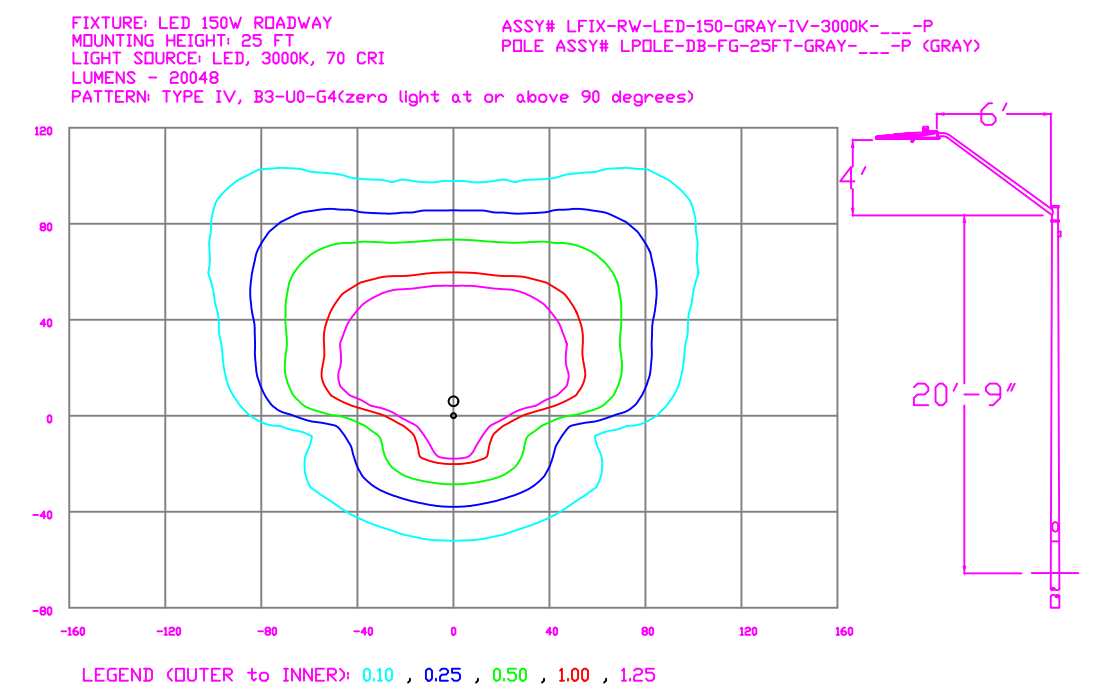

REV#	DATE	REVISION	BY
Rev A	02/08/22	LED Roadway - Gray	NJ

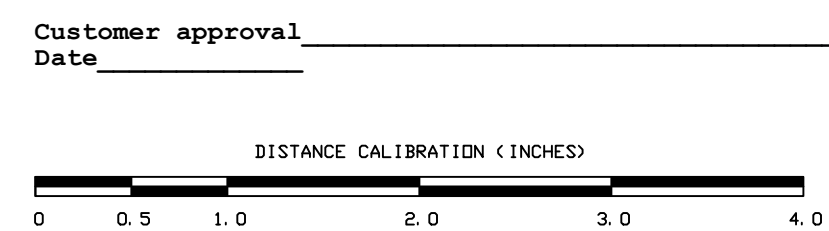

LIGHTING DESIGN TOLERANCE
The calculated footcandle light levels in this lighting design are predicted values and are based on specific information that has been supplied to Duke Energy. Any inaccuracies in the supplied information, differences in luminaire installation, lighted area geometry including elevation differences, reflective properties of surrounding surfaces, obstructions (foliage or otherwise) in the lighted area, or lighting from sources other than listed in this design may produce different results from the predicted values. Normal tolerances of voltage, lamp output, and ballast and luminaire manufacture will also affect results.



PROPRIETARY & CONFIDENTIAL
This document together with the concepts and designs presented herein, presented as an instrument of service, is the sole property of Duke Energy, and is intended only for the specific purpose and prospective client as stated in the title block of this drawing. Any use, copying, reproduction or disclosure of the drawing, design or any information contained herein by the prospective customer or other entities, including without limitation, architects, engineers, or equipment manufacturers is hereby expressly prohibited and shall not be permitted absent prior written consent from, and payment of compensation to Duke Energy. Duke Energy disclaims any liability or responsibility for any unauthorized use of or reliance on this document.

THE POINT	
Rolesville, NC	
SITE LIGHTING PLAN	
Designed by	DEP LIGHTING SOLUTIONS
Reviewed by	N. Johnson Scale 1" = 40'
Date	02/08/2022 Size "Arch D"
Description	LED 50w & 150w Roadway
Drawing No.	22-0042A Sht. 3 OF 3

Outdoor Lighting

Roadway LED



The Roadway LED is a green solution and great fit for streets, roads, long, narrow areas and parking lots. This energy-efficient luminaire delivers the light where it is needed while increasing visibility and reducing spill light to adjoining properties. Choose low to medium light output on wood or fiberglass poles (or mount on an existing pole). Available with one to four fixtures per pole, depending on the fixture/pole combination selected.

LED 50 | 75 | 105 | **150** | 215 | 280 watts
(Light Emitting Diode)

Mounting heights 25', 30', 35'

Color Gray, Black

Poles **Fiberglass**
Metal (*special conditions*)
Wood

Outdoor Lighting

Roadway LED

Light source: LED (*white*)

Lumens: 4,807 – 25,050 (*fixture dependent*)

Wattage	Light Pattern	IESNA Backlight-Uplight – Glare (BUG) Rating
LED 50	IESNA Type III (<i>medium oval</i>)	B1-U0-G1
LED 75	IESNA Type II (<i>long oval</i>)	B1-U0-G2
LED 105	IESNA Type II (<i>long oval</i>)	B2-U0-G3
LED 150	IESNA Type III (<i>medium oval</i>)	B2-U0-G2
LED 215	IESNA Type III (<i>medium oval</i>)	B3-U0-G3
LED 280	IESNA Type III (<i>medium oval</i>)	B3-U0-G4



Color temperature: 4,000K

Warm-up and restrike time: Instant on (*no warm-up or restrike time*)

Poles available:

Name	Mounting height	Color
Fiberglass	25', 30', 35'	Gray
Fiberglass	25', 30', 35'	Black (<i>additional cost</i>)
Wood	25', 30', 35'	Standard
Metal (<i>special conditions</i>)*	25', 30', 35'	Gray

Features

Little or no installation cost

Design services by lighting professionals included

Maintenance included

Electricity included

Warranty included

One low monthly cost on your electric bill

Turnkey operation

Backed by over 40 years of experience

Benefits

Frees up capital for other projects

Meets industry standards and lighting ordinances

Eliminates high and unexpected repair bills

Less expensive than metered service

Worry-free

Convenience and savings for you

Provides hassle-free installation and service

A name you can trust today ... and tomorrow

*2' raised foundation available when required.